

H A U K E L I D

42/70 . Tgn. 2943 - 4

NO. H3. ^{IV}H4 ^{III}

Östre Akervei 33

Standard Telefon og Kabel

2.10.1970

NO, H-3 ^{IV}, H-4 ^{III}
ON

← overført # 24



Tilhører Undergrundskartverket
M A I k e f j e r n e s

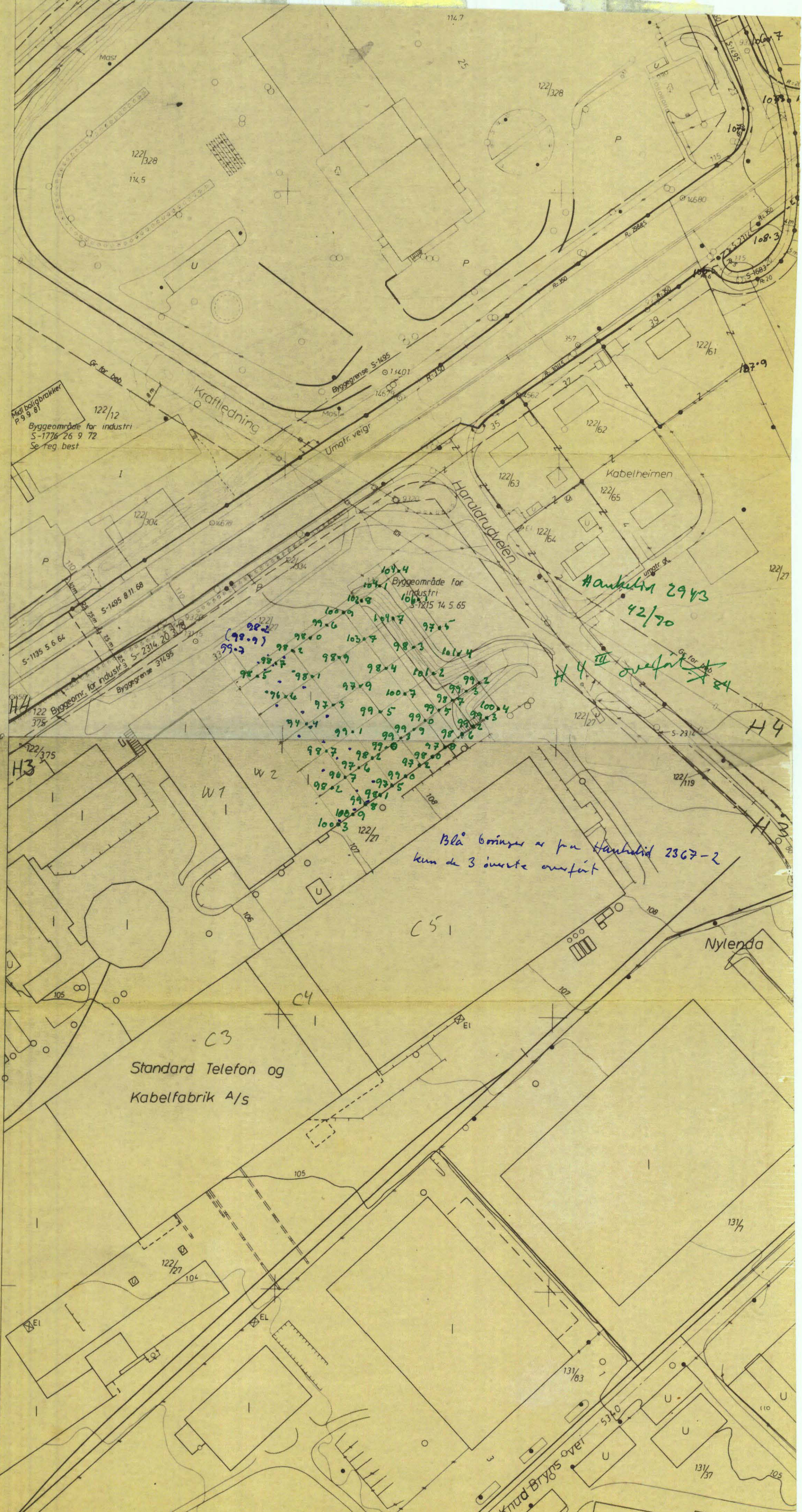

Mell boligbrønner
P. 9. 9. 81
Byggeområde for industri
S-1776 26. 9. 72
Se teg best

122 Byggeomr. for industri
375

Byggeområde for industri
S-1215 14. 5. 65

Hankelid 2943
42/70

H 4 III overført 84

Bla beringer er fra Hankelid 2367-2
kun de 3 øverste overført

Standard Telefon og
Kabelfabrik A/s

Knud Bryggs over

G4
G3

H4
H3

H4

C5

C3

C4

Nylenda

131/83

131/

131/37

105

122/328
114.5

122/12

122/304

122/375

105

122/104

122/328

122/161

122/63

122/62

122/65

122/64

122/27

122/119

114.7

25

114.01

357

37

35

39

127.9

98.9

99.2

98.5

97.6

97.2

98.7

98.2

98.2

98.2

98.2

98.2

98.2

98.2

98.2

98.2

98.2

98.2

98.2

98.2

98.2

98.2

98.2

98.2

98.2

98.2

98.2

98.2

98.2

98.2

98.0

98.2

98.1

97.3

97.3

97.3

97.3

97.3

97.3

97.3

97.3

97.3

97.3

97.3

97.3

97.3

97.3

97.3

97.3

97.3

97.3

97.3

97.3

97.3

97.3

97.3

97.3

97.3

97.3

98.9

98.2

98.5

97.6

97.2

98.7

98.2

98.2

98.2

98.2

98.2

98.2

98.2

98.2

98.2

98.2

98.2

98.2

98.2

98.2

98.2

98.2

98.2

98.2

98.2

98.2

98.2

98.2

98.2

98.0

98.2

98.1

97.3

97.3

97.3

97.3

97.3

97.3

97.3

97.3

97.3

97.3

97.3

97.3

97.3

97.3

97.3

97.3

97.3

97.3

97.3

97.3

97.3

97.3

97.3

97.3

97.3

97.3

98.9

98.2

98.5

97.6

97.2

98.7

98.2

98.2

98.2

98.2

98.2

98.2

98.2

98.2

98.2

98.2

98.2

98.2

98.2

98.2

98.2

98.2

98.2

98.2

98.2

98.2

98.2

98.2

98.2

98.0

98.2

98.1

97.3

97.3

97.3

97.3

97.3

97.3

97.3

97.3

97.3

97.3

97.3

97.3

97.3

97.3

97.3

97.3

97.3

97.3

97.3

97.3

97.3

97.3

97.3

97.3

97.3

97.3

98.9

98.2

98.5

97.6

97.2

98.7

98.2

98.2

98.2

98.2

98.2

98.2

98.2

98.2

98.2

98.2

98.2

98.2

98.2

98.2

98.2

98.2

98.2

98.2

98.2

98.2

98.2

98.2

98.2

98.0

98.2

98.1

97.3

97.3

97.3

97.3

97.3

97.3

97.3

97.3

97.3

97.3

97.3

97.3

97.3

97.3

97.3

97.3

97.3

97.3

97.3

97.3

97.3

97.3

97.3

97.3

97.3

97.3

98.9

98.2

98.5

97.6

97.2

98.7

98.2

98.2

98.2

98.2

98.2

98.2

98.2

98.2

98.2

98.2

98.2

98.2

98.2

98.2

98.2

98.2

98.2

98.2

98.2

98.2

98.2

98.2

98.2

98.0

98.2

98.1

97.3

97.3

97.3

97.3

97.3

97.3

97.3

97.3

97.3

97.3

97.3

97.3

97.3

97.3

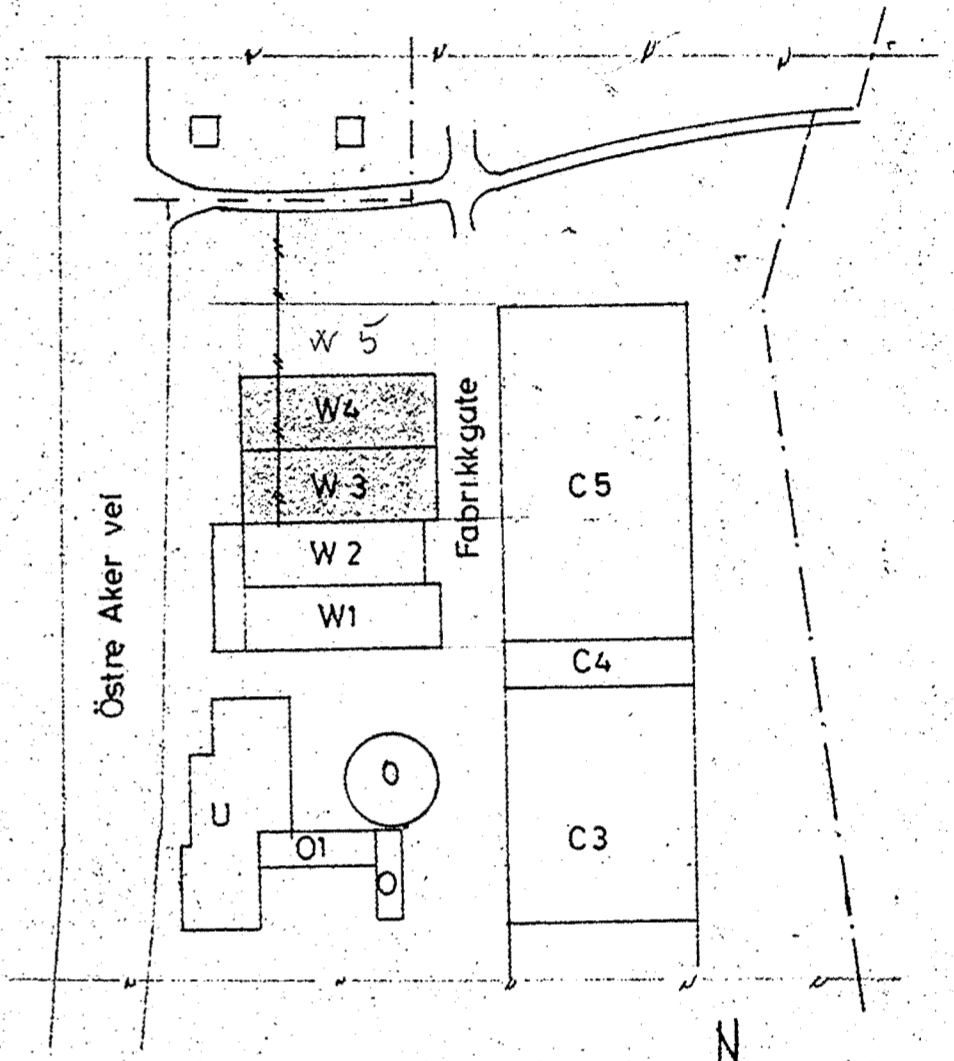
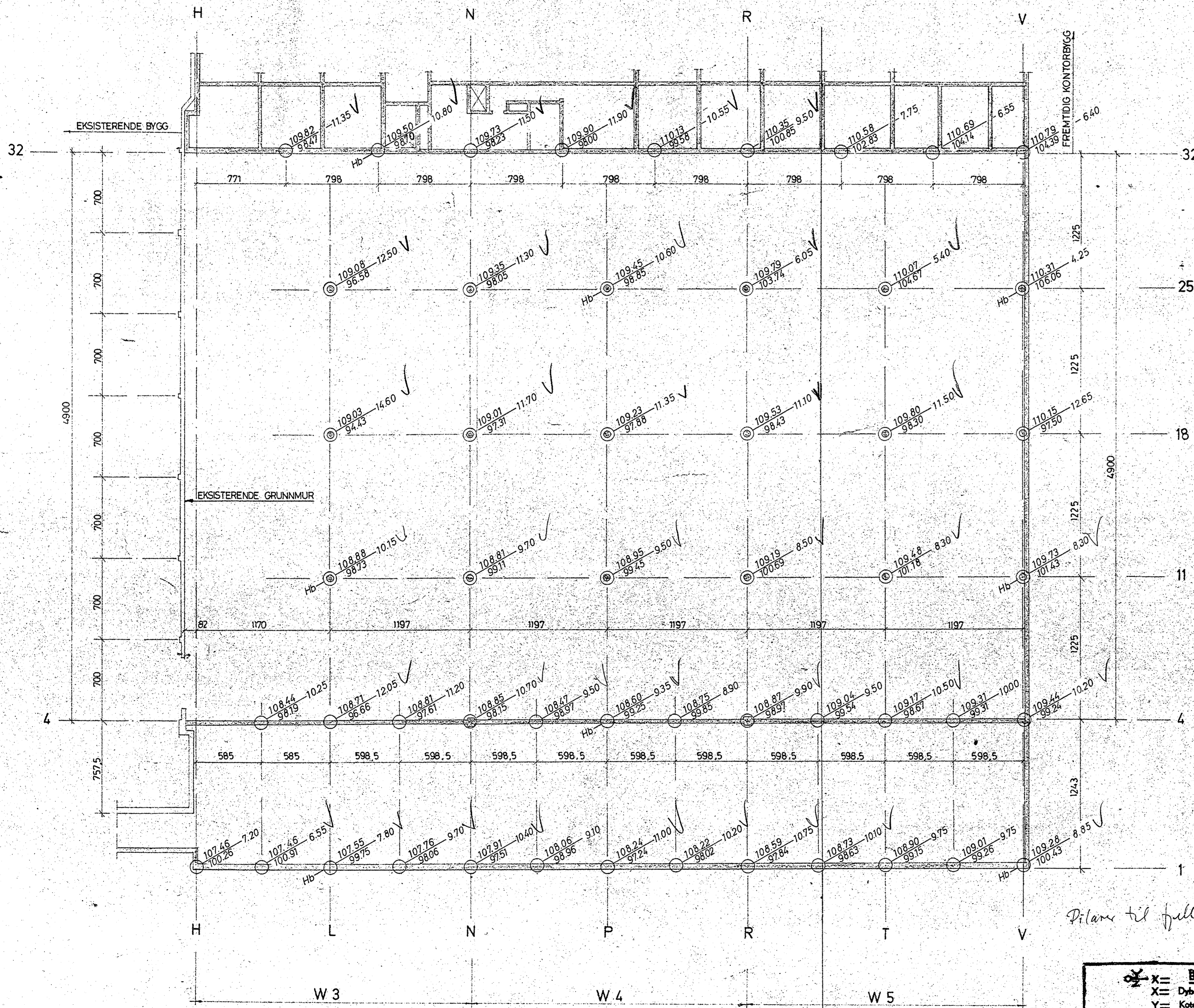

SITUASJONSPLAN
M = ca 1:2500

42/70
1270
Tegn. 2943-4
Standard Telefon og Kabel

⊗ I ALLE 52 PUNKTER MERKET MED RING BORES OG MÅLES DYBDE TIL FJELL.

← Etter oppmålingsvesenets kart (1979 (91) ser det ut til at bore dette er Gyssat →

- ⊗ = Borhull
- X = Dybde til antatt fjell
- Y = Kote terrang eller sjøbunn
- Z = " " antatt fjell
- [X] = Boring dybde, ikke fjell
- ⊙ = Prøvehull, 54 m.m. diam.
- ⊖ = " " " " " " " "
- ⊕ = Vingsboret

BORPLAN		ERSTATNING FOR: TEGN NR. 2943-4	
Bjørulf Haukelid		ARB. NR.: 42/70	

B	2.10.70	z	SITUASJONSPLAN TILFØYET
A	11.9.70	z	GRUNNBORINGSPLAN FOR W5 TILFØYET

UTFKLASSE	SP.KLASSE	STÅL KVAL.	BETONG	NYTTELAST	SIGN.	DATO	MÅL	RÅDGIVENDE INGENIØR I BYGGETEKNIKK.	SAK NR.	TEGN.NR.	REV.
					z z	3.9.70	1:200 C/M	OTTO HEGERMANN MNIF. MRIF.	607	02	B
								SOMMERGATEN 17 OSLO 2 TLF. 550285			