

Haukelid

Grejsenvn 6	79	150
→ 8	→	208
→ 12	→	221

NO: D6 II 

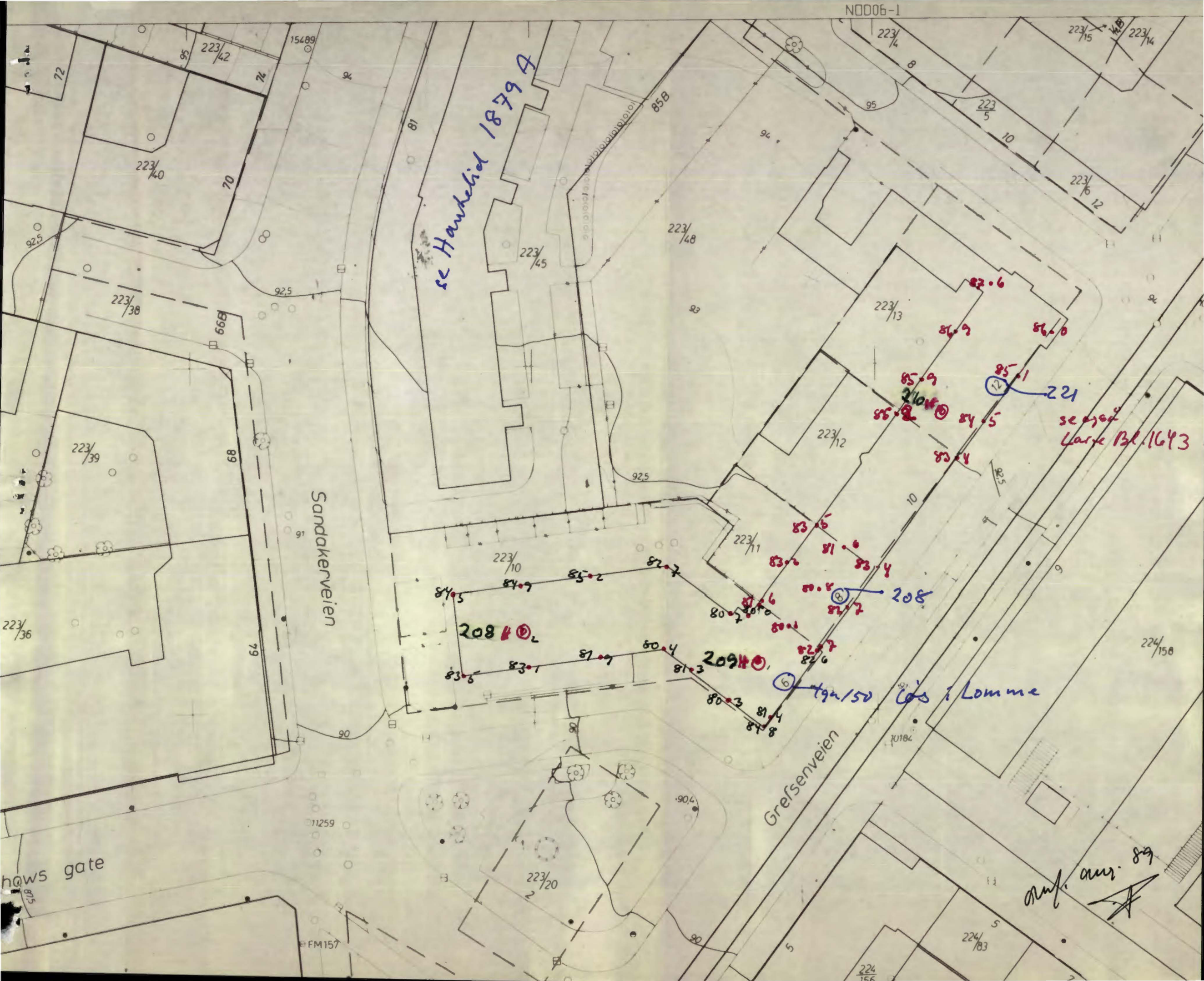

se Handbid 1879 A

se også
Lare Bl. 1643

Sandakerveien

Grefsenveien

10's i Lomme

anf. ans. 89

208

209

208

221

how's gate

FM157

224
156

224
183

224
158

223
14

223
15

223
5

223
4

223
12

223
5

223
13

223
12

223
11

223
10

223
39

223
38

223
40

223
42

15489

72

70

68

669

69

90

91

92.5

92.5

223
48

223
45

85B

81

94

95

10

223
16

11

94

92

92.5

92.5

9

10

9

91

70184

90.4

223
20

2

90

5

11

5

2

2

2

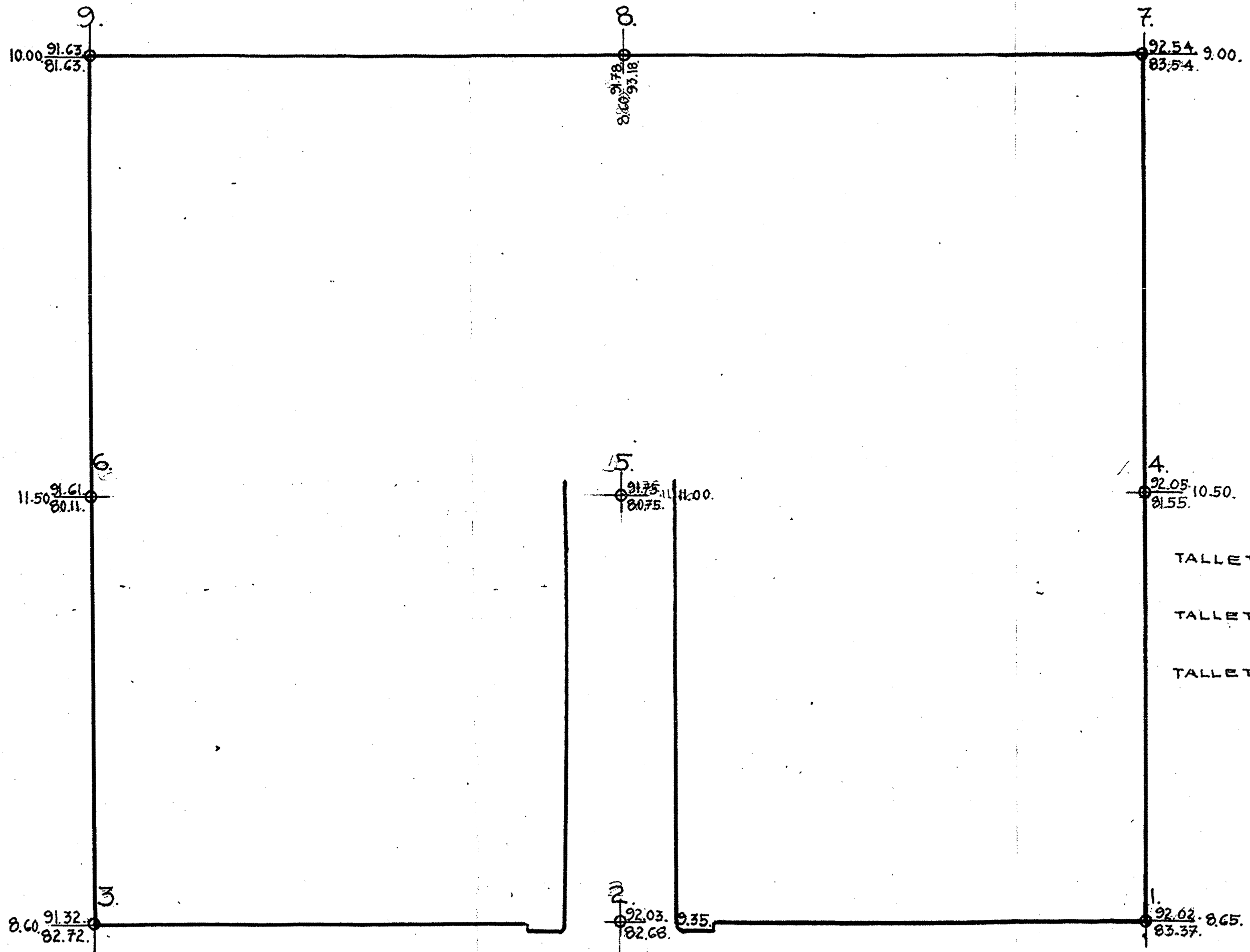

TALLET OVER STREKEN ER KOTE
 GRUNN.
 TALLET UNDER STREKEN ER
 KOTE FJELL
 TALLET VED SIDEN AV STREKEN
 ER DYBDE TIL FJELL

GREFSENVEIEN.

NO: DG IV
 GRUNNNUNDERSØKELSE
 PAA TOMT
 GREFSENVEIEN 8.
 M. 1:50. *P. H. H. H.* NOV-1936.
 M. N. F.

Nr. 208.

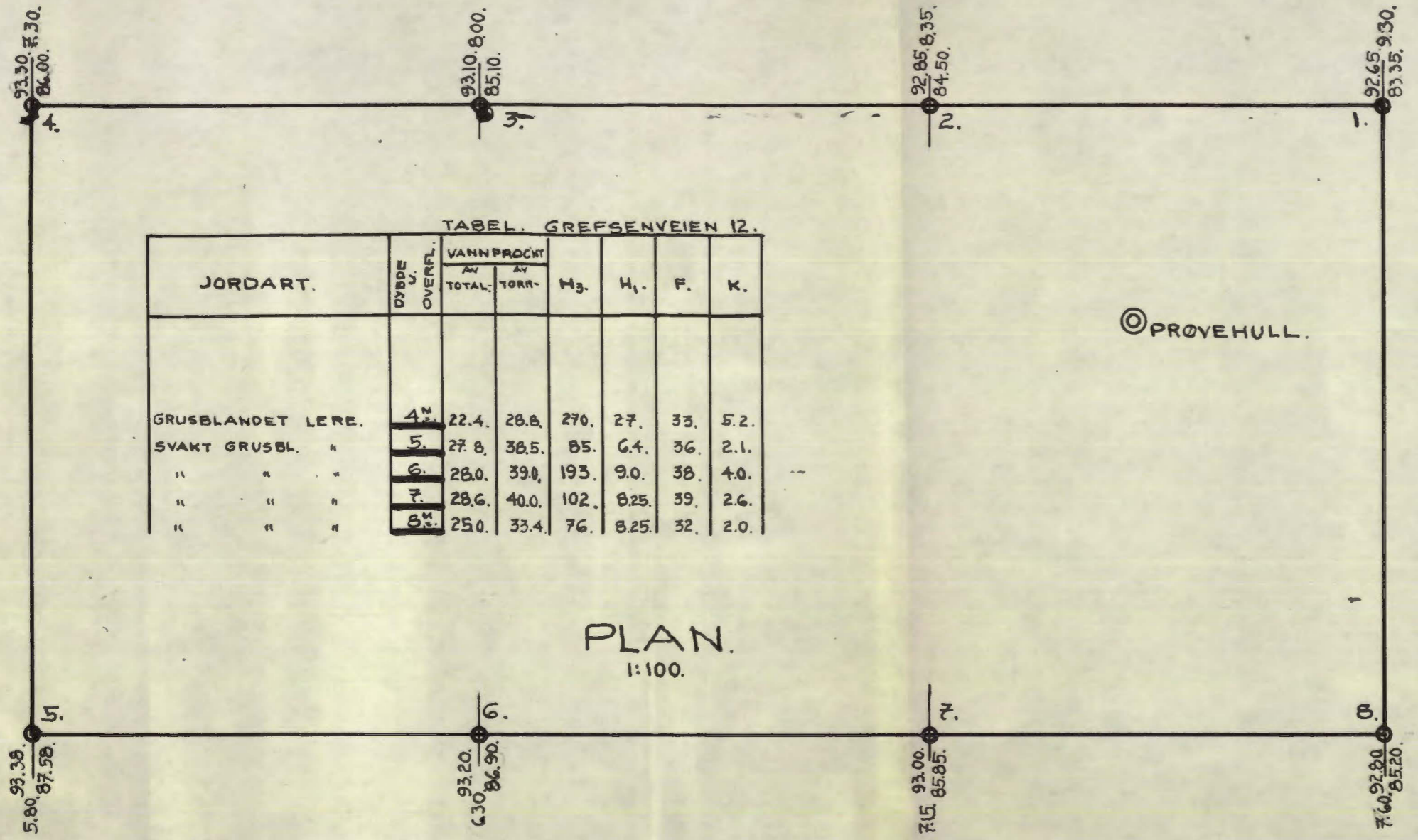

TABEL. GREFSENVEIEN 12.

JORDART.	DYBDE U. OVERFL.	VANNPROSENT		H ₃ .	H ₁ .	F.	K.
		AV TOTAL.	AV TORR.				
GRUSBLANDET LERE.	4 ^m	22.4	28.8	270.	27.	33.	5.2.
SVAKT GRUSBL. "	5.	27.8	38.5	85.	6.4	36.	2.1.
" " "	6.	28.0	39.0	193.	9.0	38.	4.0.
" " "	7.	28.6	40.0	102.	8.25	39.	2.6.
" " "	8 ^m	25.0	33.4	76.	8.25	32.	2.0.

PLAN.
1:100.

FORKLARING.
 TALLET OVER STREKEN ER KOTE GRUNN.
 D^o UNDER " " " FJELL.
 D^o VED SIDEN AV STREKEN ER DYBDE TIL FJELL I METER.
 I TABELLEN ER H₃ RELATIV FASTHET NATURLIG LERE.
 " " H₁ D^o " OMRØRT "
 " " F. FINHETSTALL.
 " " K. KOHESJON I TON PR. M².

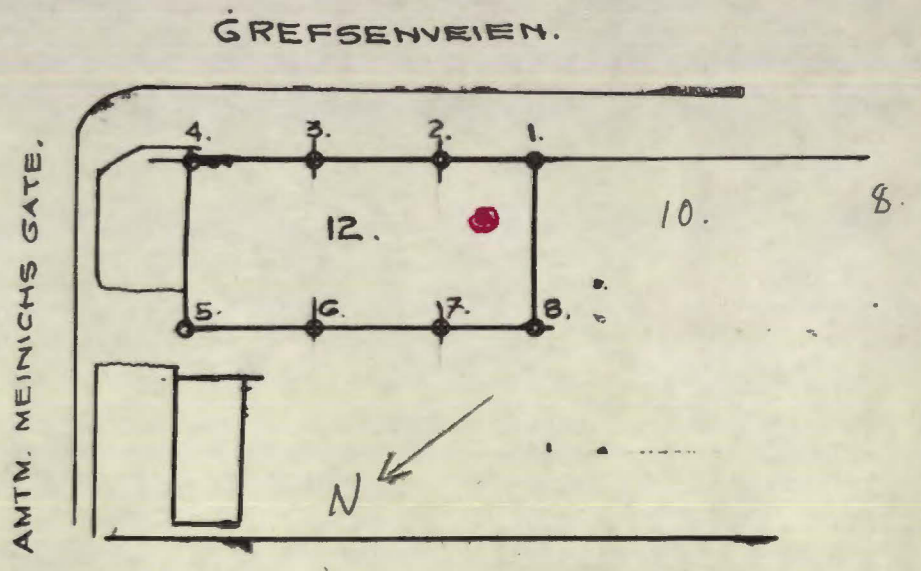

SITUATION.
1:500.

se også Larsen Bl. 1643 (1935)

NO: DG II
 GRUNNUNDERSØKELSE.
 GREFSENVEIEN 12.
 M. 1:500, 1:100. FEBR. 1937.

No 221 *Bj. Høivik*
 M.N.I.P.

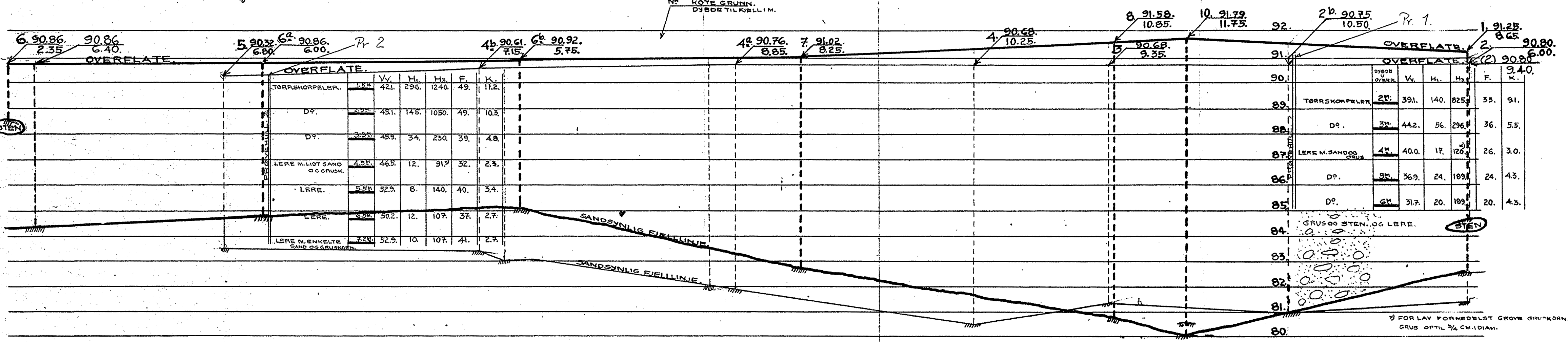
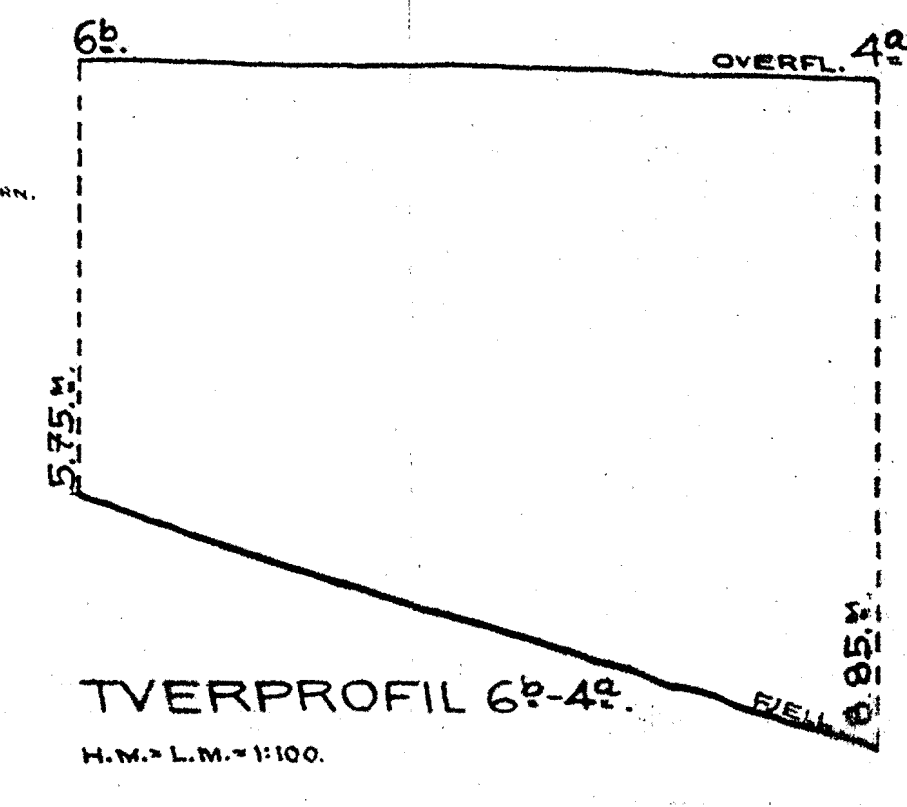
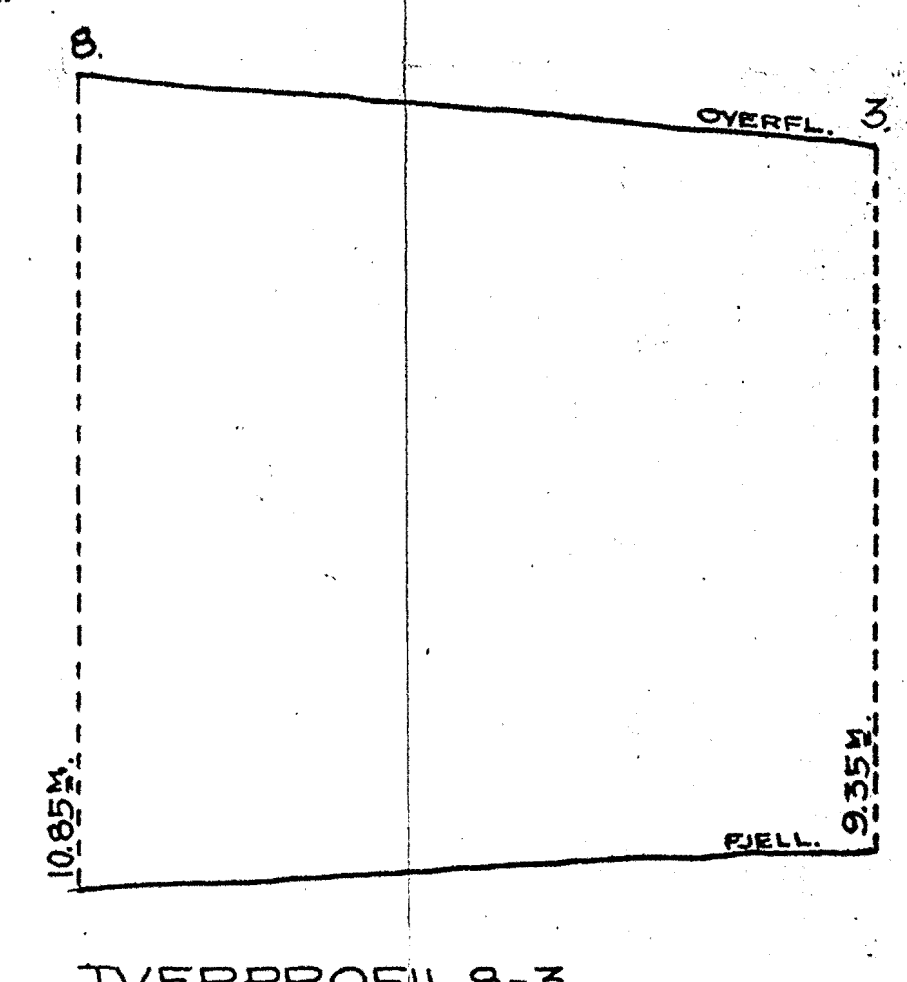
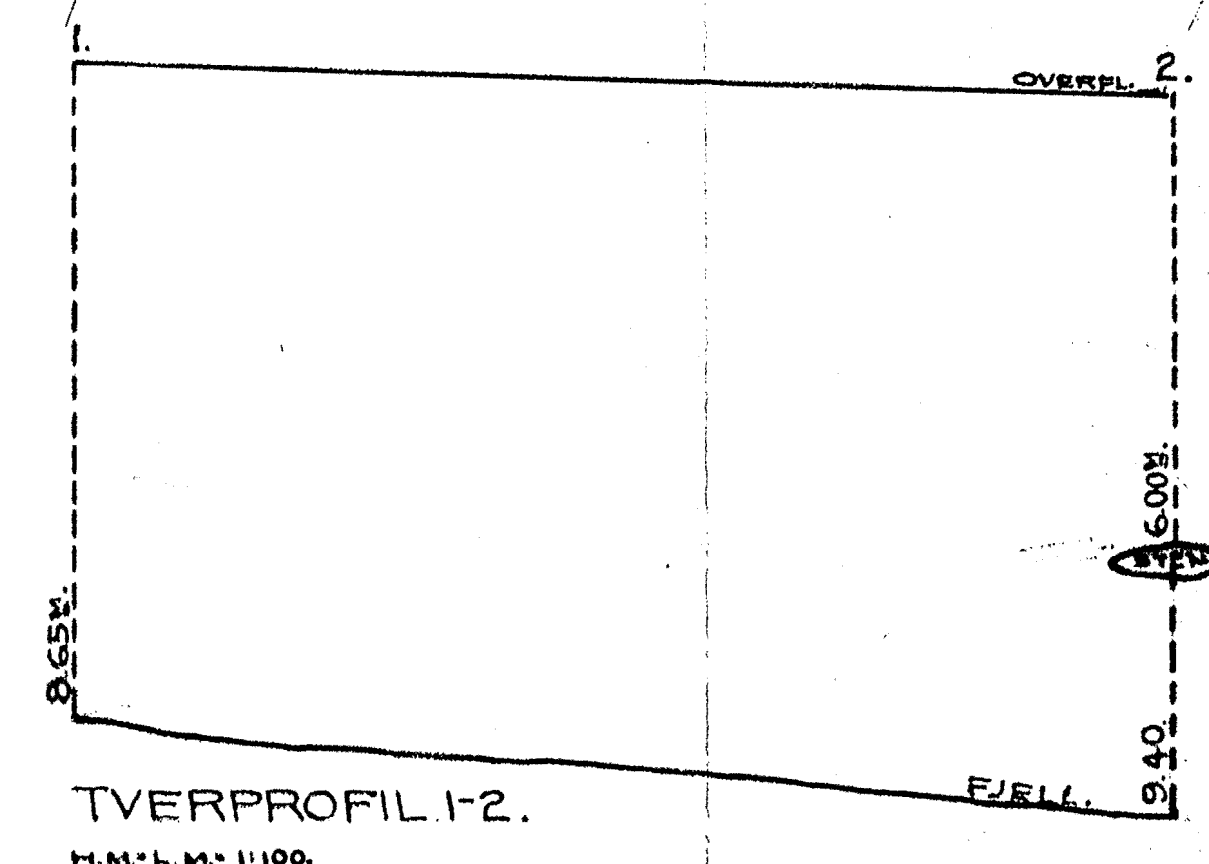
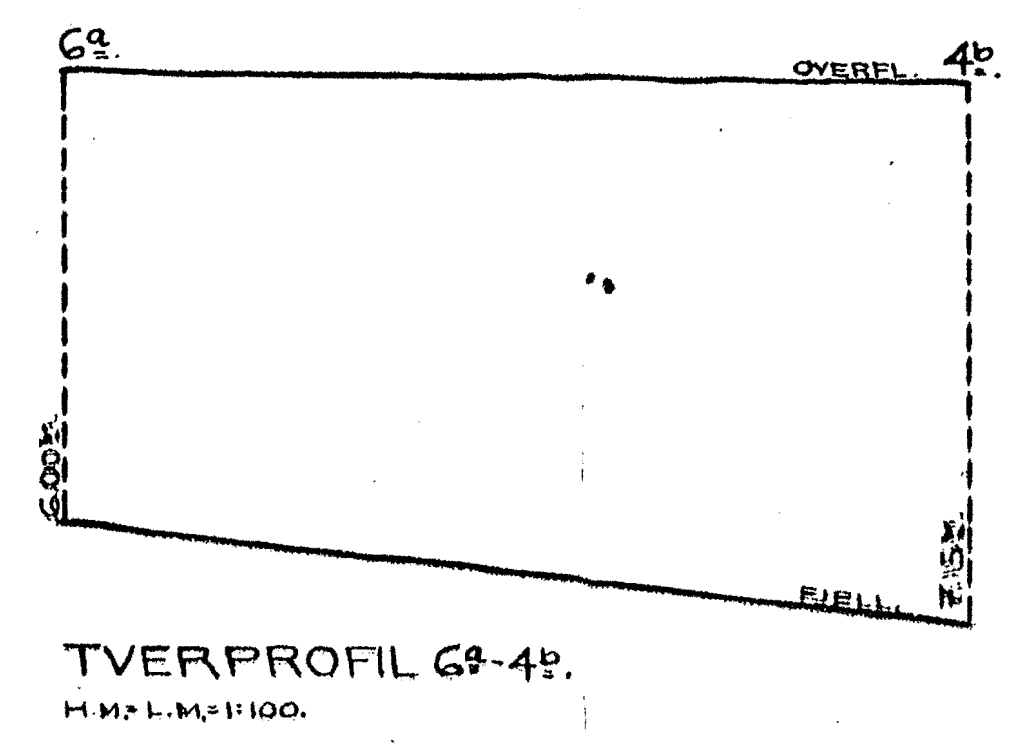
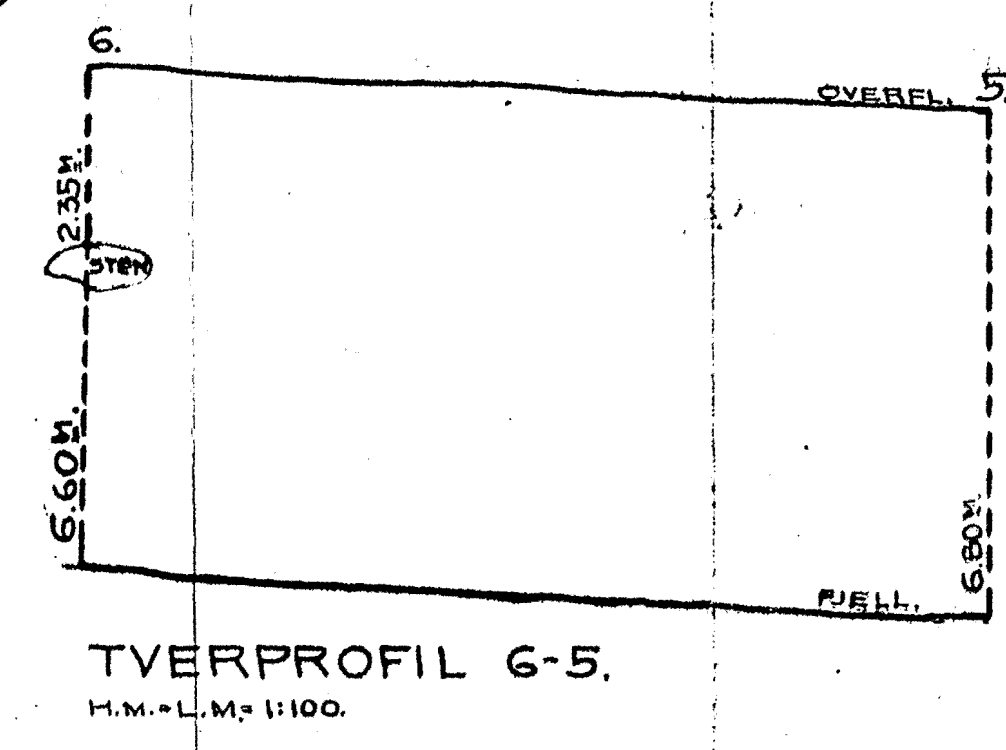
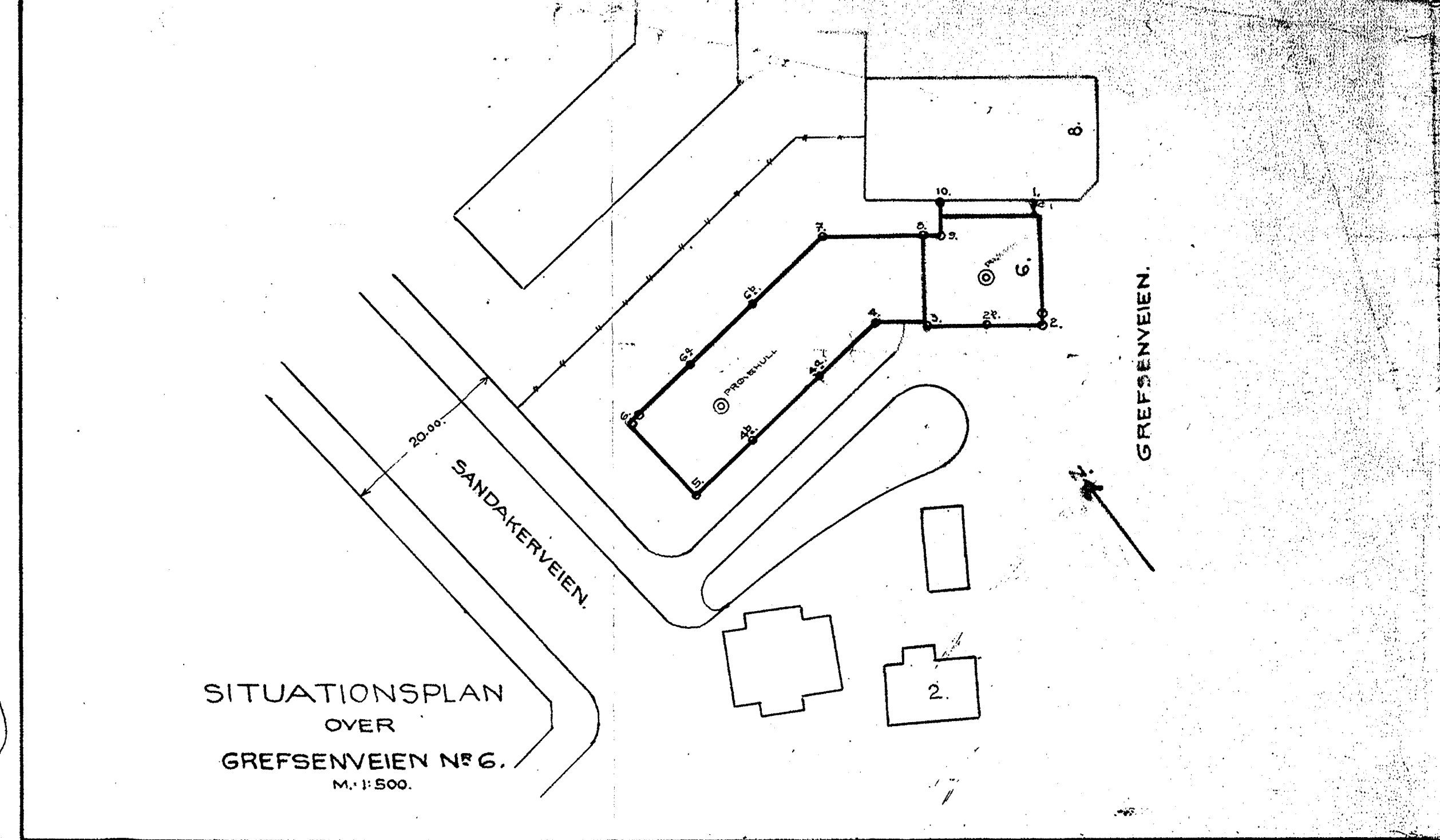
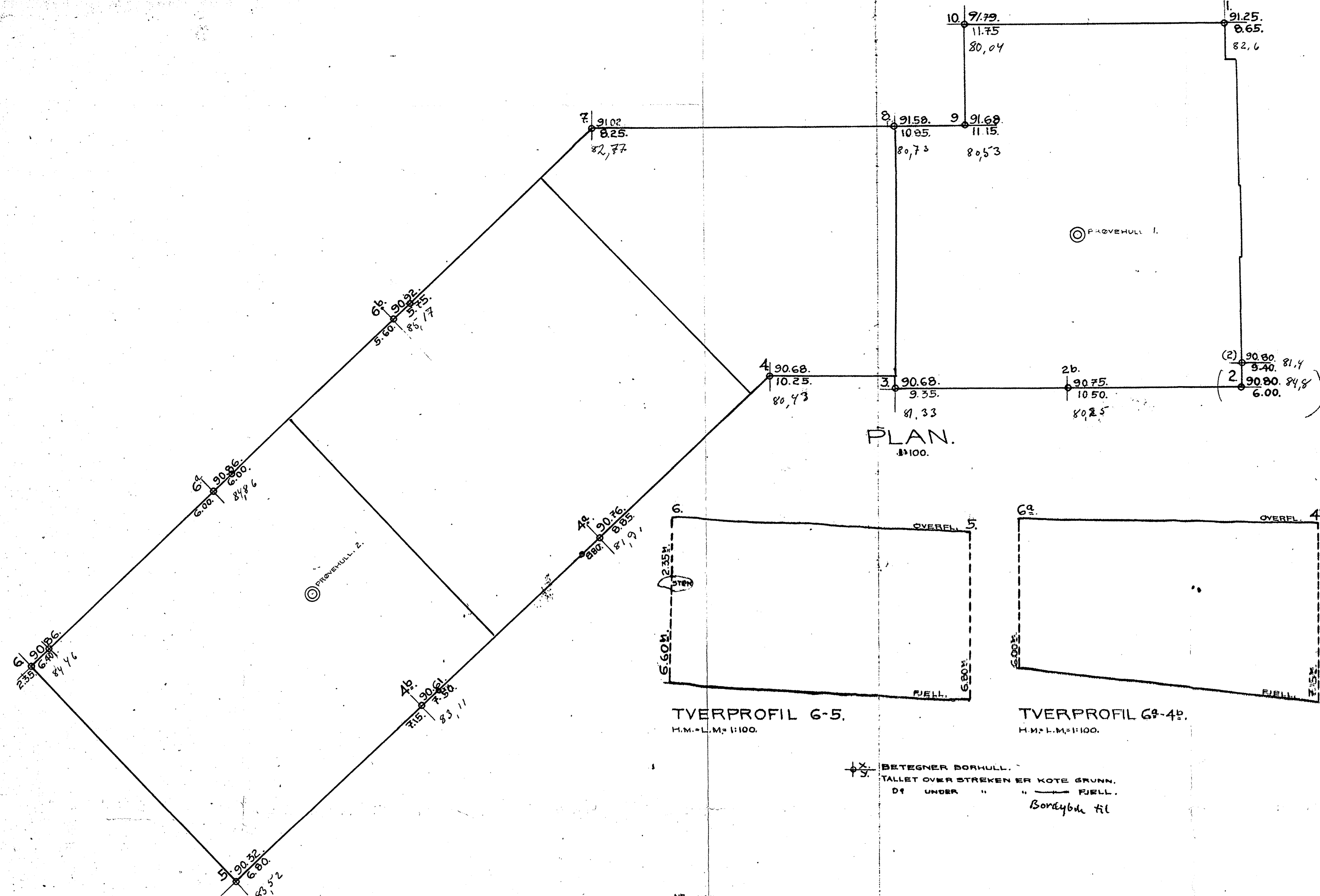

ANTAGELSE FOR LAV GRUNDET EN BØTHANAL
M. FAST LERE OMRING.

LÆNGDEPROFIL.
H.M. L.M. 1:100.

FORKLARING.
V. = VANNPROSENT AV VOLUMINOROLD.
H. = HOLOFASTHET AV OMRØRT LERE.
M. = DP = NATURLIG LERE.
F. = FINNETSTALL.
K. = KONSESSION I TON PR. M³.

GRUNNBORINGER
PÅA TOMT
GREFSENVEIEN N° 6
M. 1:100

Nr. 150
(1936)