

*SO: B1^I

1127

Akersgt. 18

Grunnboringskart over Akersgaten nr. 18.

Bl. 1127 ✓

M. = 1:200

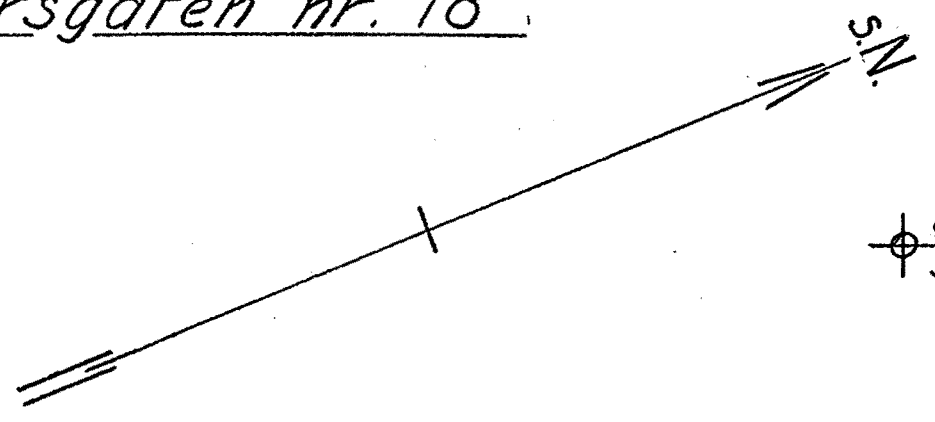

⊕ 8.0 = boret dybde til fjell i m.
⊕ 5.4 = fjellets kote efter byens gamle ± 0

← Akersgaten →

← Prinsens gate →

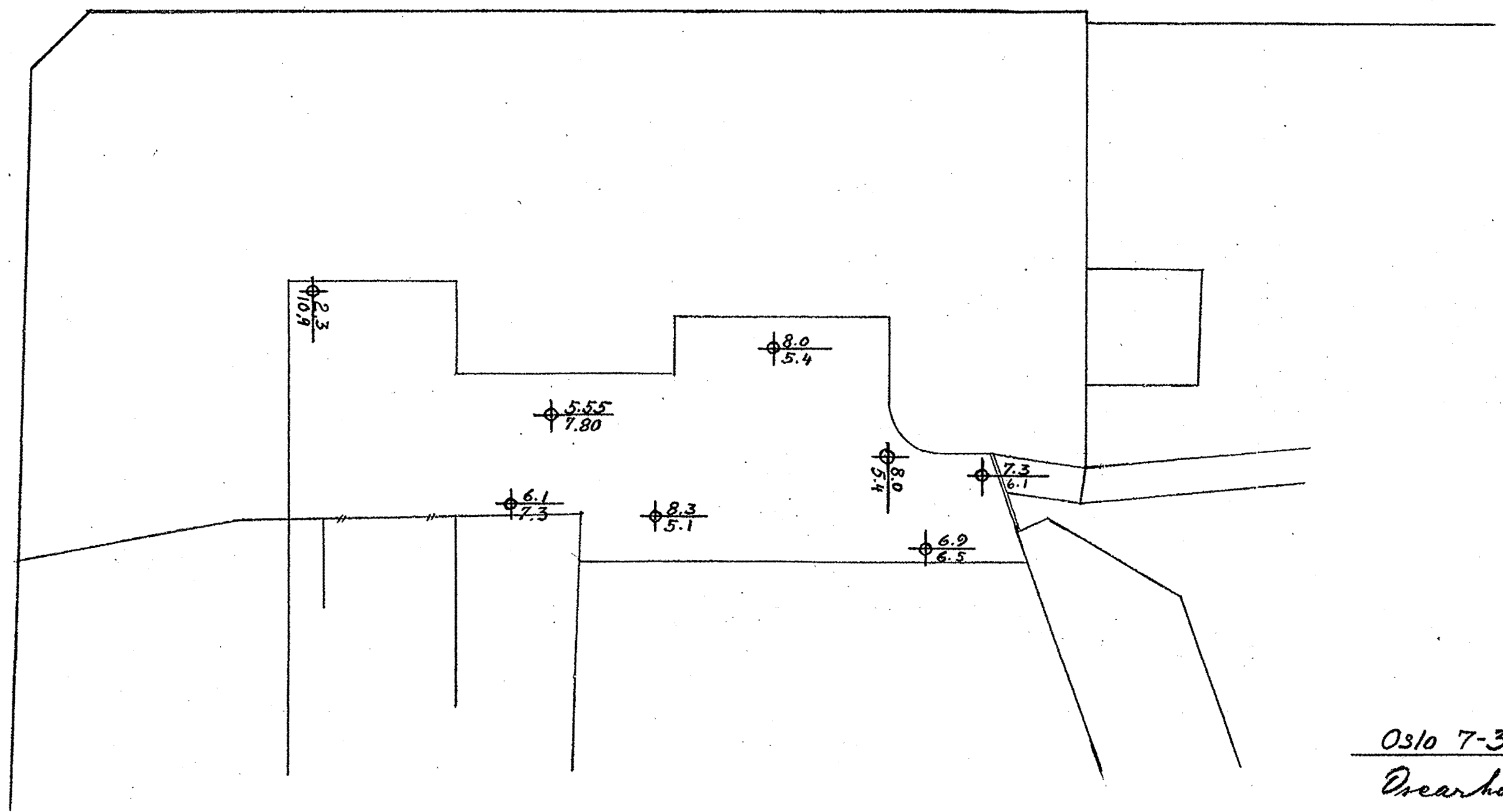

Oslo 7-3-32
Oscarhøeg.