

NV: B2

III

252

*

Bygdøyallé 89

$\frac{14,3}{12,65}$

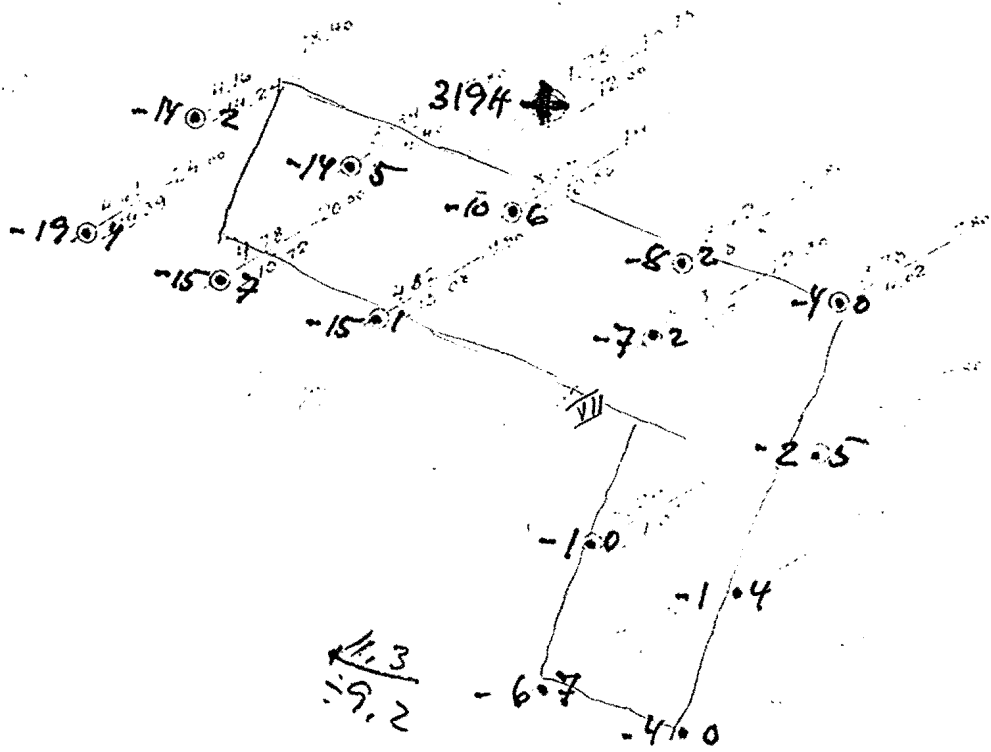

$\frac{14,3}{19,2}$

Prøve hull
til 1 m i
Fyllingen

C2 II

NV: B2 III

H: 1870 A

71/53

C1 II

Grundboringskart over Bygdø Allé nr. 89 og 91 m.m.

M. 1:500

VESTBANEN

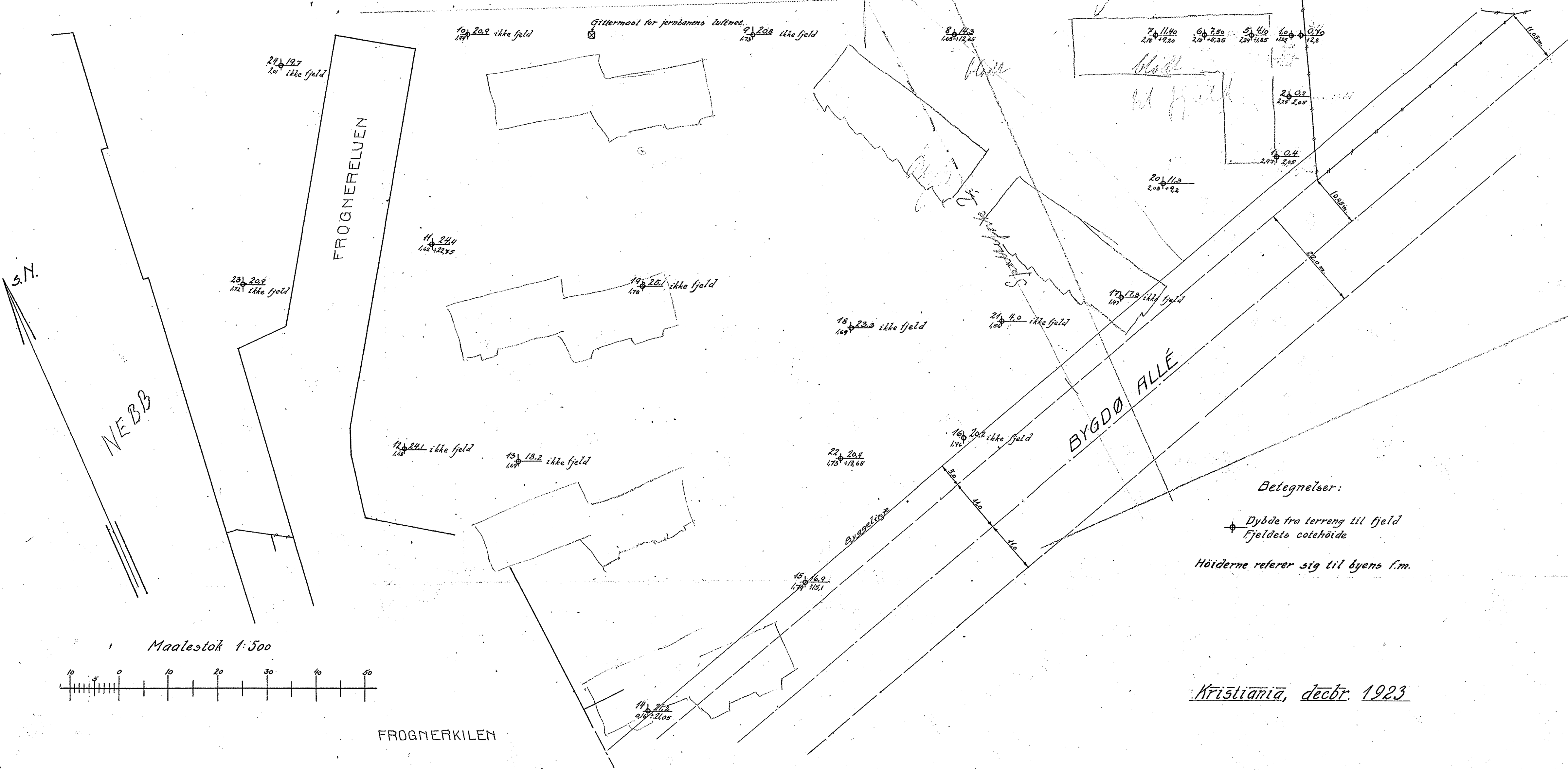

Betegnelser:

⊕ Dybde fra terrang til fjeld
⊙ Fjeldets cotehöide

Höiderne referer sig til byens f.m.

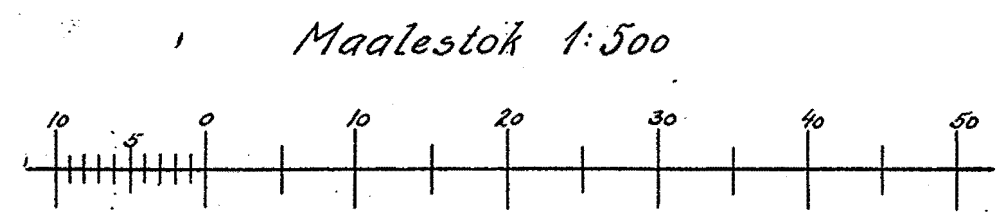

Kristiania, decbr. 1923