

* NO: B1 III · IV

401

Universitetet
"Domus Media"

Universitetets "Domus Media"

Nivelements punkter (nr. 1-29) på overkant
av granitsokkel

M. 1:200 Mål i meter.

Oslo, september 1925
E. Sævi

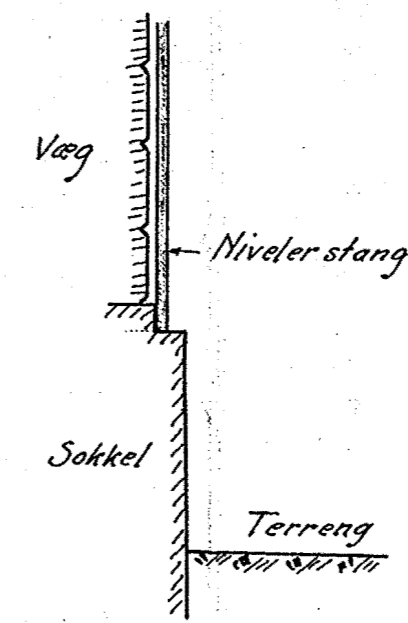

Cotetallene ved punkterne angir sokkelens høide
den 22. septbr 1925.

Høiderne refererer sig til byens ± 0 (middelvandstand)

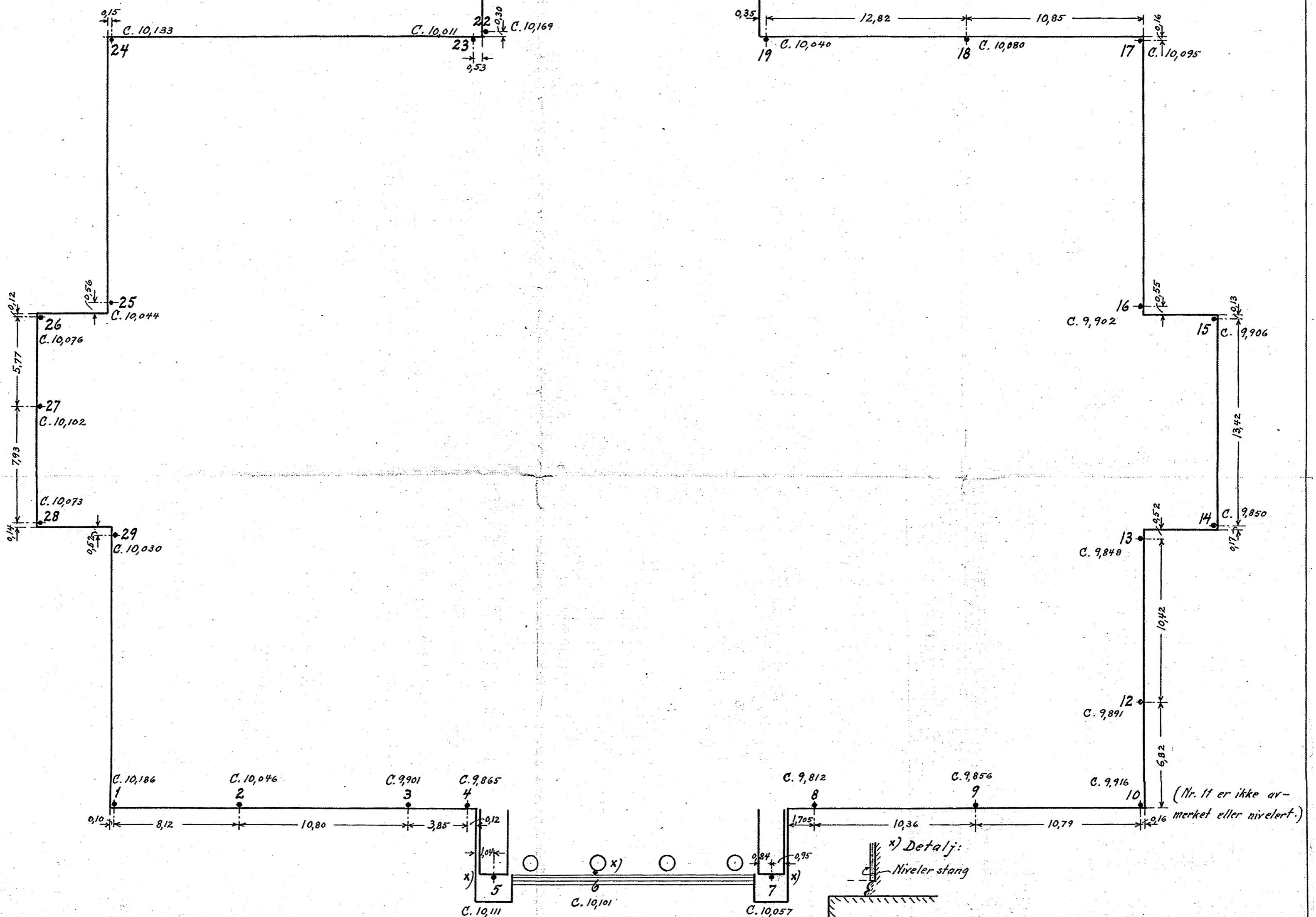

Universitetets "Domus Media"

Måling av horisontalforskyvninger i overkant av fundament'sokkel.

Mål i mm.

Oslo, september 1925
Osmarksgate

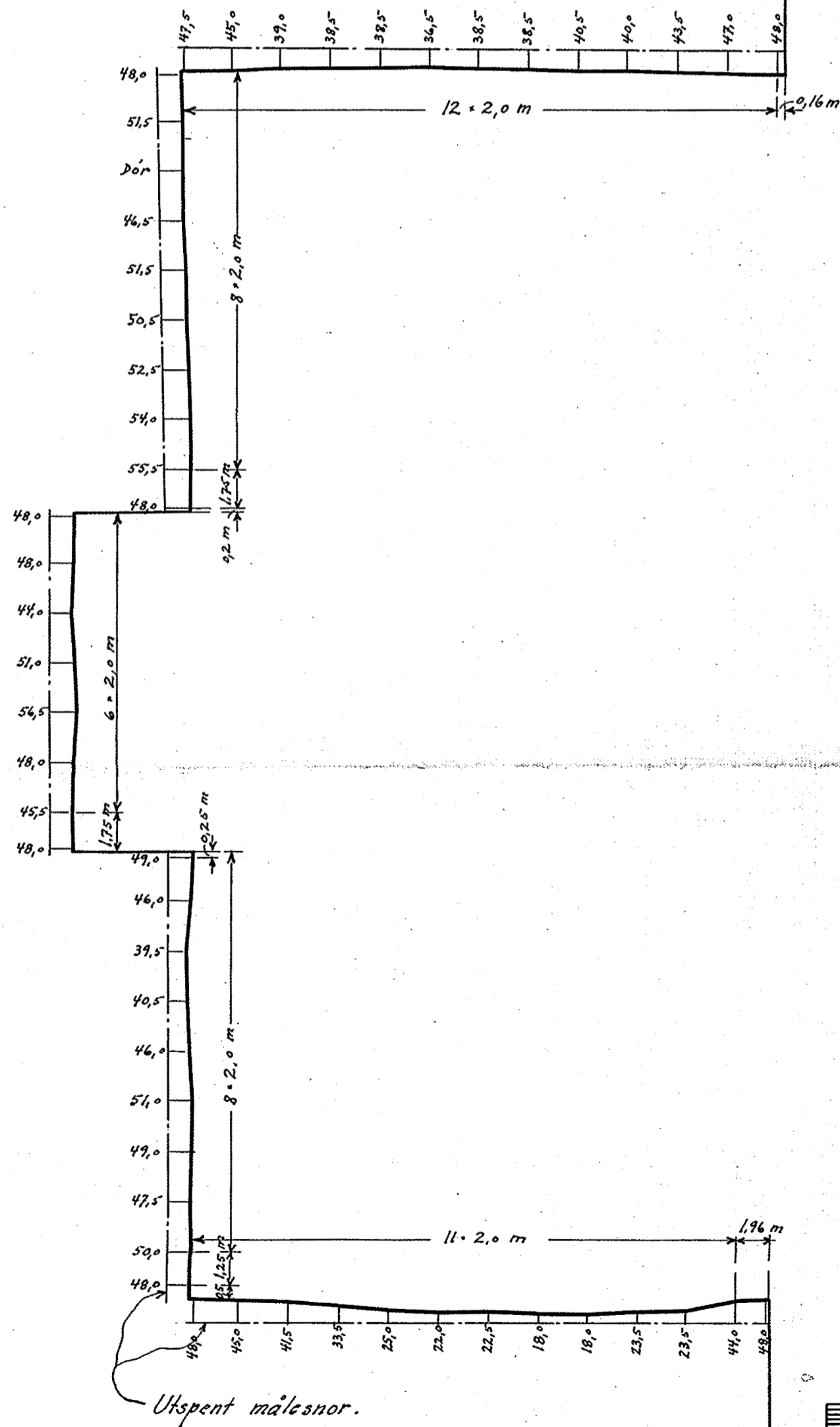

Bilag 4 til kartbl. 401

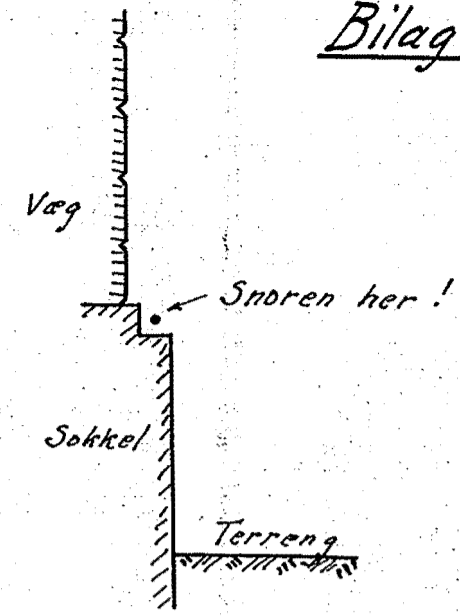

Differensen i de påførte tal godtgjør fasadernes bulning ut og ind av linje. Mål tatt hver anden meter langs fasadene. Sokkelens bulning (stikmålene) er forstørret 20 gange i forhold til længdemålene. M. 1:10 og 1:200

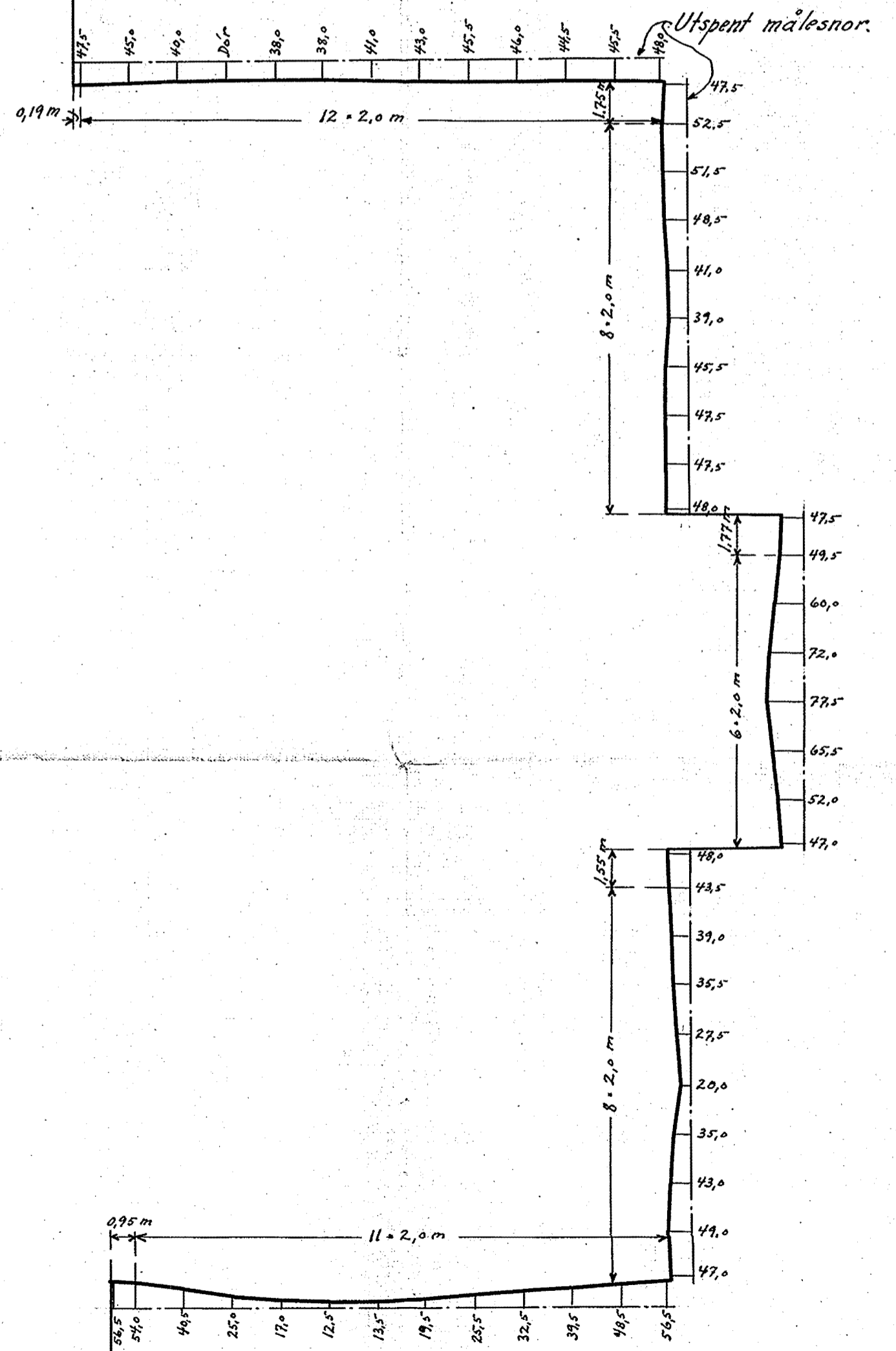

Profiler gjennom grunnboringer for Domus Media

Profil C-C:

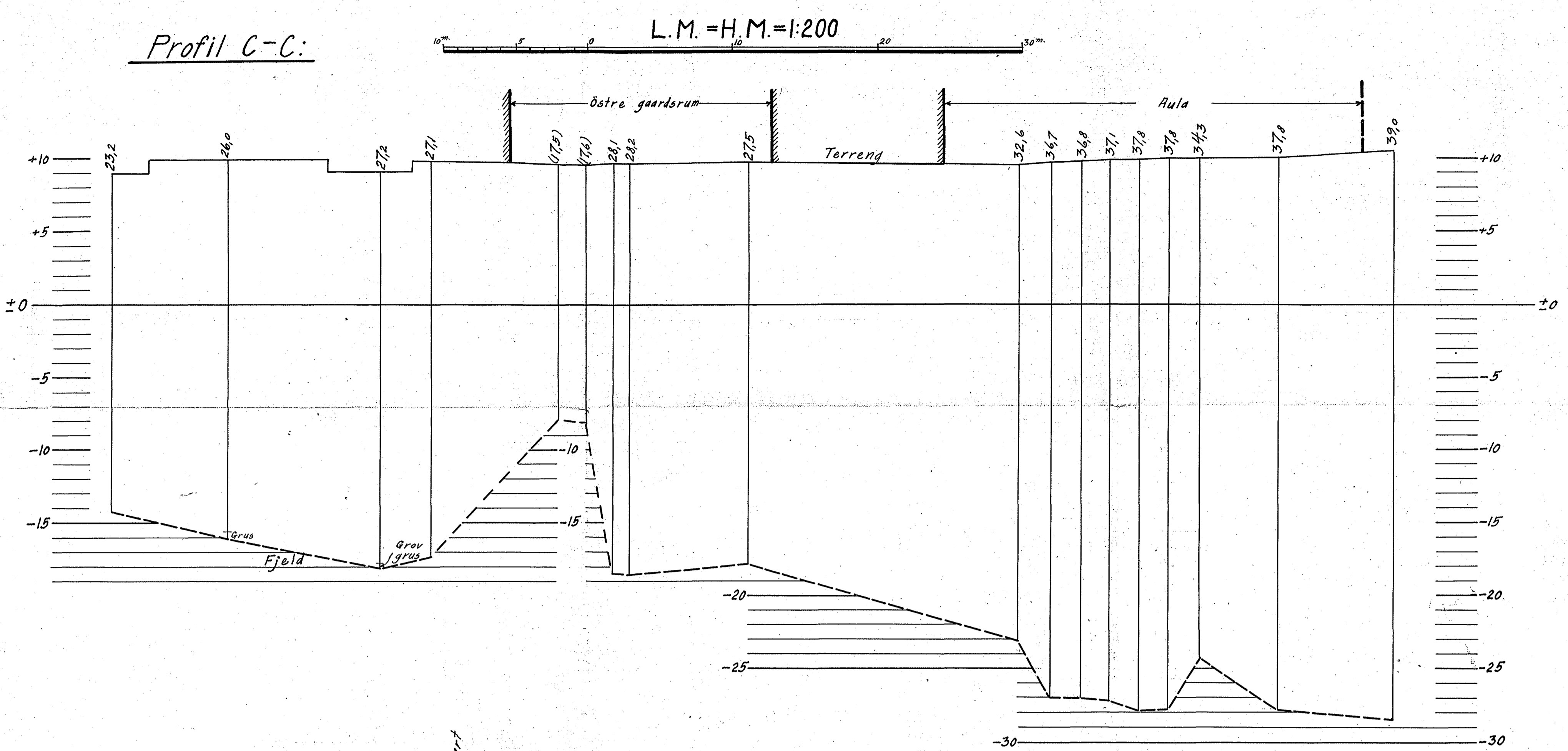

Profil E-E:

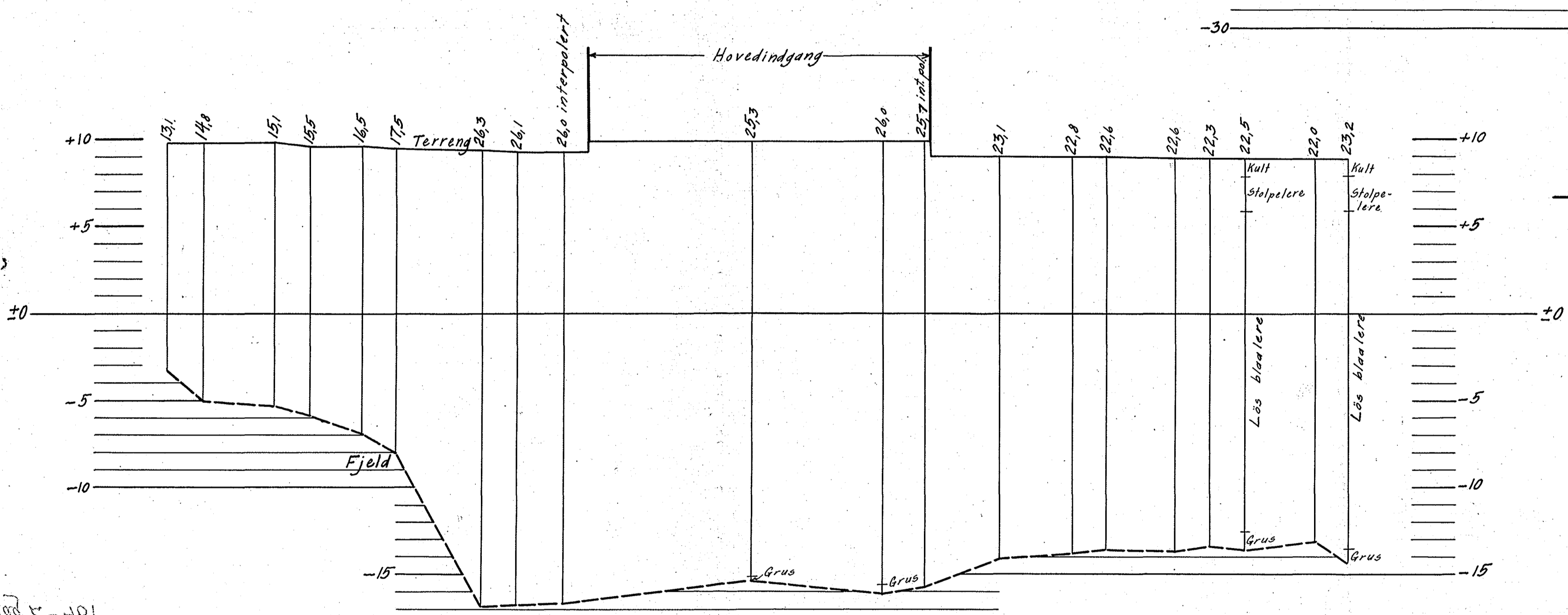

Profil F-F:

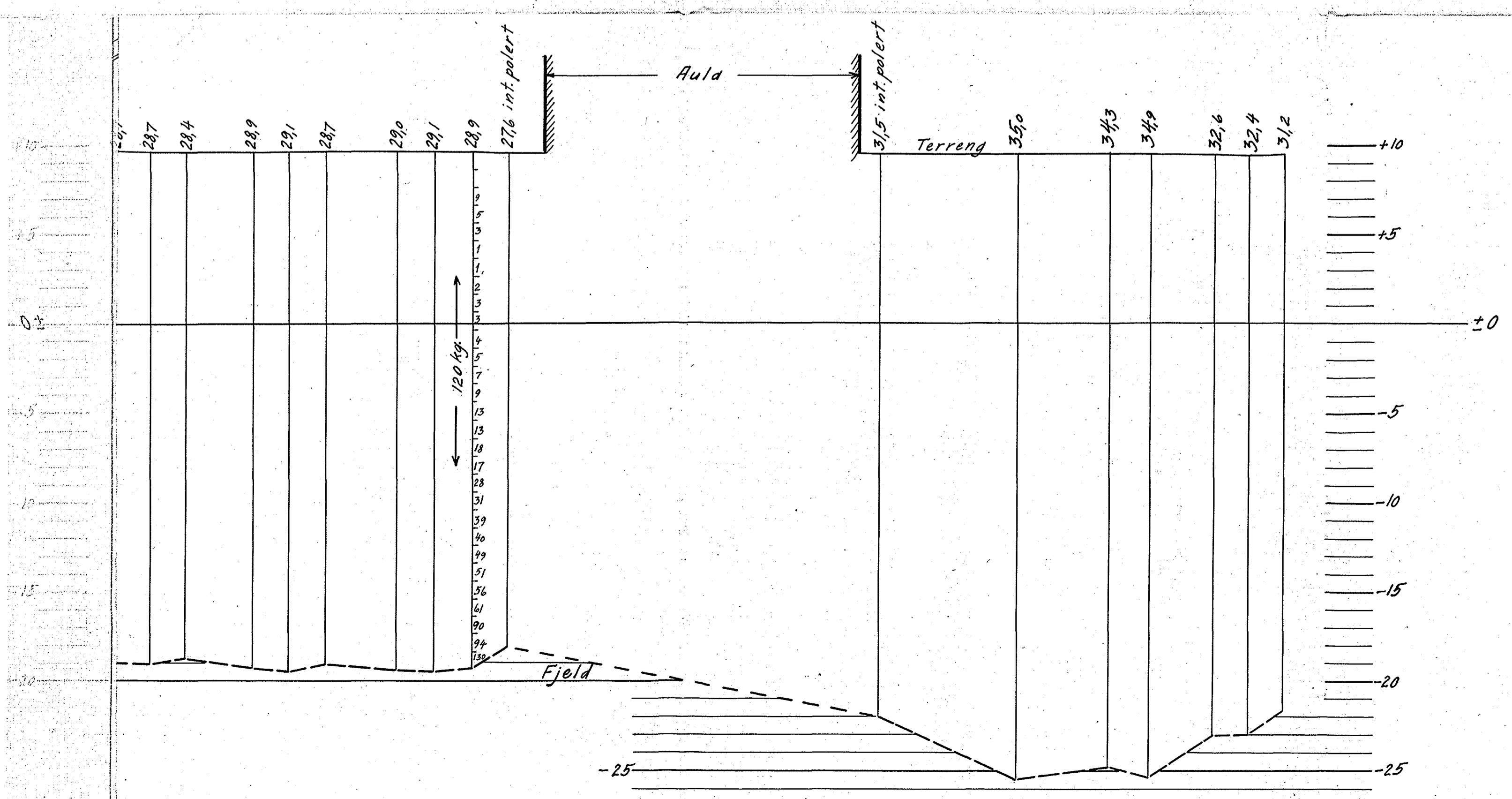

Oslo i juli 1925

Oscar Large

A.K.

Profiler gjennom grunnboringer for Domus Media

L. M. = H. M. = 1:200

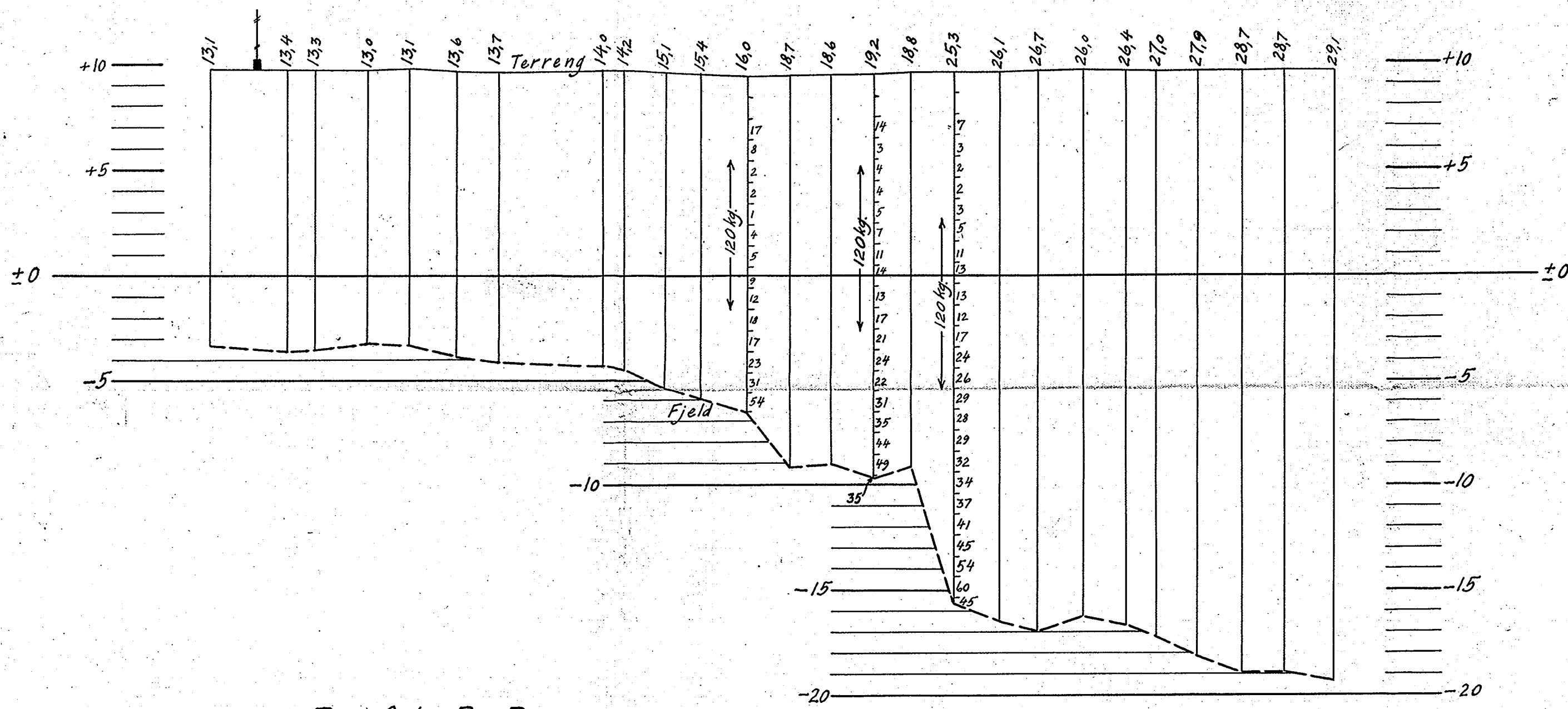
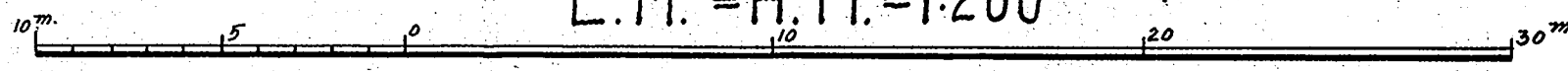

Bilag 1-401

Profil B-B:

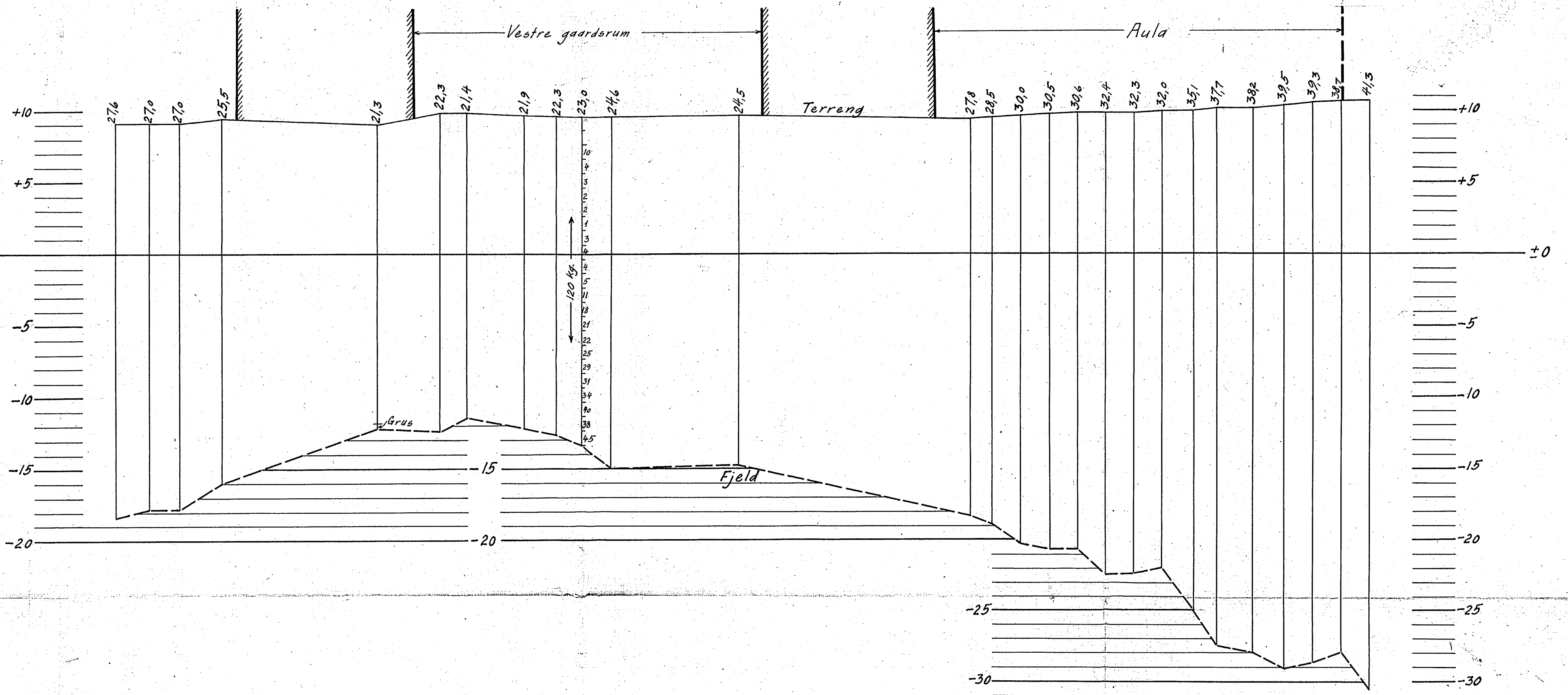

Profil D-D:

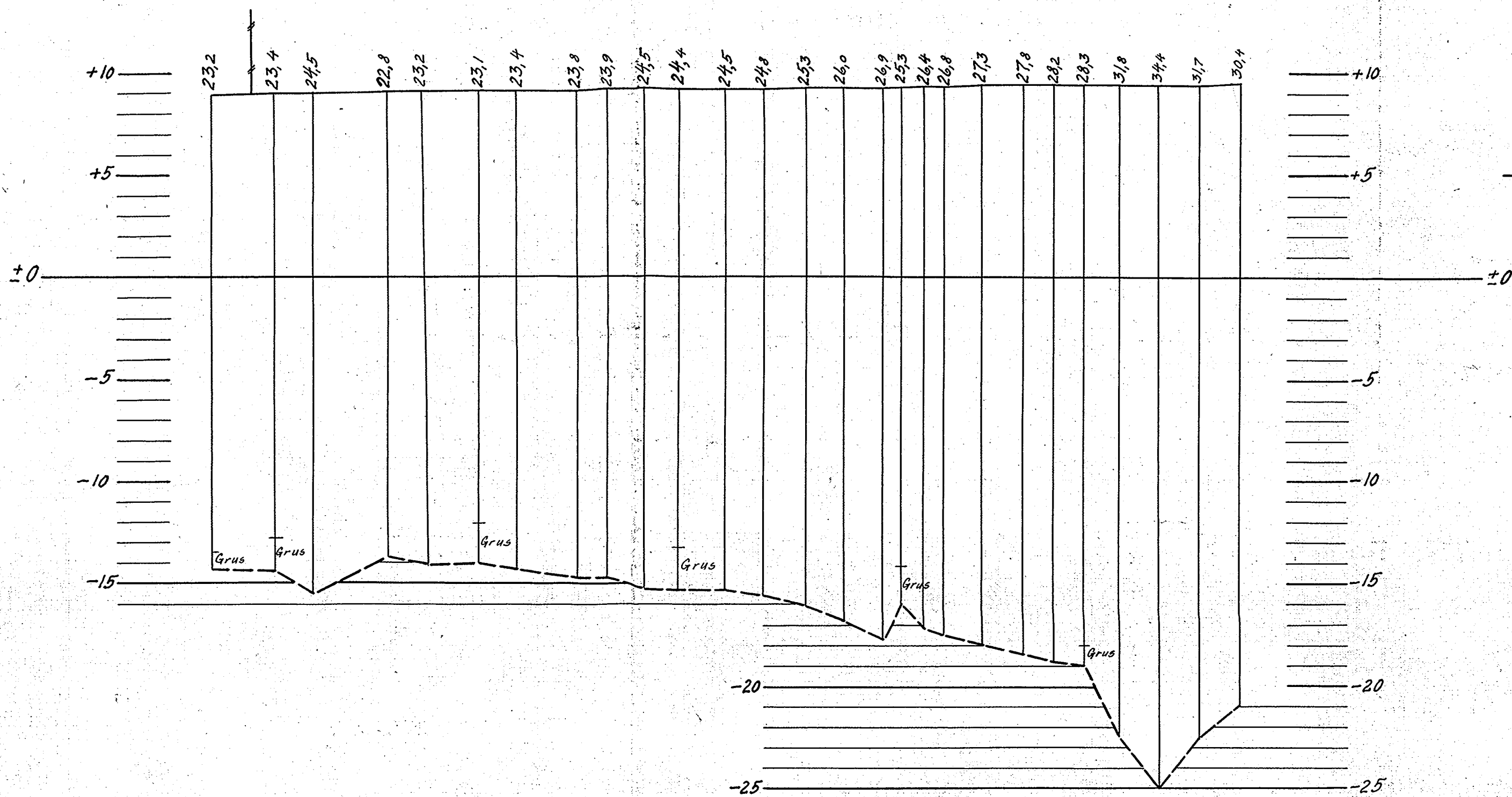

Oslo i juli 1925.

Oscar Large

A. K.

Grundboringskart for Universitetets Domus Media

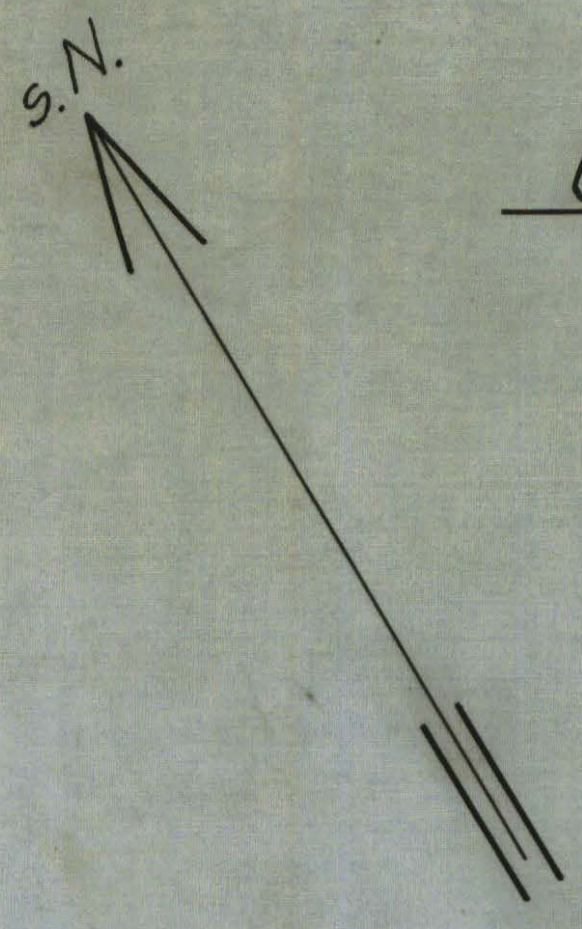

M. 1:200

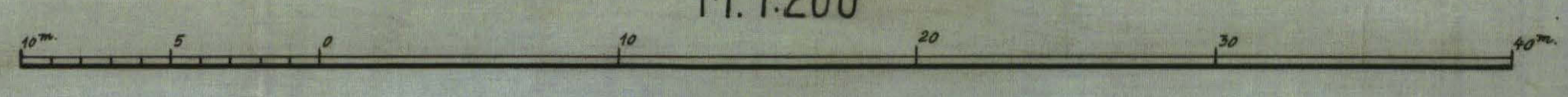

Betegner:

- 17.8 Fjeldets kotehøide i boringspunktet
- Supponerte fjeldkoter, 1st økv. dist.
- Terrengkoter, 1st økv. dist.

Kristian 4. gate

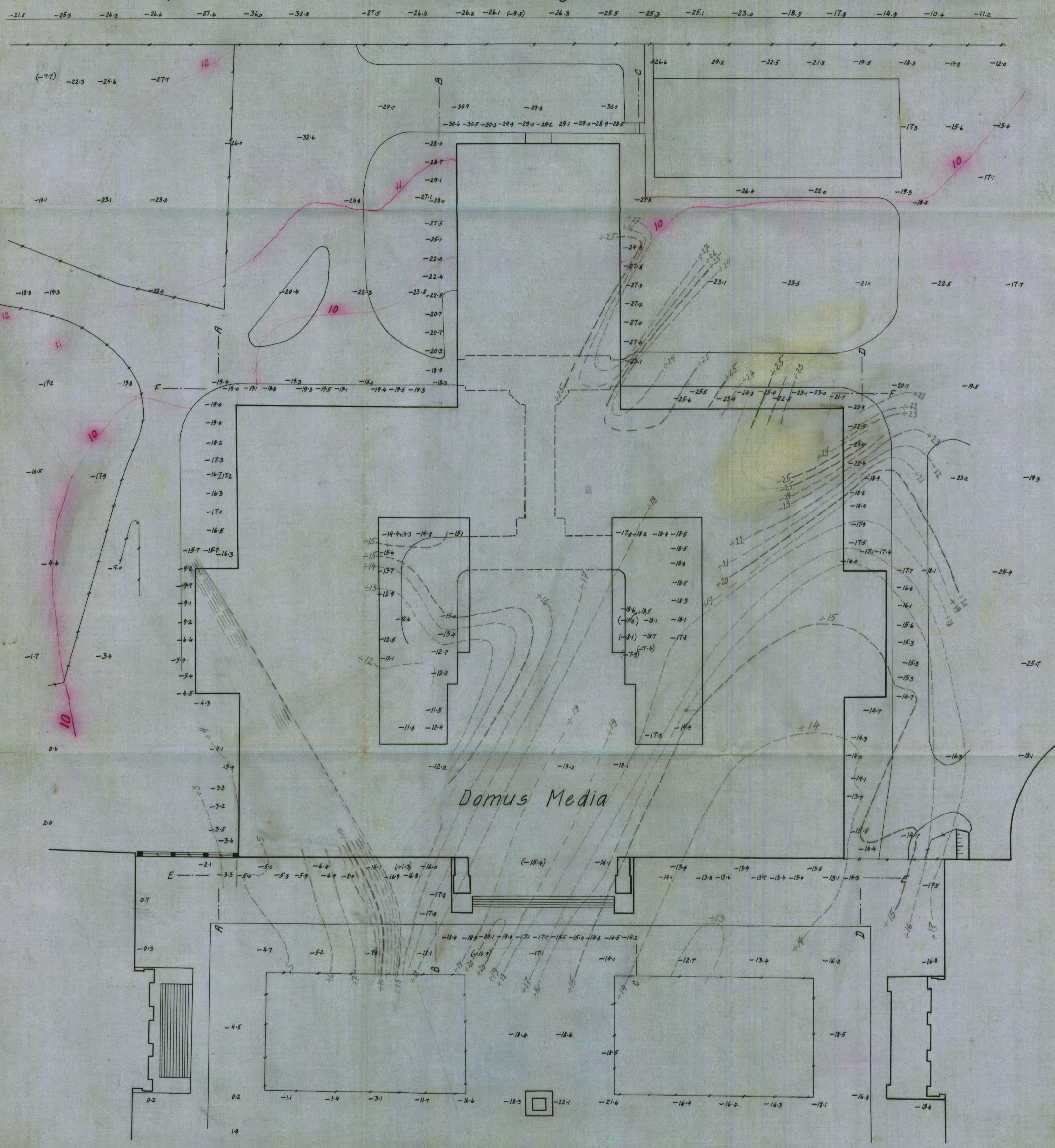

Domus Media

Oslo i juli 1925.
Aarhaug / J. K.