

NGI

62/62-11

Jernbanens forb. tunnel øst-vest  
ved Nils Juelsgt. 35

**OVERFØRT TIL KARTPLATE**

DATO: juli 75

SIGNI



NV:A11



703

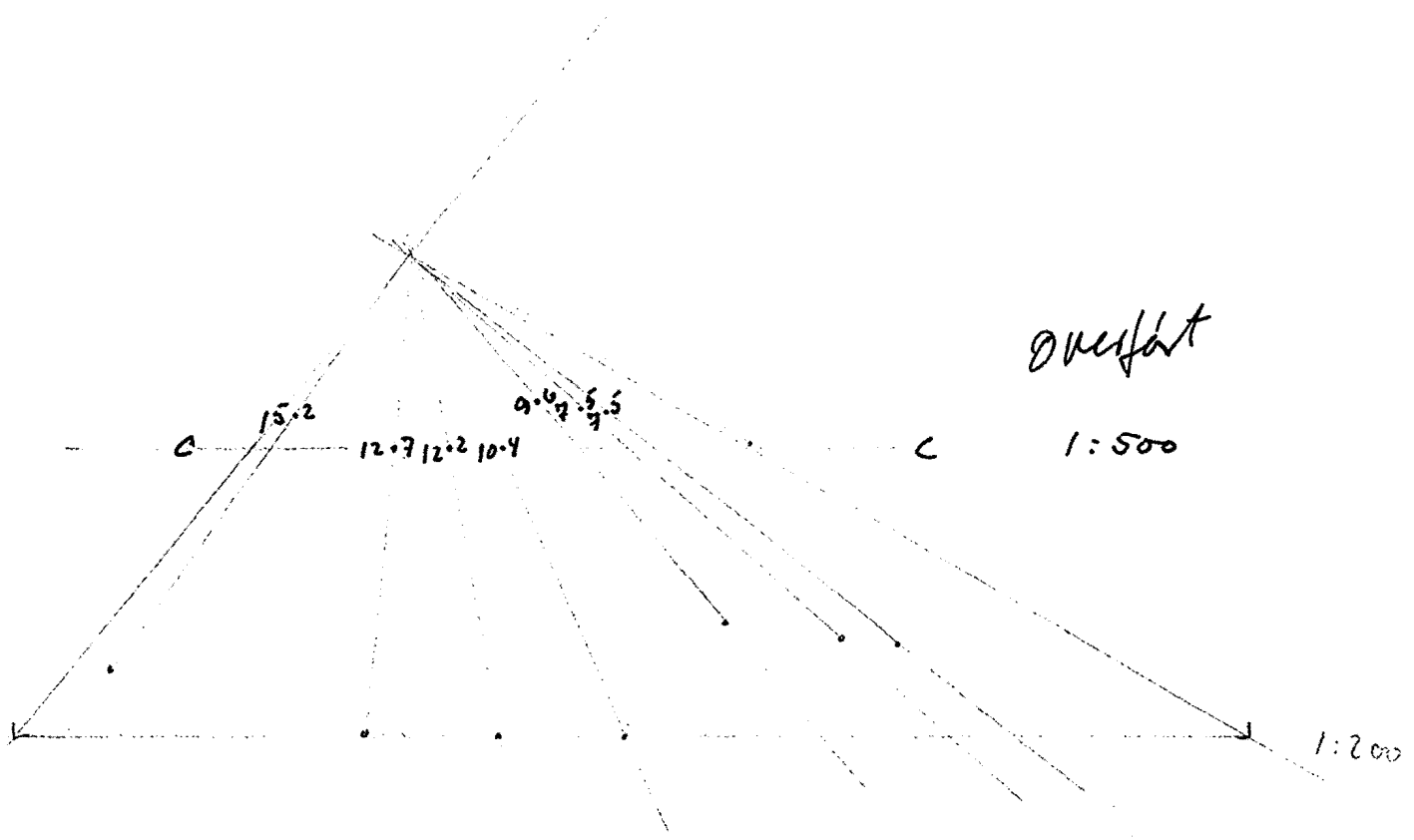

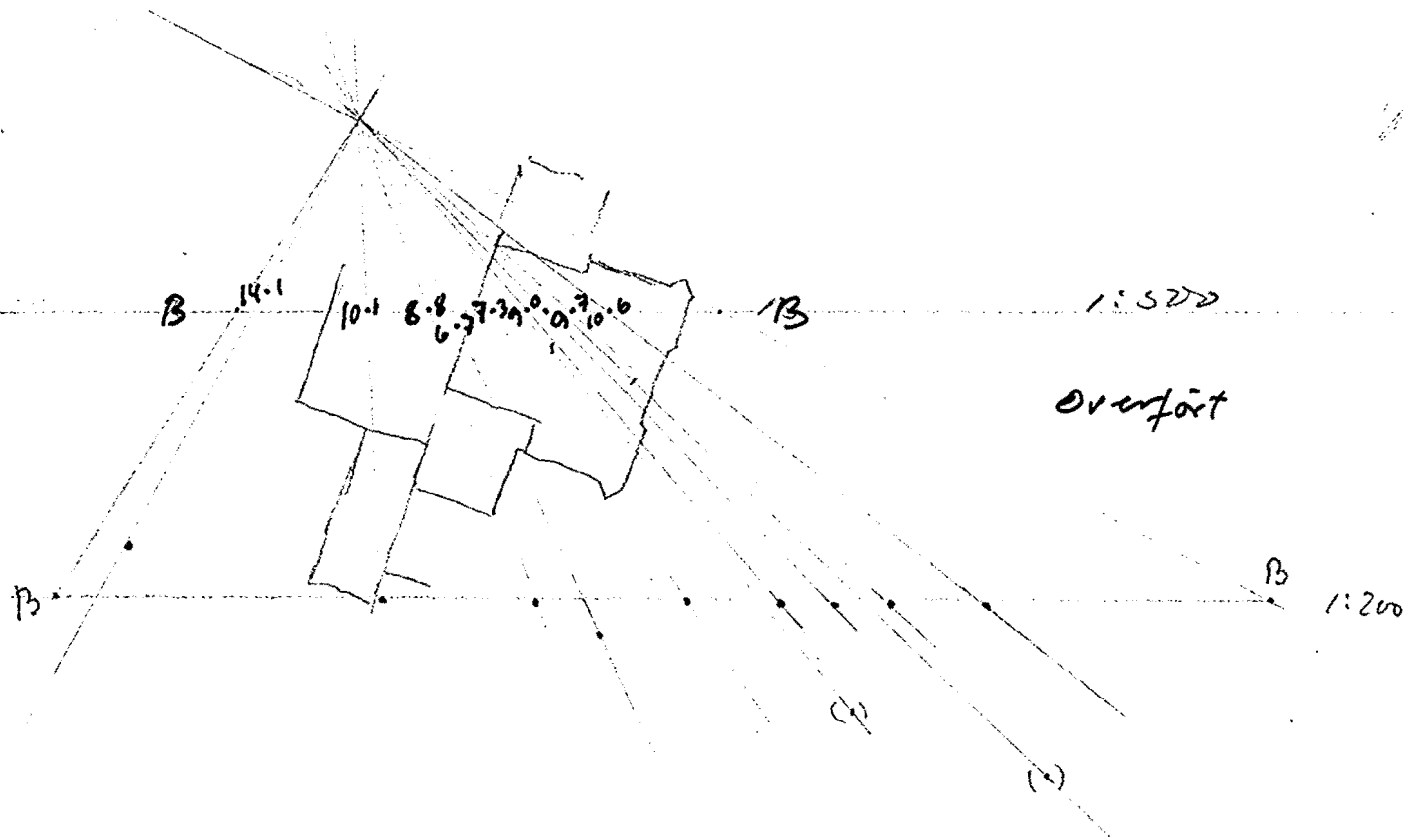

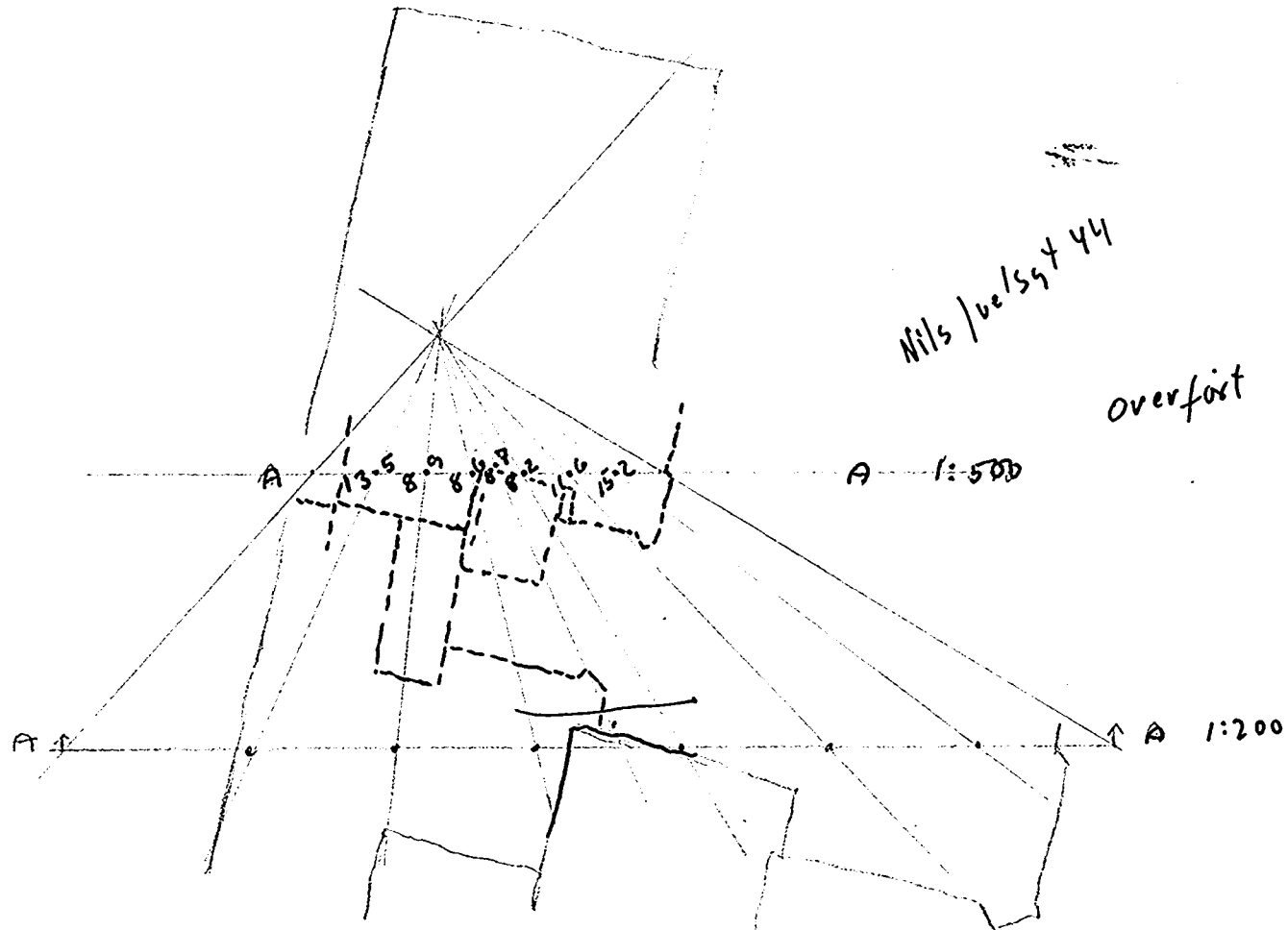

Nils / uel 59 44

overfäst

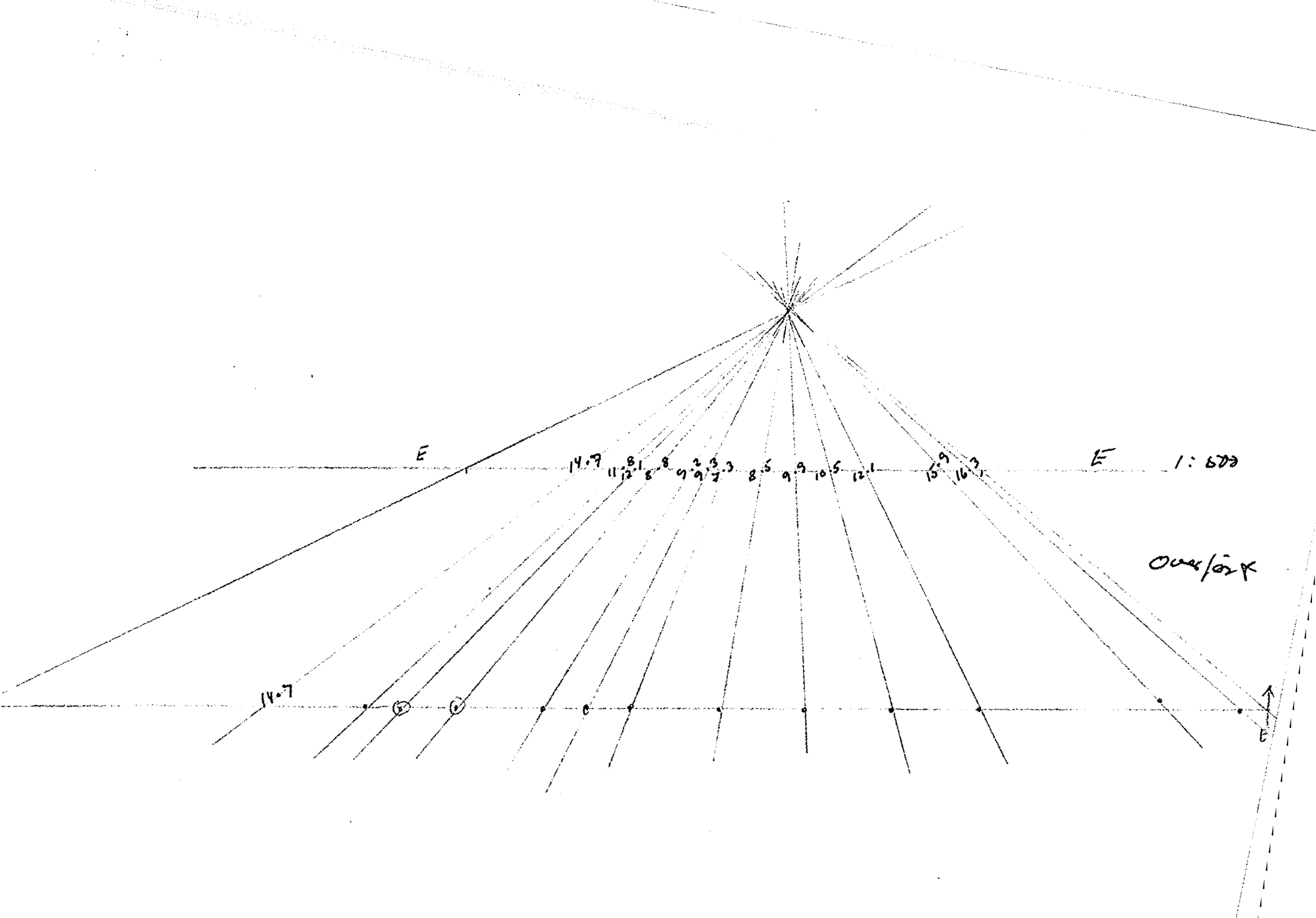

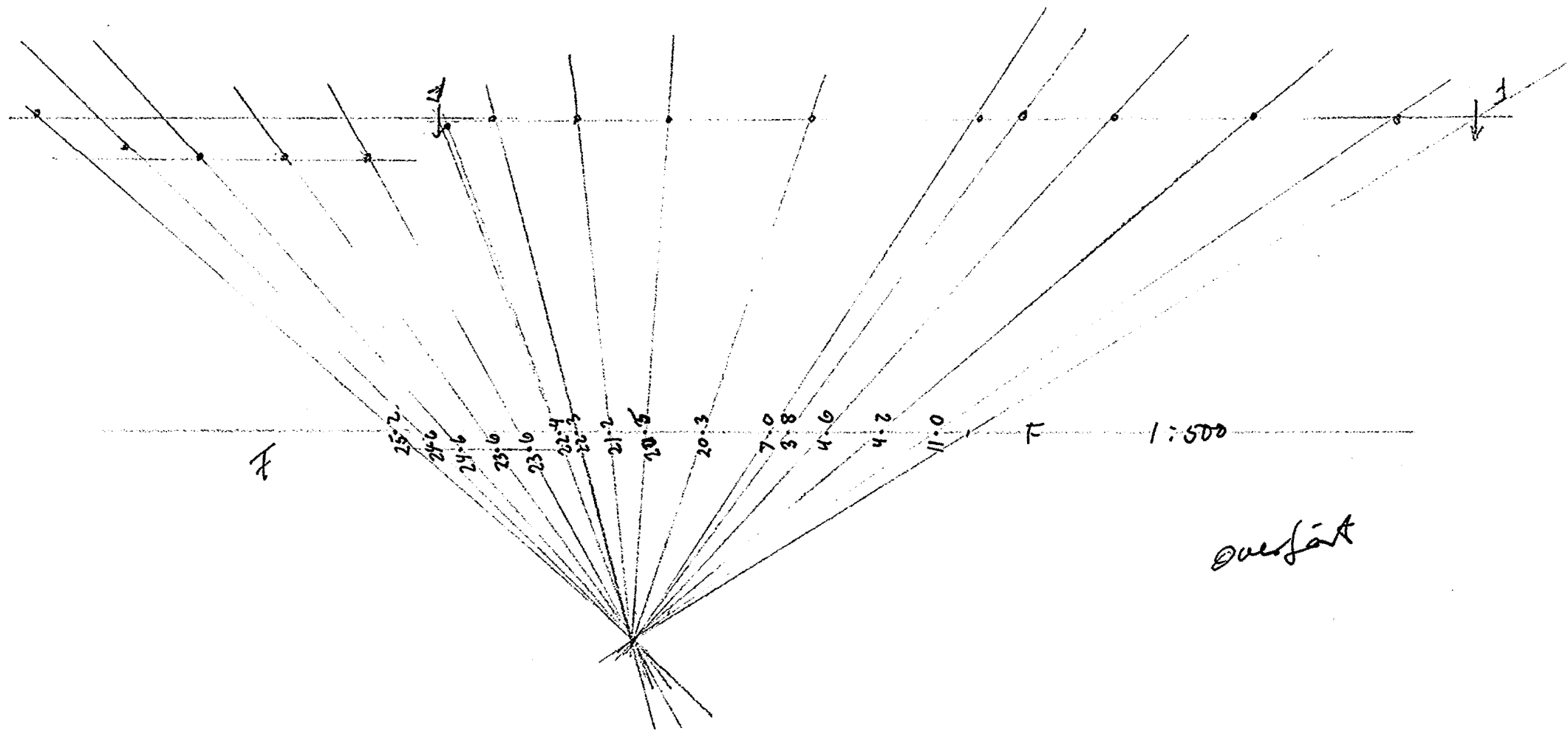

overført

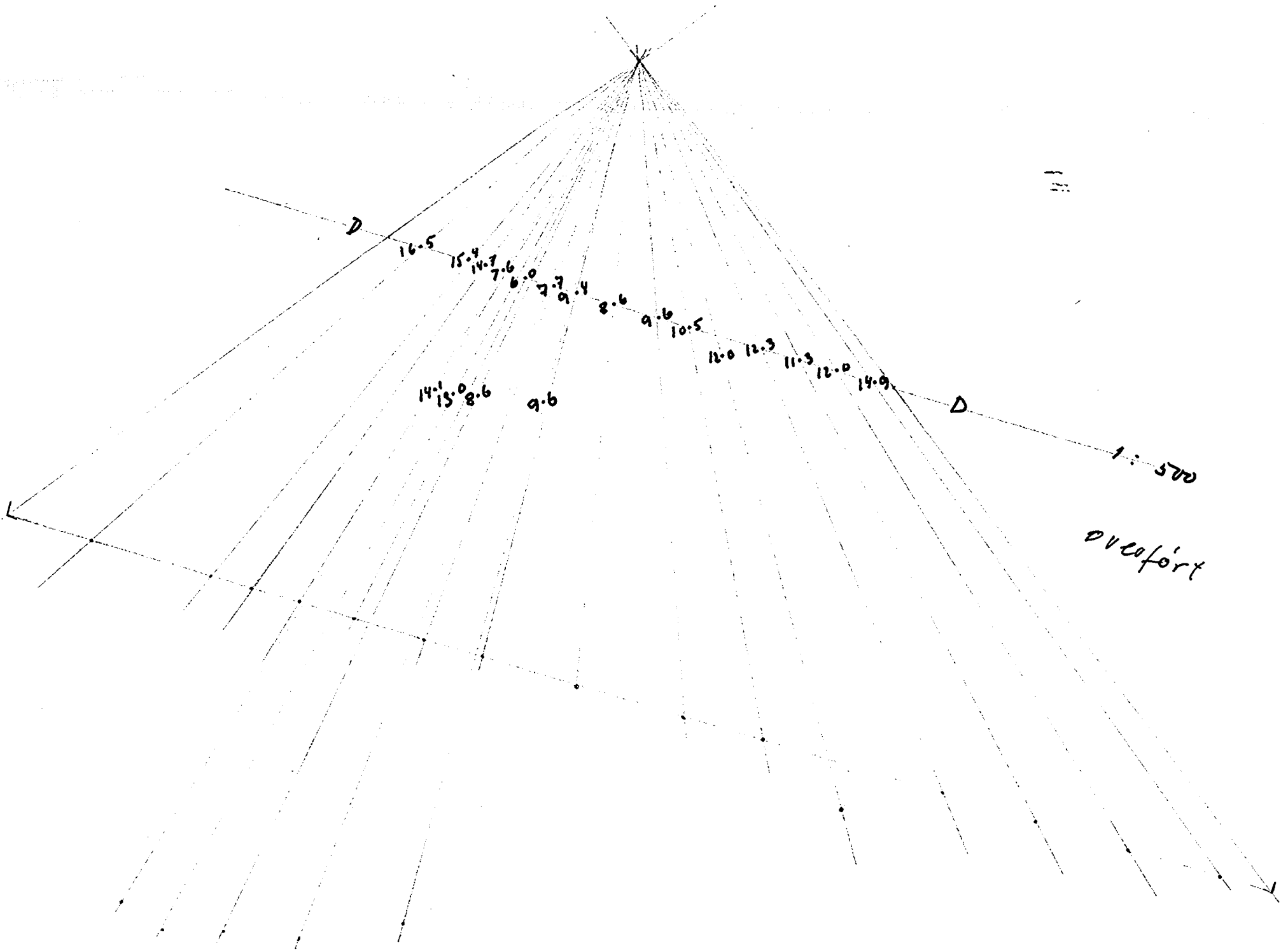

1:500

overfort

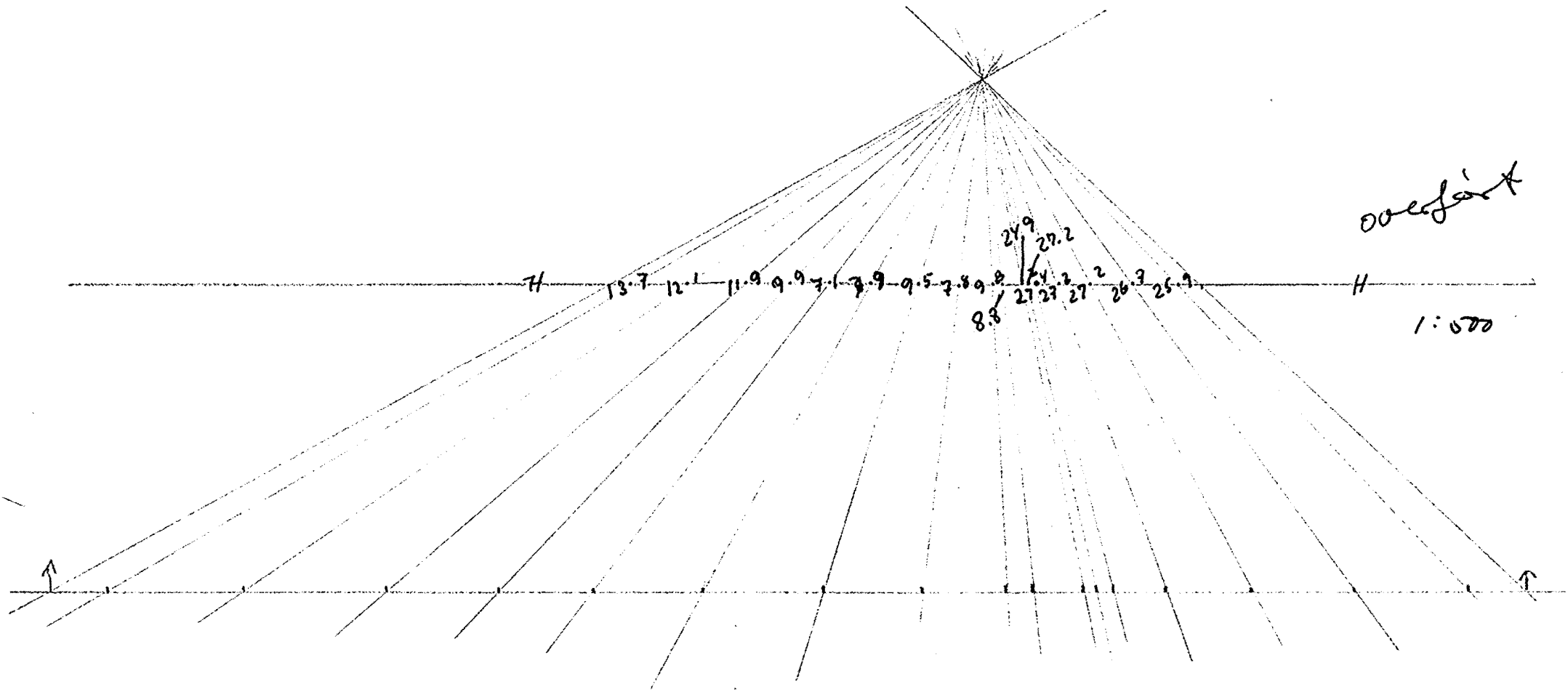

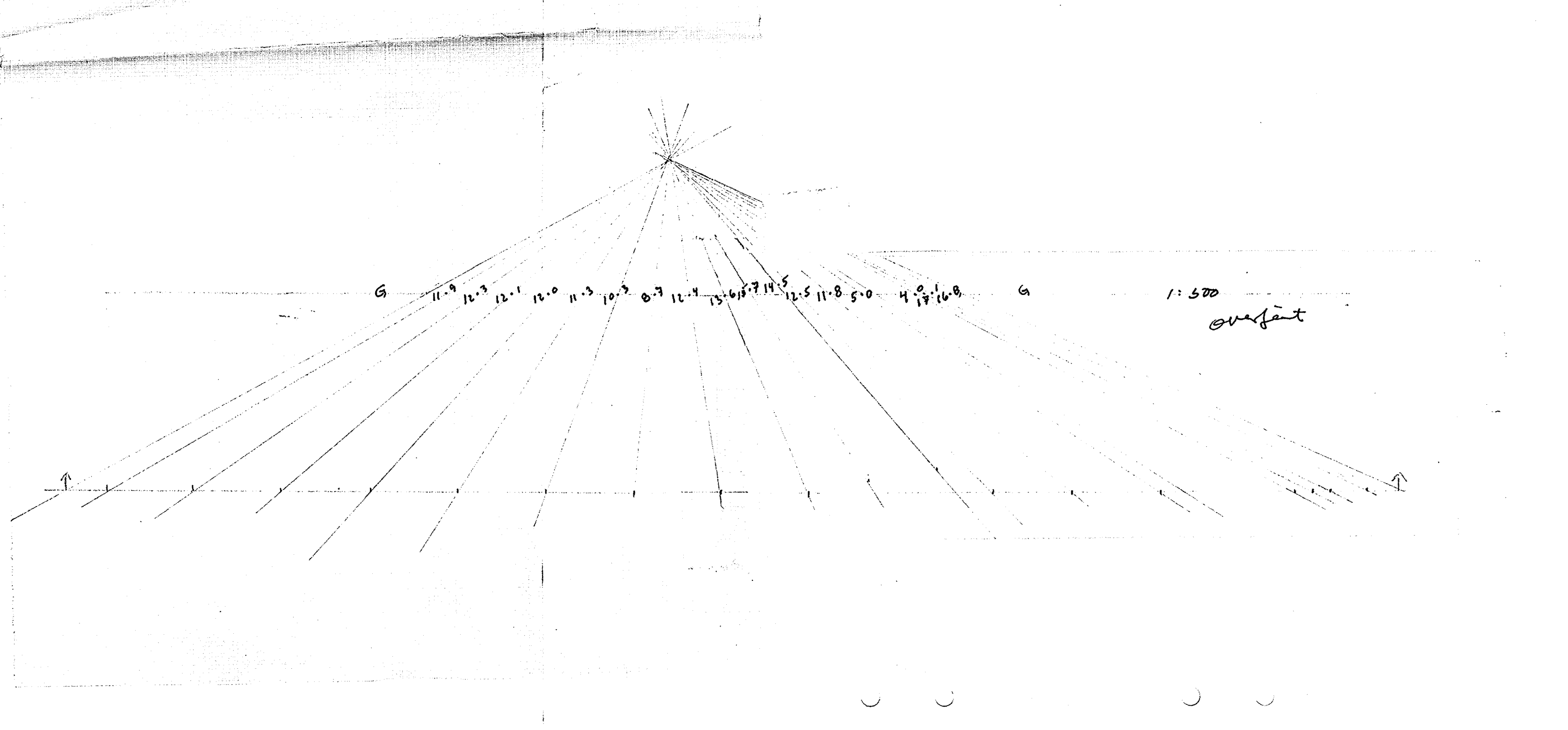

NV: 47 I

**NORGES GEOTEKNISKE INSTITUTT**  
Norwegian Geotechnical Institute

Rapport

Jernbanens forbindelsestunnel øst-  
vest gjennom Oslo. Supplerende  
boringer for kontroll av fjelldybder  
ved Nils Juels gate 35.

62/62-11

30. oktober 1967

FORSKNINGSVEIEN 1, OSLO 3 — TLF. 695880

Bilag 1 : Situasjonsplan med koter

for antatt fjell. / 62/62-8

hentet fra { 12/5-1967

