

NV: B1^I

*

537

Erling Skjalgsonsøt 4-6

orientant et la route gènère

88

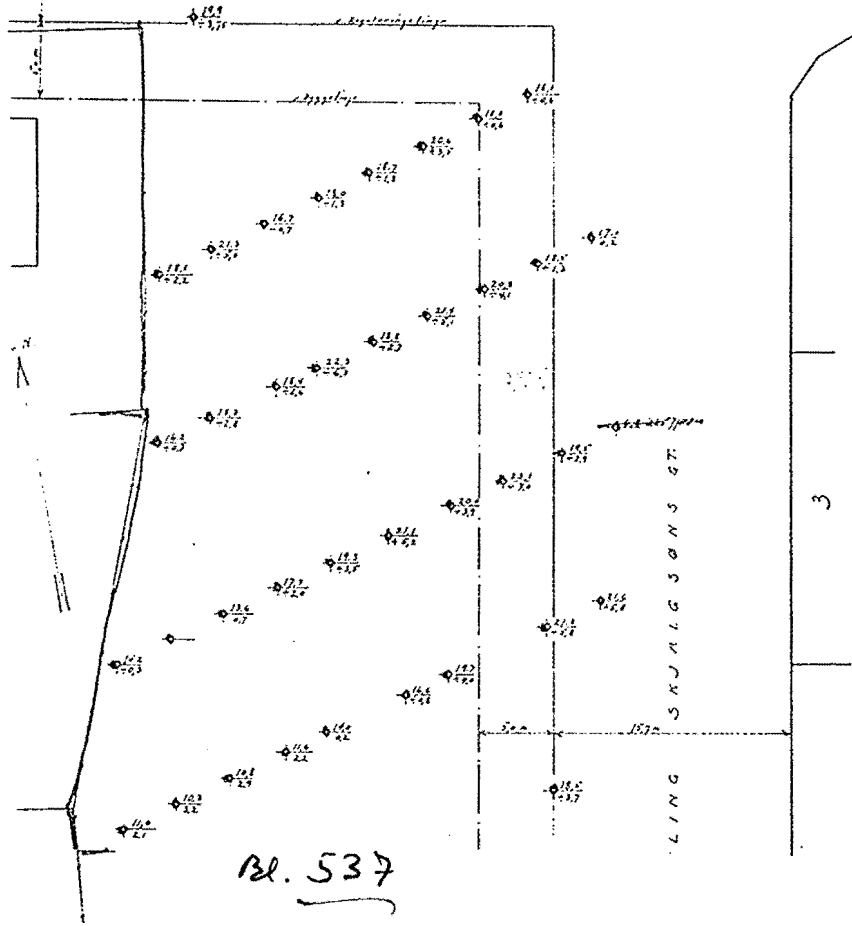

1: 500

ndboringsst

visu d'après le
plan d'alignement
de la route gènère
pour la section
n° 11

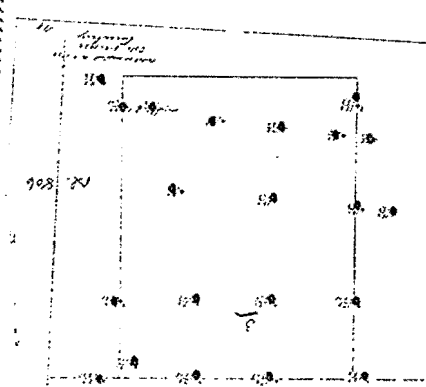
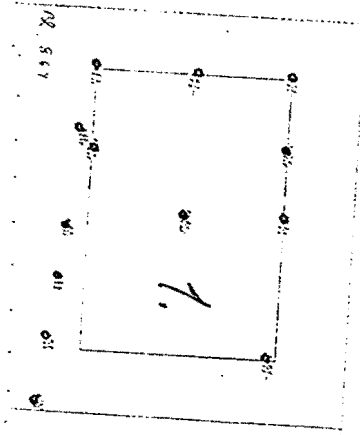

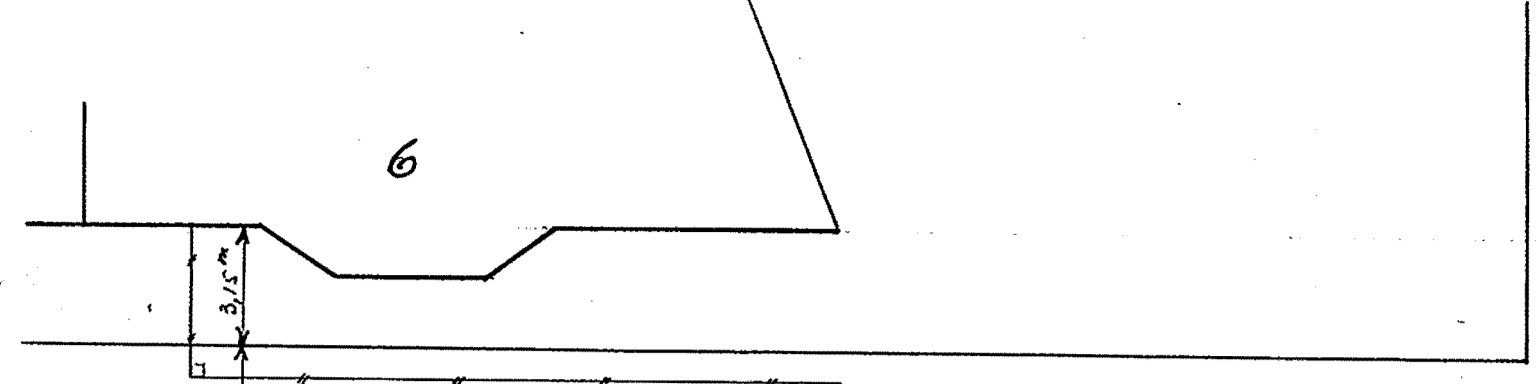

ELISENBERGVEIEN

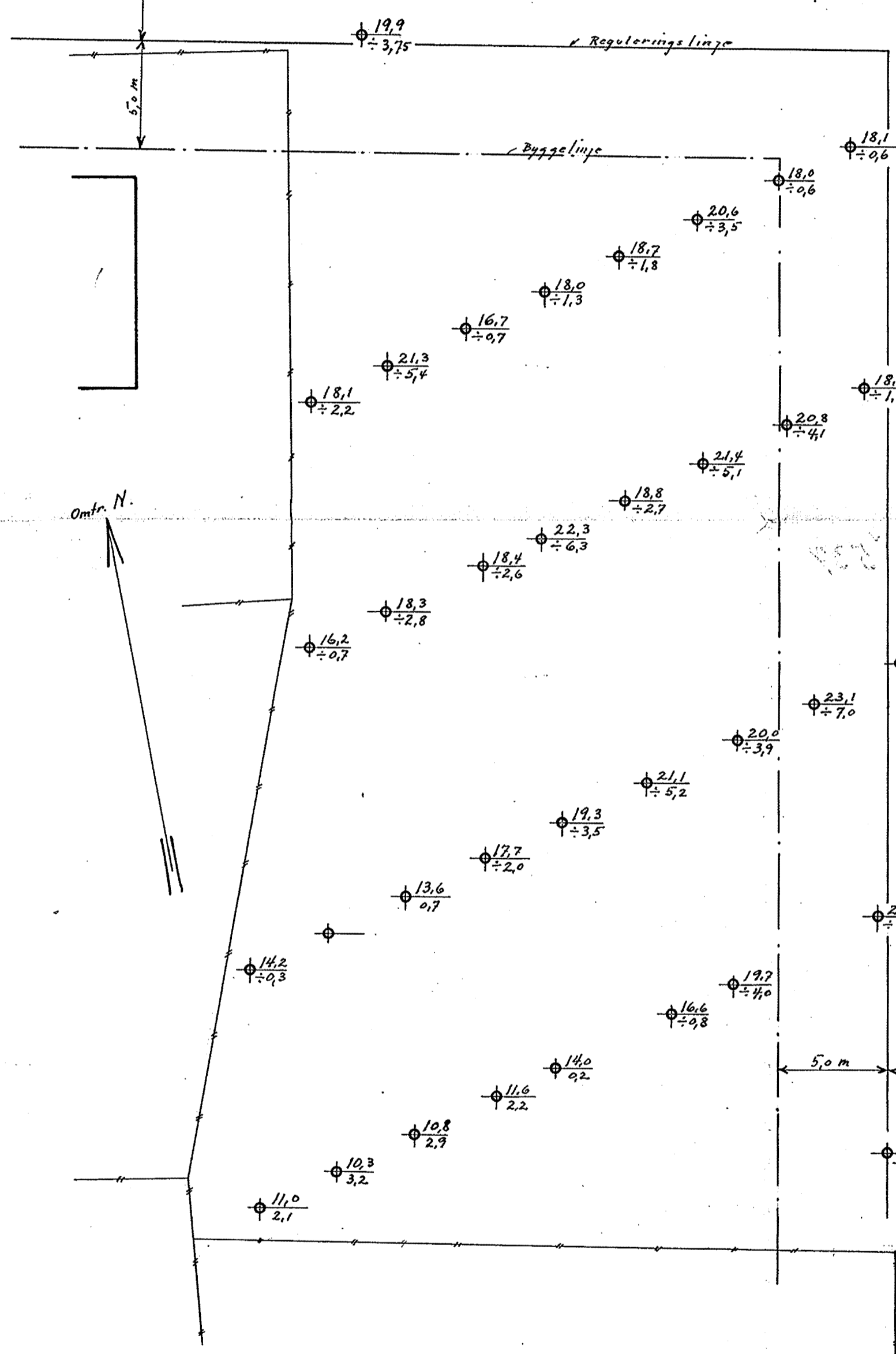

Omt. N.

SKJALGSONS GT.
ERLING

Grundboringskart for nr. 4 og 6 Erling Skjalgsøns gt.
M. 1:200

Forklaring
 • 11,0 dybde i m. fra terrang til fjeld
 • 2,1 fjeldets kotehøide
 Høiderne refererer sig til byens ± 0
 Plankartets absolute nøiagtighet kan ikke garantes.

Oslo, mars 1927
Oscarhøy

Ana kusitt 42

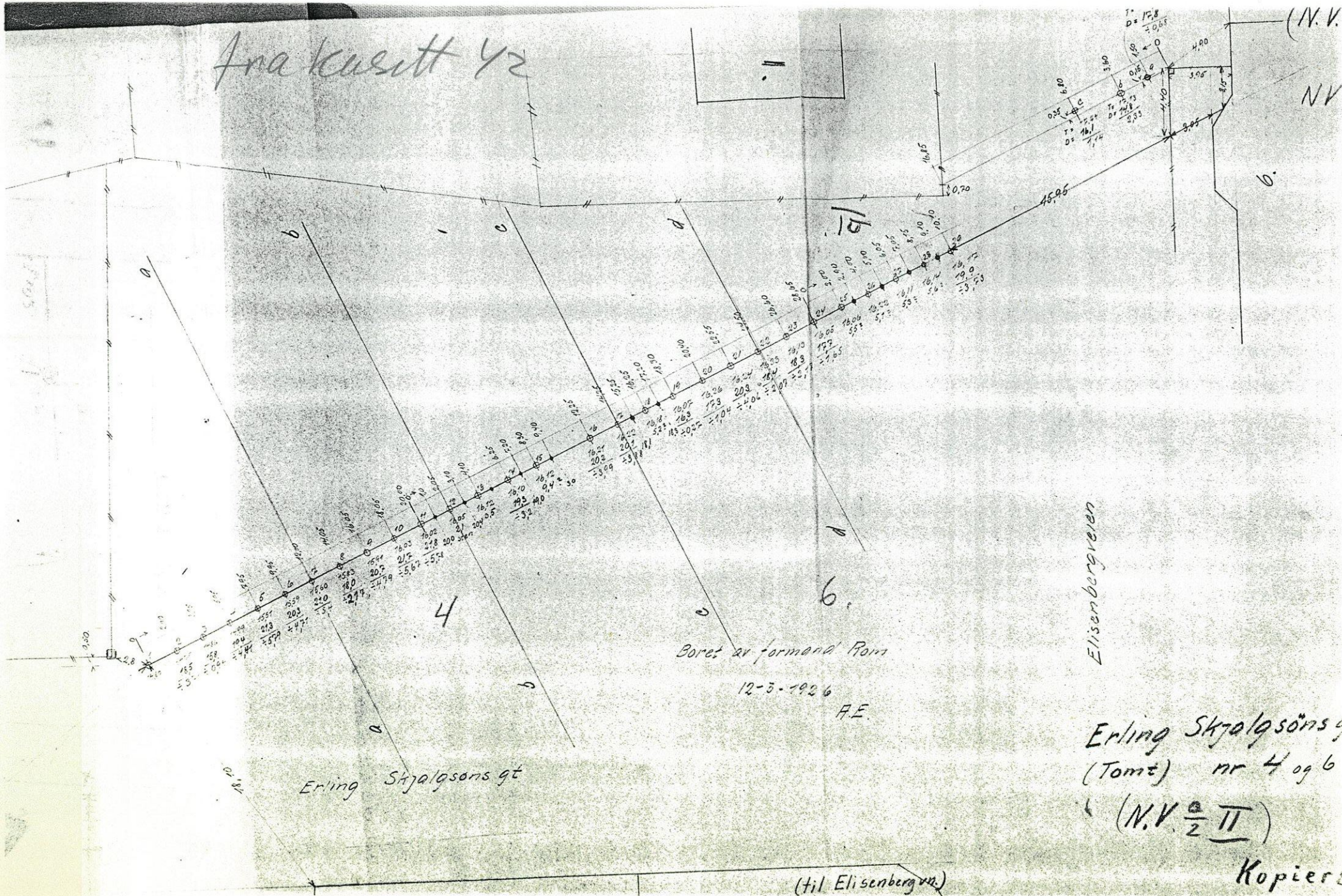

Boret av formand Rom

12-5-1926

A.E.

Erling Skjalgsons gt

Erling Skjalgsons
(Tomt) nr 4 og 6

(N.V. $\frac{1}{2}$ II)

Kopier

(til Elisenbergveien)

Vedlegges Bl 537