

NVA4

Prøvehull I 401 H

Jordart.	Dyp m	V _v	H ₁	H ₃	F	K	O	pH
Tørrskorpeleire	2	37.5		2200			13.7	< 6.6
	3	44.5	140	760	48	8.8		6.6
Leire m/ tørrskorpeklumper	4	49.1	35	79	44	2.0	0.9	7.5
Leire	5	56.8	10	113	47	2.8	0.9	7.8
"	6	50.2	11	72	36	1.8	Sp	8.1
"	7	51.9	9	84	38	2.1	Sp	
" kvikkaktig	8	51.5	2	55	31	1.4		
"	9	48.8	1.1	48	28	1.2		
Kvikkleire	10	50.9	0.4	38	29	0.9		

Prøvehull II

402 H

Jordart.	Dyp m	V _v	H ₁	H ₃	F	K	O	pH
Tørrskorpeleire (fyllmasse)	2	45.6	100	253	47	(5.1)	0	6.6
" (— " —)	3	38.9	296	493	43	(7.2)	0	7.2
Leire (— " —) ?	4	44.5	68	100	40	(2.6)	0	7.2
Tørrskorpeleire	5	42.1	389	1140	53	10.7	1.6	7.2
" melsandig	6	39.2	140	650	33	8.2	1.5	7.2
Grovmo m/ tre og planterester	7	48.9					2.2	6.0
Leire	8	52.9	12	93	41	2.4	0	7.2
Leire m/ tynde finsandlag	9	38.4	7	62	22	1.6	0	6.9

Prøvehull III 403 H

Jordart.	Dyp m	V _v	H ₁	H ₃	F	K	O	pH
Tørrskorpeleire	2	43.2	296	1470	51	12.3		< 6.6
"	3	43.5	172	895	47	9.5		< 6.6
Leire	4	48.9	29	189	42	4.3		7.5
"	5	53.6	10	172	42	4.0		7.5
Leire, kvikkaktig	6	50.6	3.5	65	31	1.7		8.1
"	7	50.6	2.2	54	30	1.4		
"	8	48.5	1.1	52	28	1.3		
Kvikkleire	9	51.5	0.8	(37)	28			
"	10	52.0	0.7	43	28	1.1		

x) Litt nedsatt fasthet

Prøvehull IV 404 H

Jordart.	Dyp m	V _v	H ₁	H ₃	F	K	O	pH
Tørrskorpeleire (fyllmasse)	2	40.3	463	895	51	(9.5)	0	< 6.6
" (— " —)	3	49.2	55	172	48	(4.0)	0	6.6
"	4	49.9	88	895	53	9.5	0	6.6
Leire	5	49.9	17	140	40	3.4	0	7.5
"	6	48.8	20	136	38	3.3	0	7.8
"	7	50.0	13	100	37	2.6	0	
"	8	51.1	11	98	32	2.5	0	
"	9	52.5	12	95	41	2.4	0	
"	10	52.0	12	86	41	2.2	0	

Prøvehull V 405 H

Jordart.	Dyp m	V _v	H ₁	H ₃	F	K	O	pH
Tørrskorpeleire (fyllmasse)	2	44.6	33	210	35	(4.6)		< 6.6
" m/ fin sand (— " —)	3	36.4		158		(3.7)		6.6
Leire m/ sandkorn	4	47.2	12	93	33	2.4		6.9

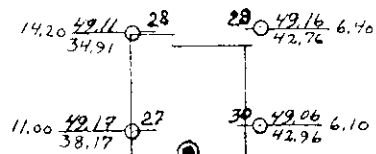

Haukelid 49 809
(1948)