

Haukelid

top. 804

St. Halvardsgt. 50

v/ Trappa

III·II·III  
50: E 1 13:05

*H. J. Jørgensen*



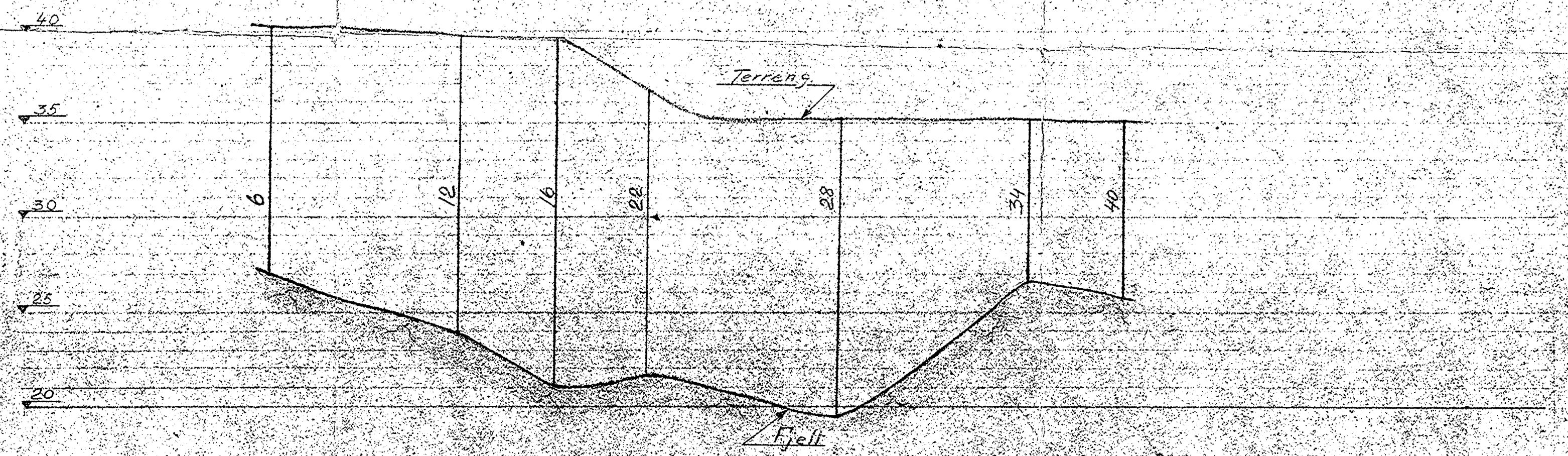
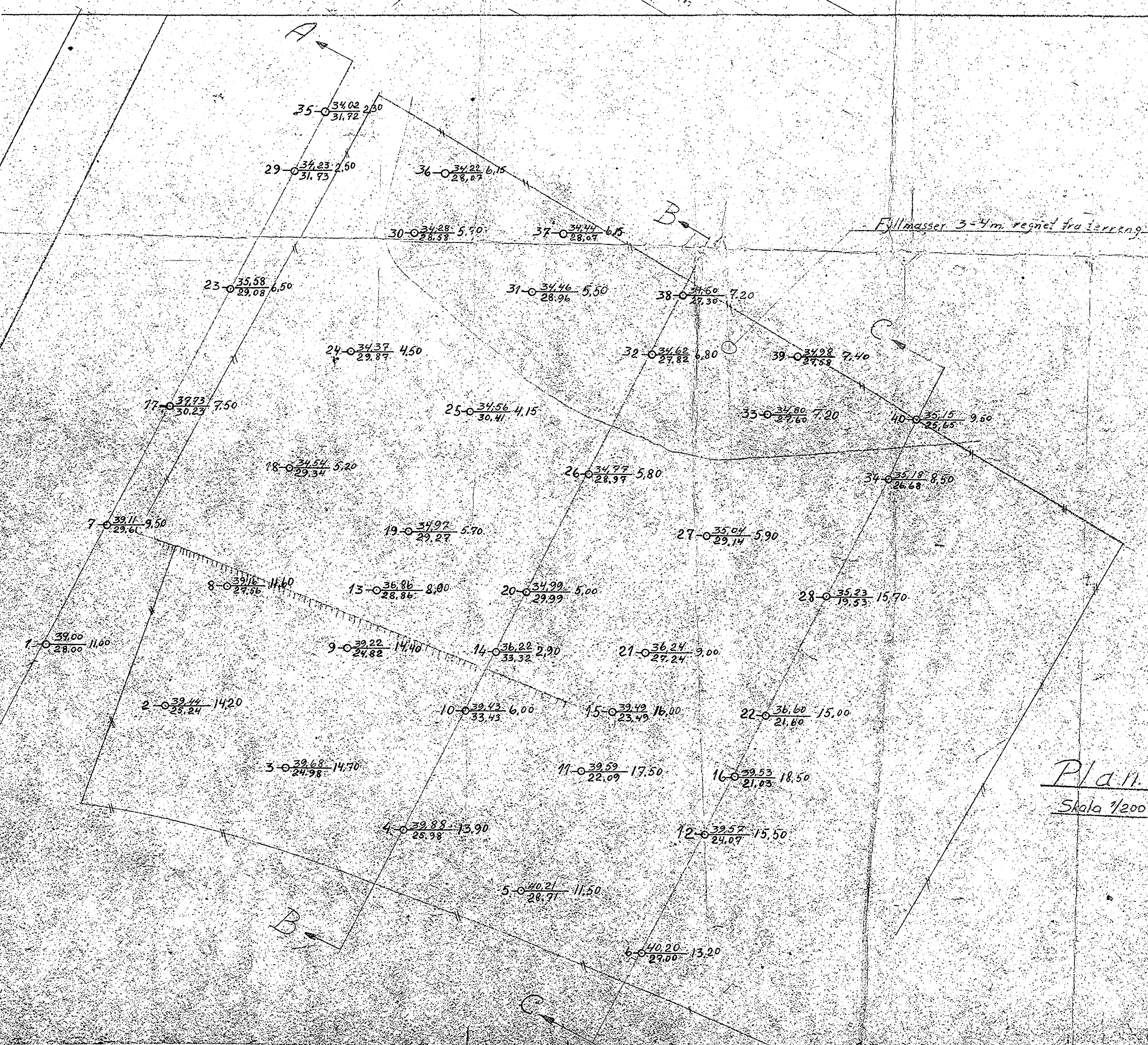
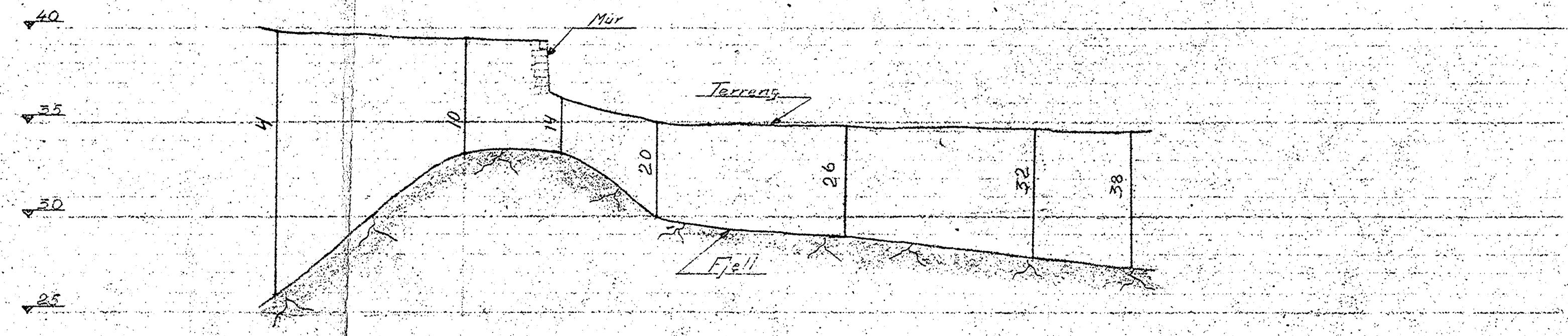
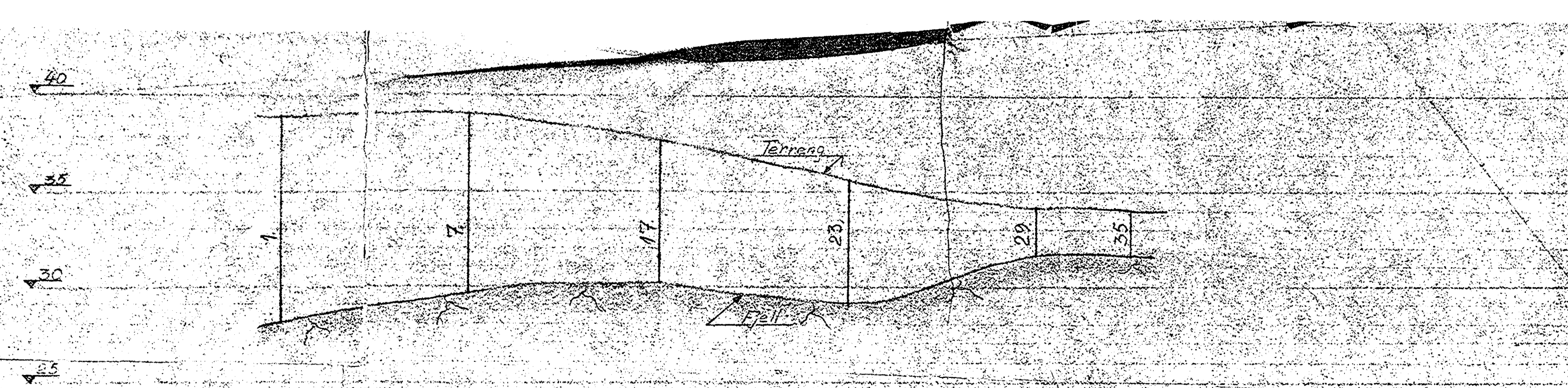
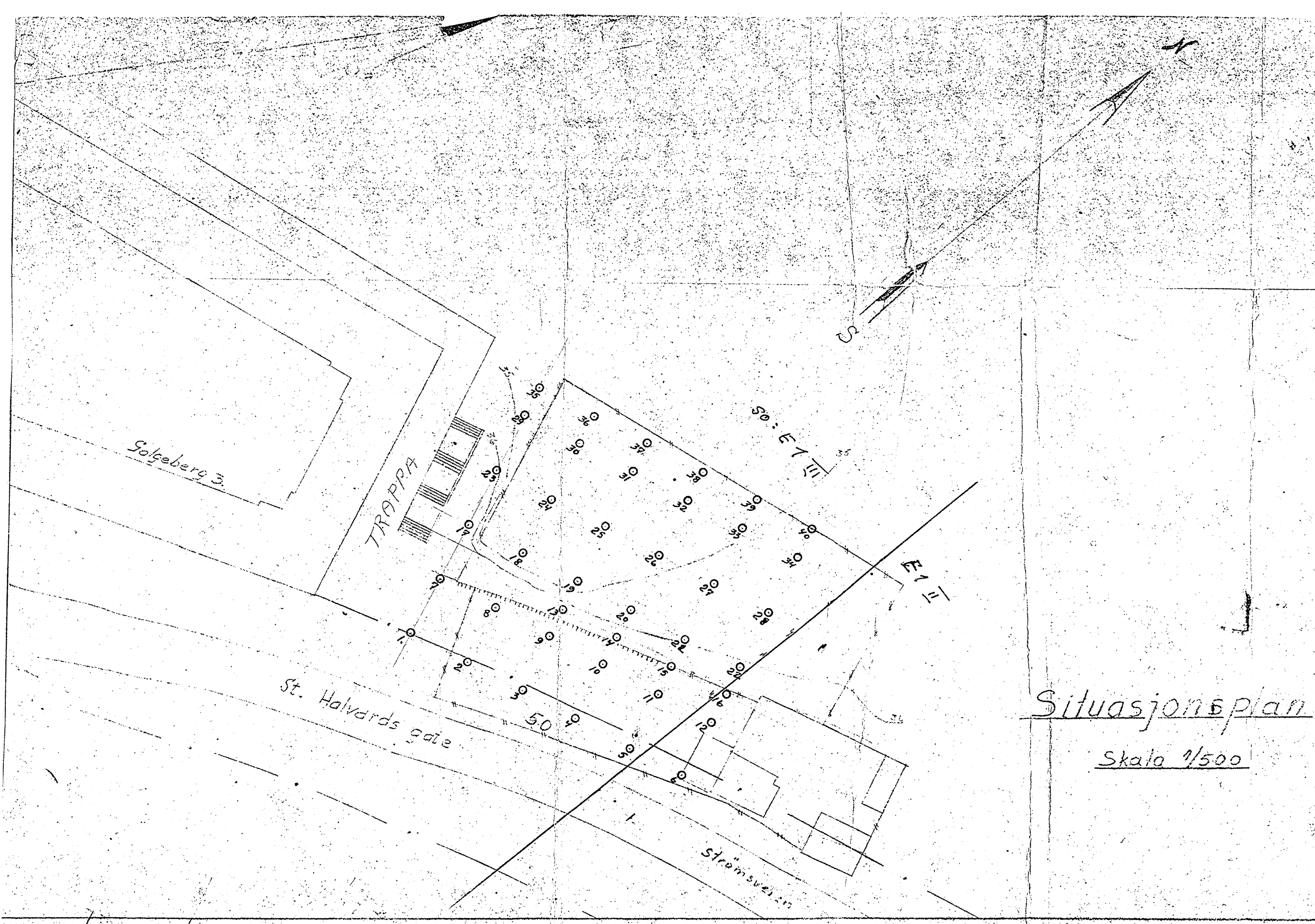

Tilhører Undergrandskartverket  
Med ikke fjernes

SO: E1 II III

- X— = Borhull.
- X = Dybde til fjell.
- Y = Kote sønneve.
- Z = Fjell.
- ⊙ = Provehull.
- V<sub>1</sub> = Vannpøse, av størrelsen.
- H<sub>1</sub> = Bol. bokketeles markering.
- H<sub>2</sub> = ————
- K = Kulemerke.
- O = Eidegrense i skog / fjell.
- G = Organisk landdekk (Marskammer i p. av (særlig)).
- PH = Sørhavsgrud.
- R = Rinnvass.

**St. Halvardsgt. 50A**  
Byarkitekten

INGENIØR-FIRMAET B.L. HAUKEID - OSLO  
GRUNNUNDRSOKELSER

Kr. AUGUST OT. 18. VI. 1912. Nr. 2928. 11

M. 1/200 1/200 1/200