

\*NV: A3<sup>II</sup>

948

Amaldus Nielsens plass

Trafo

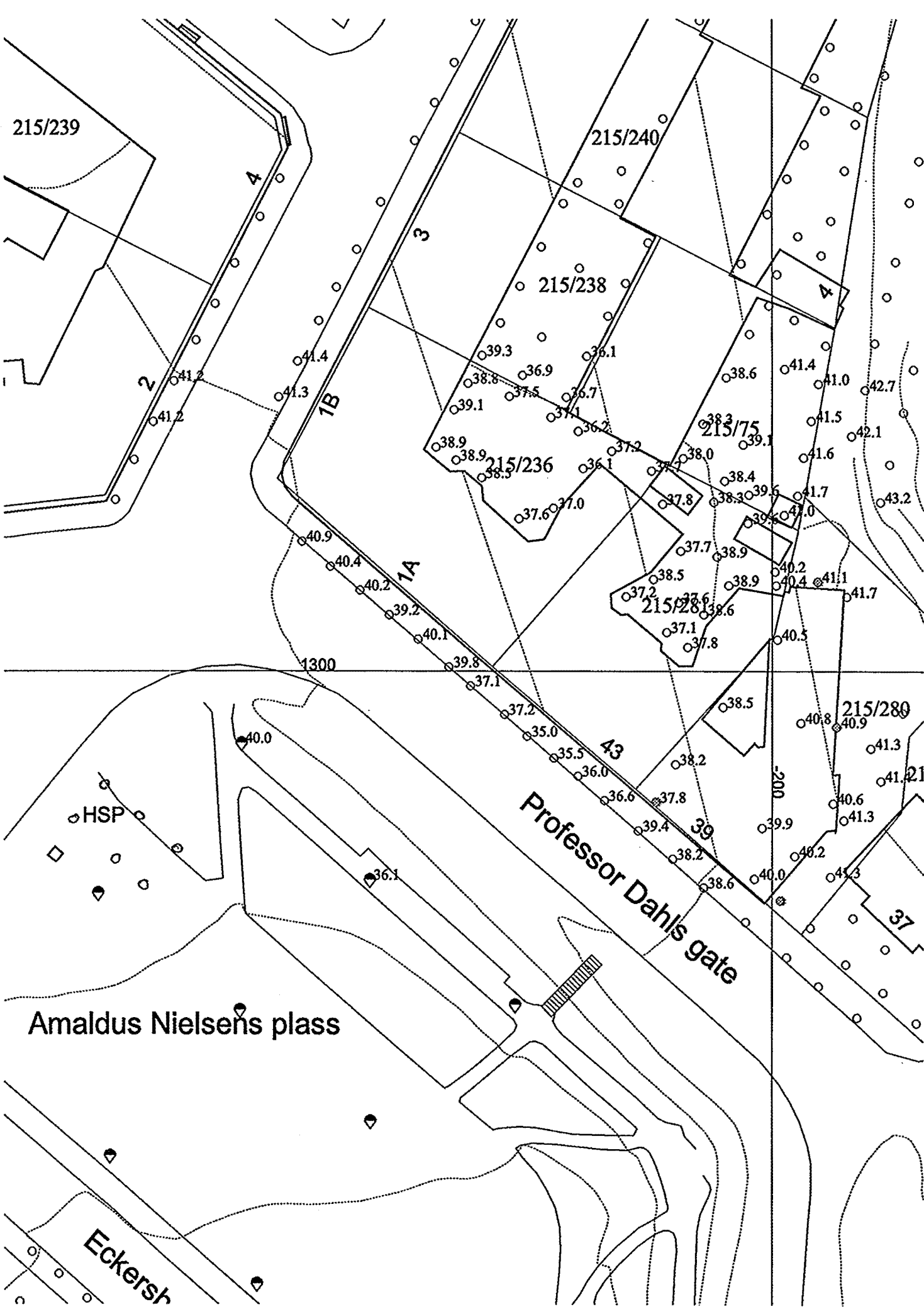

# Boringsplan for Transformatorokiosk (Prof Dahls plass)

M=1:500

Bl. 948

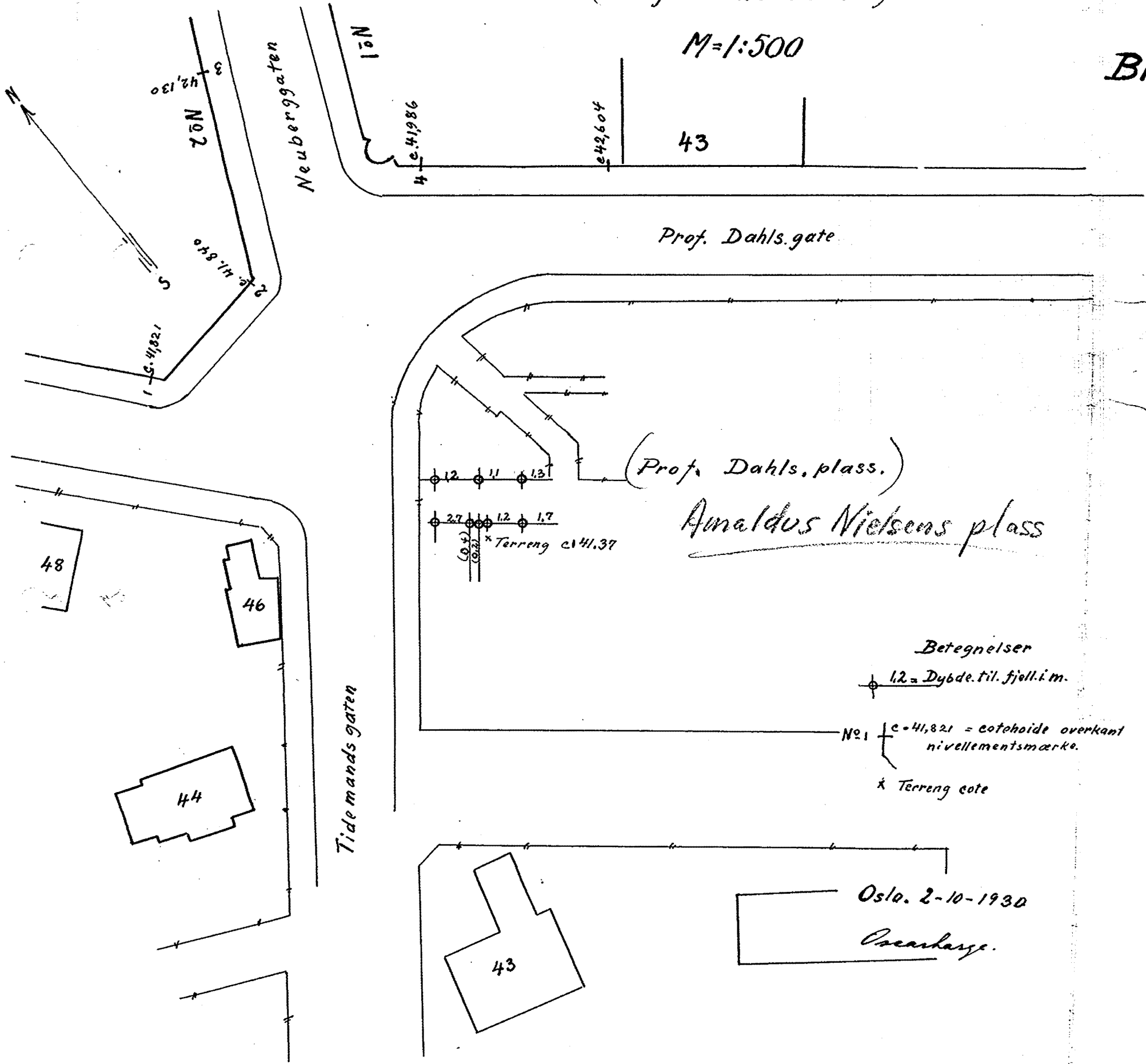

Prof. Dahls gate

(Prof. Dahls plass.)

Arnaldus Nielsens plass

Betegnelser

12 = Dybde til fjell i m.

N<sub>0</sub>1 c=41,821 = cotohoide overkant  
nivellementsmærke.

x Terreng cote

Oslo. 2-10-1930

Oscarhøge.

Neuberggaten

N<sub>0</sub>1

c=41,986

c=42,604

43

N<sub>0</sub>2

c=42,130

c=41,870

c=41,821

48

46

44

43

Tidemandsgaten