

NOD3

210 H

Prøvehull 3 Juli 1939

JORDART	Dyp m	PH
JORDART 29.4		
Fast leire, litt uren	0,25	6,0
" "	0,75	7,0
" " , sandholdig	1,00	7,0
" "	1,50	7,1
" "	2,00	7,5
" "	2,50	7,6
" "	3,00	7,6
Alm. "	3,50	7,6
" "	4,00	7,6
Kvikklattig leire	4,50	7,6

Dybden regnet fra utgravet tomt.

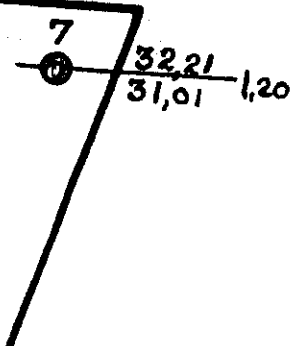

Haukelid tgn. 375

NO: D3 II

1939

Karls