

H A U K E L I D

44/70- 2956

N.R.K. barnehager ?

Suhmsgt. / Gydasvei

NV: A41



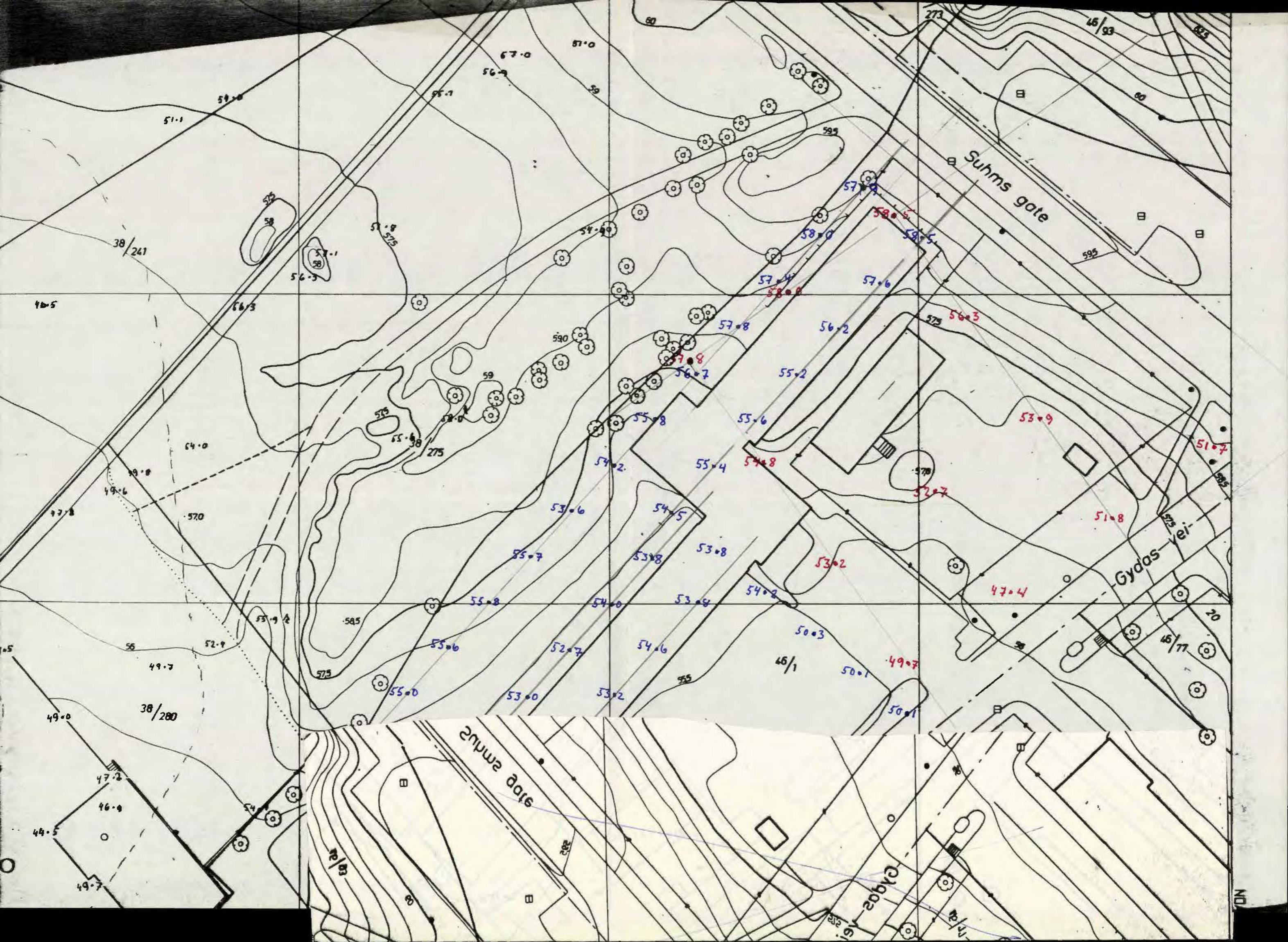

1.90 $\frac{59.79}{57.69}$ P1

0.90 $\frac{59.36}{58.46}$ P 27

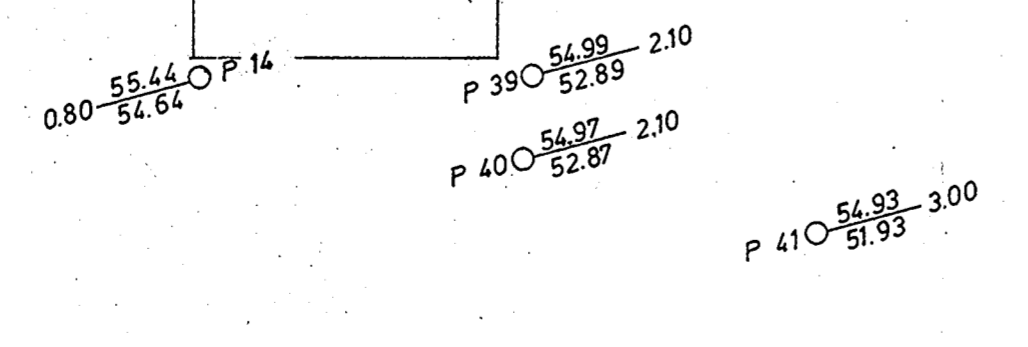
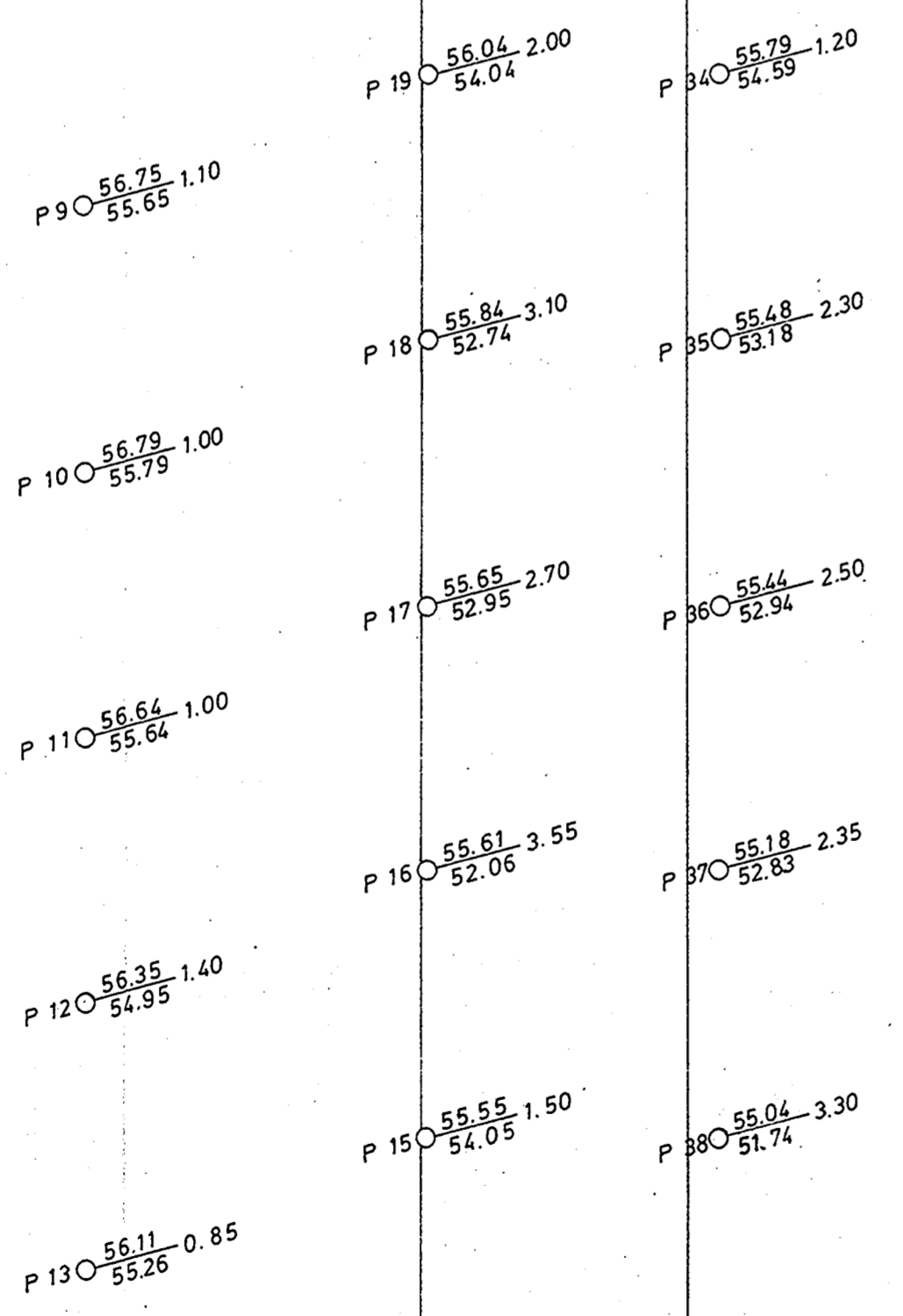
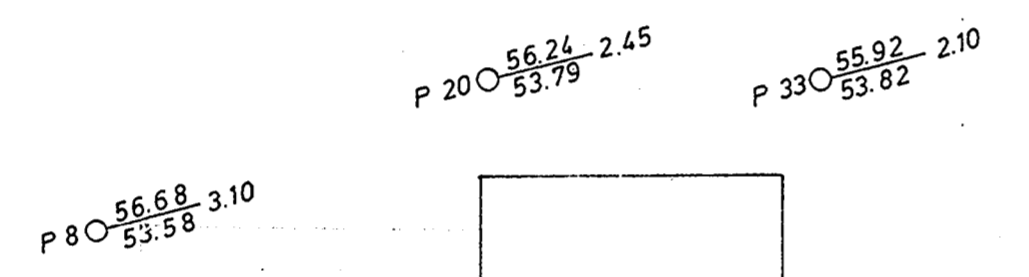
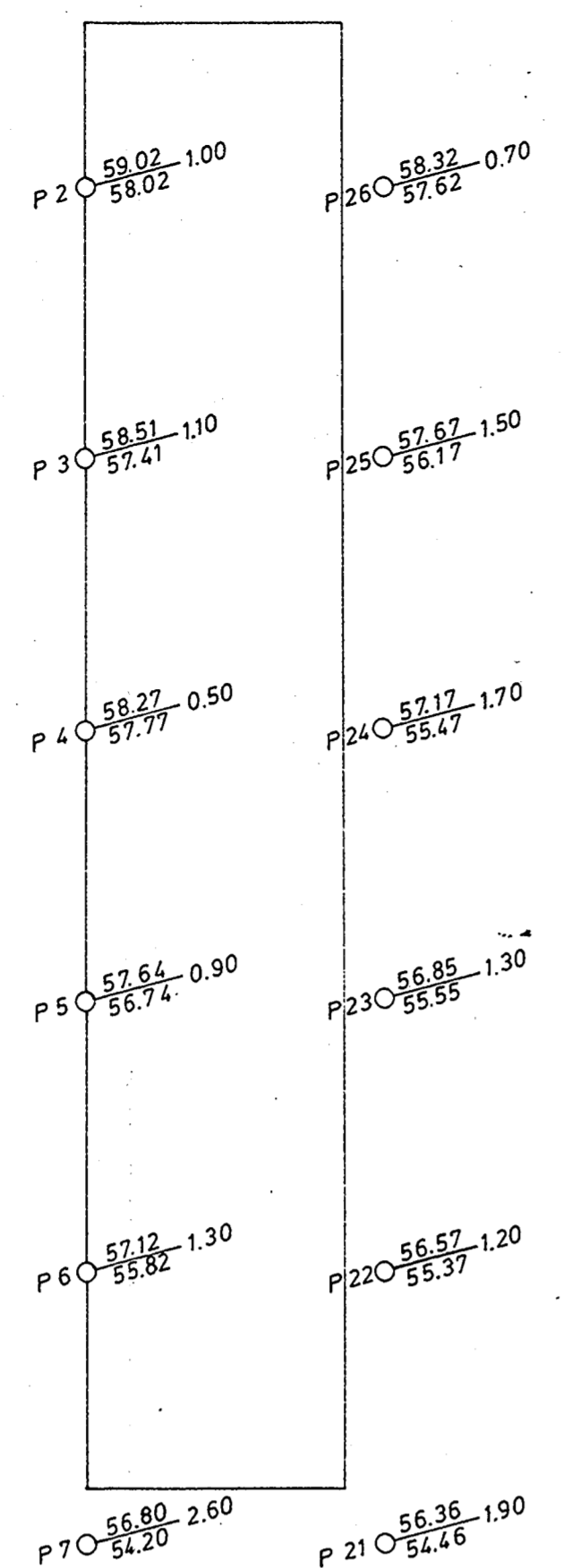

SITUASJONSPLAN 1:1000

SUHMS GATE

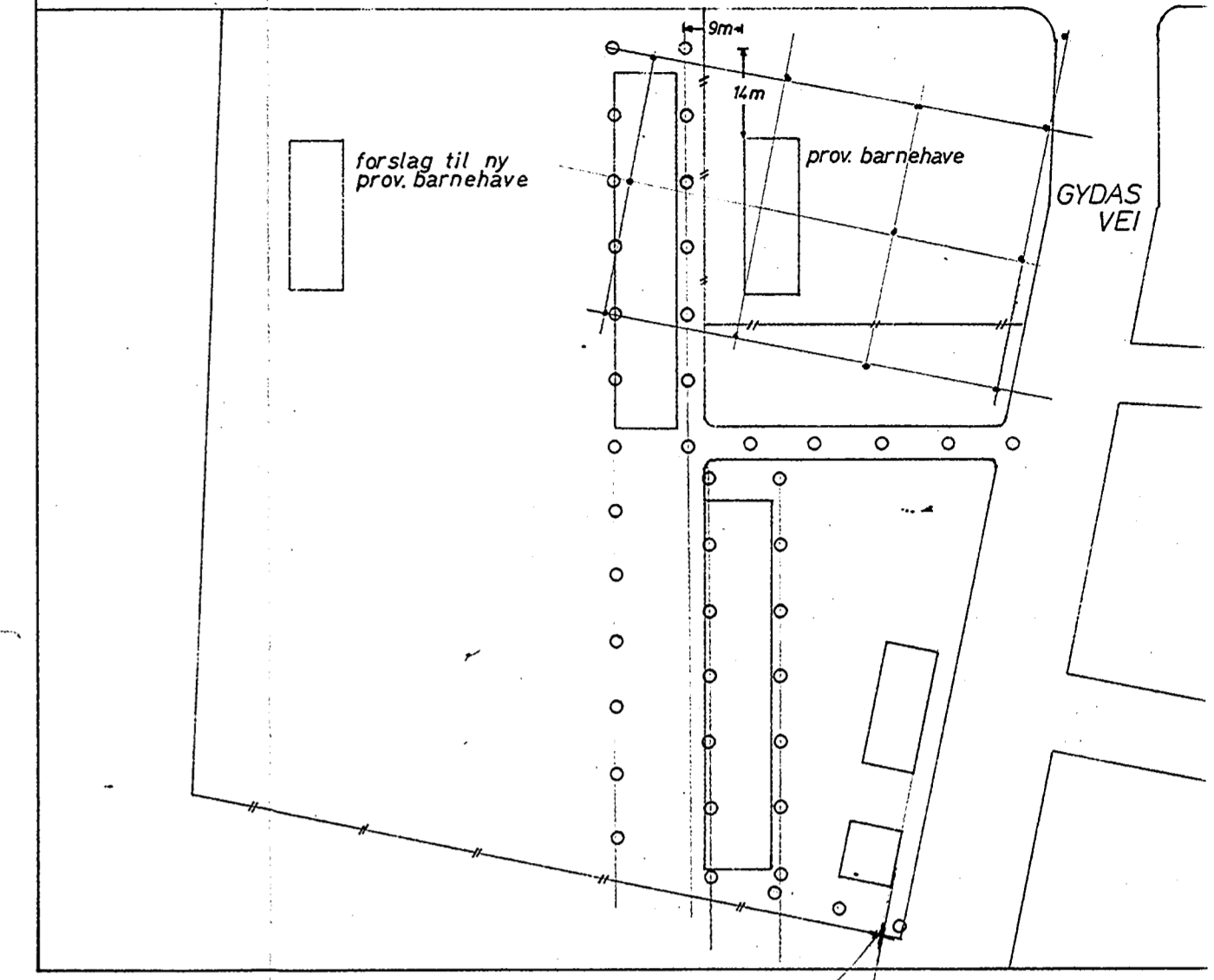

dette punkt er nyttat som utgangspunkt ved overføring til kart 1:500

- $\frac{X}{Z}$ = Borhull.
- X = Dybde til antatt fjell.
- Y = Kote terrang eller sjøbunn
- Z = " antatt fjell.
- [X] = Boring dybde, ikke fjell.
- \odot = Prøvehull, 54 m.m. diam.
- \circ = " - 40 " " "
- \oplus = Vingeboret

Se også Noteby 4052

REV.	INDEX	27. 10. 70	P. F.
N.R.K. (Marienlyst)		DATE	SIGN.
OPPDRAGSGIVER: Barnehuset Suhmsgt.		TEGNET	
BORPLAN	MÅLESTOKK	GODKJENT	
	1:250	R. Sevald	
INGENIØRFIRMA BJØRGULF HAUKELID GRUNNUNDERSØKELSER - OPPMÅLING Telefon 21 30 40 - Sandakerveien 76 - Oslo 4		ERSTATNING FOR: TEGN. NR.: 2956-1 ARB. NR.: 4470	

~~H A U K E L I D~~

~~TGN: ") § & ") § & 2956~~

~~oppdrag 44/70~~

~~N.R.K~~