

* NO: C1^{II}, D1^{III}

1763

Lalkegt 7-7b
Mozfeldtsgt 4
Grønland 12

Gausshavn

LARKEGT. 7 og 7^b MOTZFELDTSGT. 4
GRÖNLAND 12
GRUNDBORINGSKART.
1:200

Bl. 1763

Bredgaten

Lakkegaten

Motzfeldts gt.

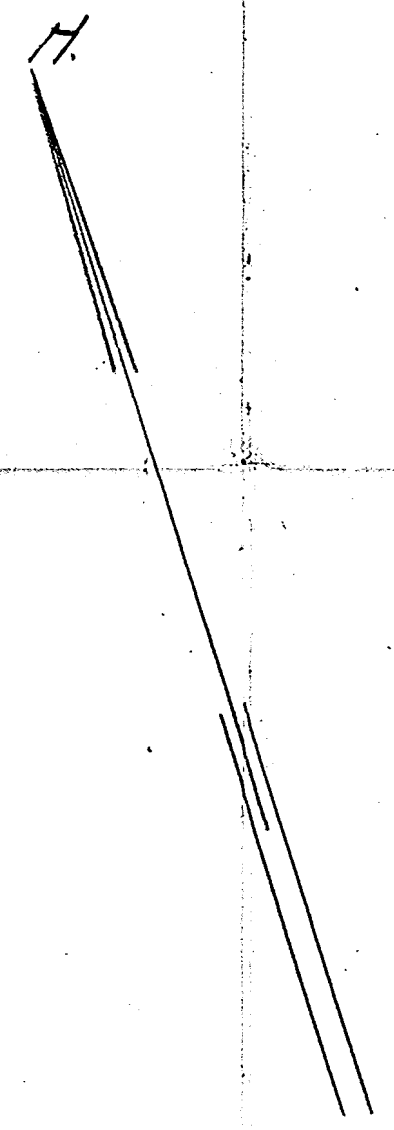
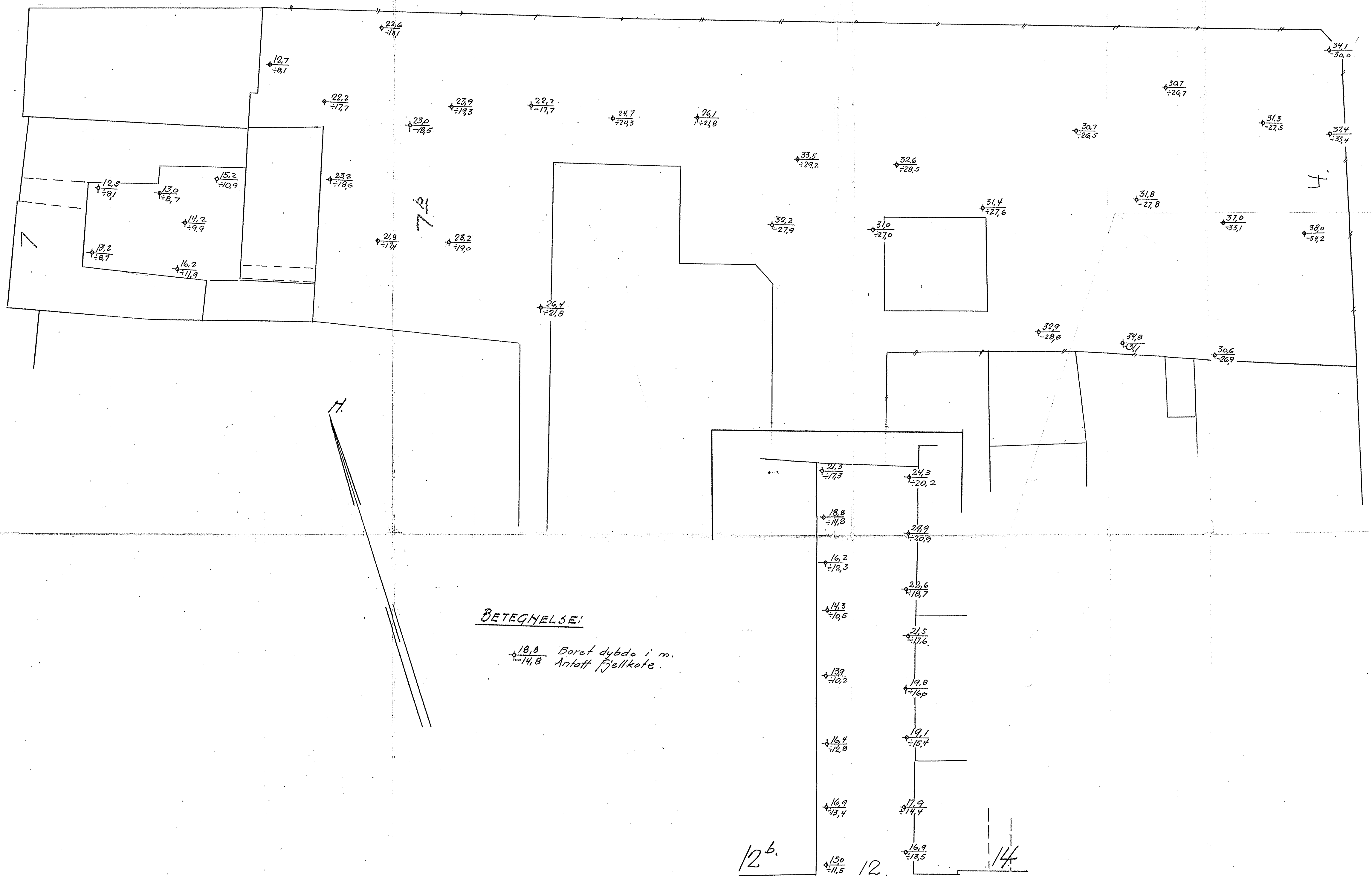

BETEGNELSE:

18,8 Boret dybde i m.
14,8 Antatt fjellkote.

12^b.

12.

14

Grönland.

oob. 19/5-36.

Quinn