

for *Salmons Skofabrik* Side 1



utført mai 1925

Borhul nr. 1			Borhul nr. 3			Borhul nr. 6			Borhul nr. 7			Borhul nr. 8			Borhul nr. 9		
Belastn. 120 kg.			Belastn. 120 kg.			Belastn. 120 kg.			Belastn. 120 kg.			Belastn. 120 kg.			Belastn. 120 kg.		
Planum cote			Planum cote			Planum cote			Planum cote			Planum cote			Planum cote		
Dybde i m.	Ondr.	Grund	Dybde i m.	Ondr.	Grund	Dybde i m.	Ondr.	Grund	Dybde i m.	Ondr.	Grund	Dybde i m.	Ondr.	Grund	Dybde i m.	Ondr.	Grund
1	X	Sten	1	X	Sten	1	X	Sten	1	X	Fylling	1	X	Fylling	1	X	Fylling
2	X	fylling	2	X	fylling	2	X	fylling	2	X	---	2	X	---	2	X	---
3	X	---	3	X	---	3	X	---	3	10	---	3	10	---	3	X	---
4	X	---	4	X	---	4	7	Middels blöt	4	7	Ler	4	32	Stensand	4	12	Middels fast ler
5	14	Fast ler Middels	5	10	Middels	5	6	---	5	14	---	5	11	Middels ler	5	15	---
6	9	fast ler	6	9	fast ler	6	11	grus 0,2 m D = 5,8 m	6	9	---	6	9	---	6	39	Fast ler
7	11	---	7	11	---	7		---	7	10	---	7	8	---	7	33	---
8	8	---	8	12	---	8		---	8	26	Sandholdig	8	21	Fin sand	8	3	Blöt ler
9	12	Middels	9	17	Sandholdig ler	9		---	9	13	ler	9	7	Blöt ler	9	2	---
10	14	fast	10	24	0,2 fin sand	10		---	10	2	8,6 m	10	6	---	10	44	Grusblandet ler
11	15	Sandholdig	11	ant. Fjeld. D = 10,2	---	11		---	11		---	11	5	---	11	68	---
12	13	ler	12		---	12		---	12		---	12	4	---	12	11	0,6 m blöt Fjeld.
13	11	---	13		---	13		---	13		---	13	43	0,32 m sand ant. Fjeld. D = 12,3 m	13	D = 11,6 m	
14	10	---	14		---	14		---	14		---	14		---	14		---
15	12	---	15		---	15		---	15		---	15		---	15		---
16	14	0,4 m fin sand Fjeld.	16		---	16		---	16		---	16		---	16		---
17		---	17		---	17		---	17		---	17		---	17		---
18	D = 16,4 m	---	18		---	18		---	18		---	18		---	18		---
19		---	19		---	19		---	19		---	19		---	19		---
20		---	20		---	20		---	20		---	20		---	20		---
21		---	21		---	21		---	21		---	21		---	21		---
22		---	22		---	22		---	22		---	22		---	22		---
23		---	23		---	23		---	23		---	23		---	23		---
24		---	24		---	24		---	24		---	24		---	24		---

NOC03

Grundboringer ved Salomons Skofabrik

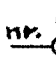
M. 1:200

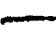
- Betegnelser:
- nr.  Dybde fra terrang til fjeld
Fjeldets k teth ide
 -  Supponerte fjeldkoter
 -  Terrangkoter

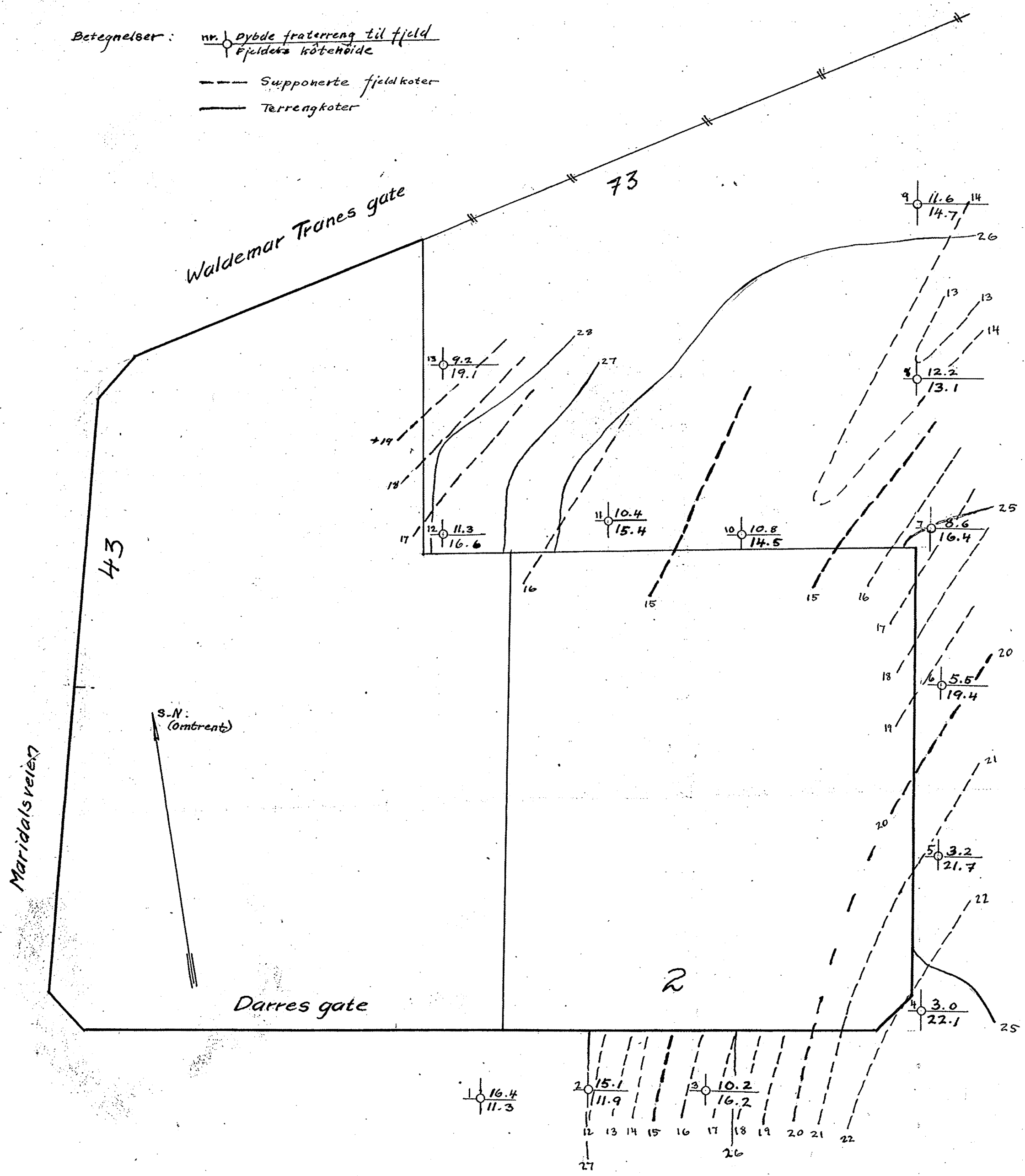

Ostlo i Mai 1925
 Oscar Larsen