

* NO: B1 IV

25-26-27

St. Olavs gt. 31

Grundboringer i nr. 31 St. Olavs Gate.

M. 1:250

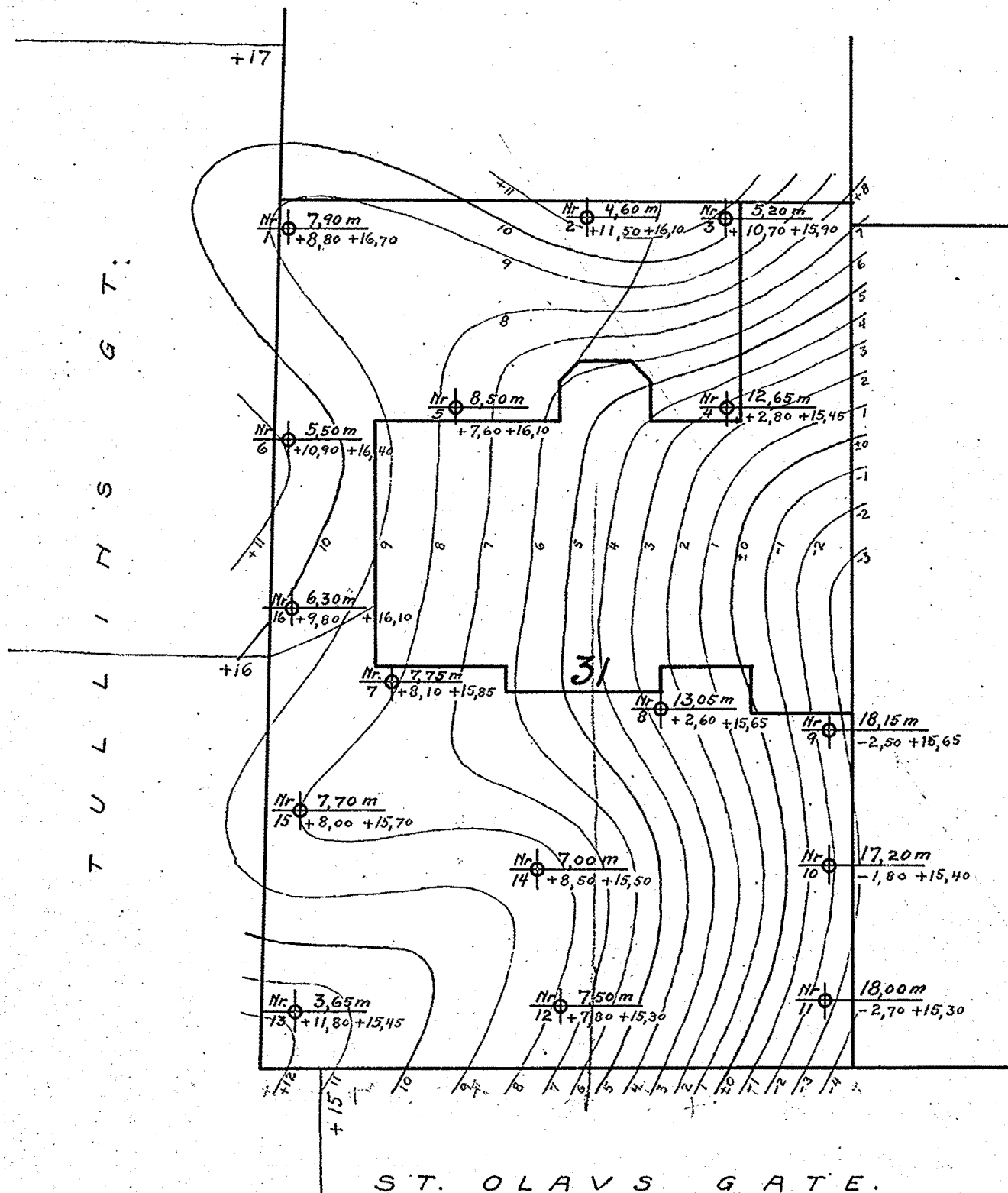

TULLIENSGATE

ST. OLAVS GATE.

Brunt betegner terranhøide i forhold til ±0

Kristiania, mars 1918

Blaat --- fjeldhøide " --- " ±0

Sorte tal over streken angir dybde til fjeld.

[Handwritten signature]

0 5 10 15 20 25 m

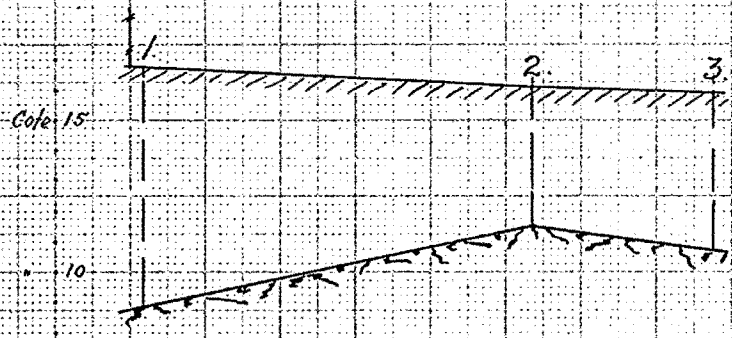

Cote 15 Profil efter borhuller 1-2-3

" 10

Grundboringer for nr. 31 St. Olavs Gate M. 1:250

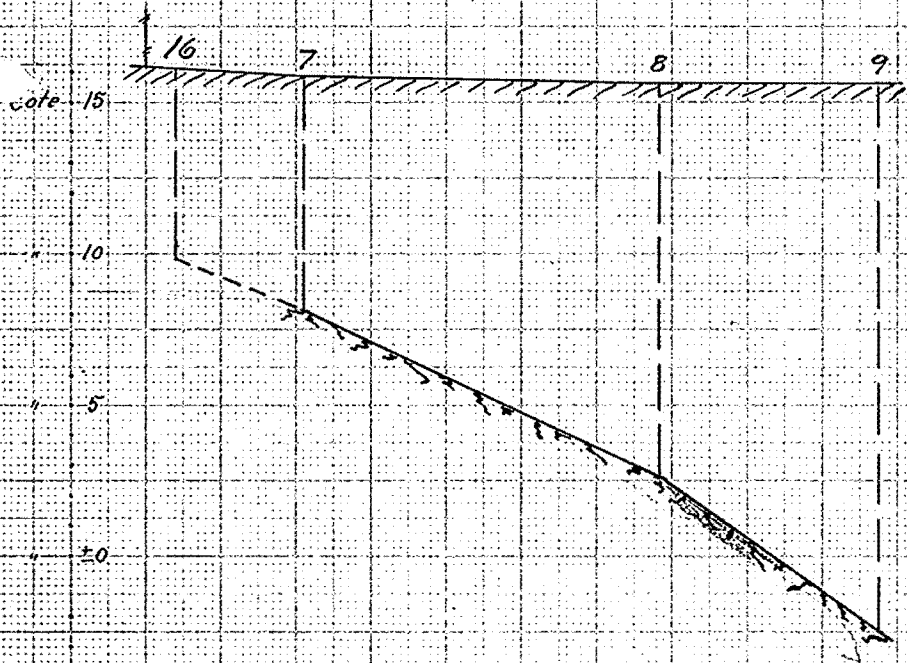

Cote 15

Profil efter borhuller 16-7-8-9

" 10

" 5

" ±0

0 5 10 15 20 25 m

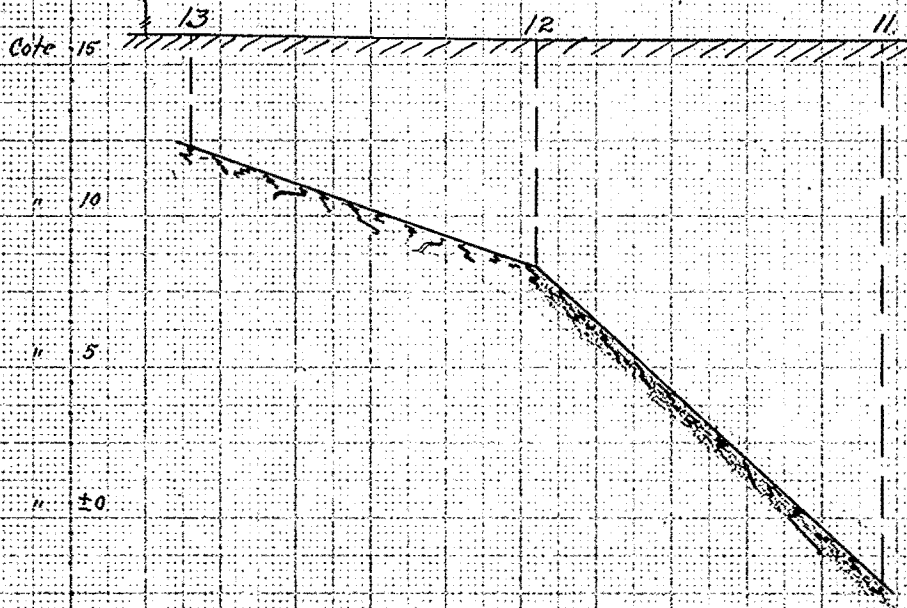

Cote 15

Profil efter borhuller 13-12-11

" 10

" 5

" ±0

Kristiania, mars 1918

[Signature]

Grundboringer i nr. 31 St. Olavs Gate.

Tabel over jordlagenes beskaffenhed.

Hul nr.	m. Fyld.	m. Fast gul (forvit) lere.	m. Fast lere.	m. Blot blaa lere.	m. Blot graa lere.
1	2,00		3,00	2,90	
2	2,00		2,60		
3	2,00		3,20		
4	2,00		3,00	7,65	
5	2,00		3,00	3,50	
6		3,00		2,50	
7	2,00	2,00		3,75	
8	2,00	2,00	1	9,05	
9	2,00		2,00		14,15
10	2,00		2,00	13,20	
11	2,00	2,00		14,00	
12	1,00		3,00	3,50	
13	0,65		3,00		
14	1,00	3,00		3,00	
15	1,00	3,00		3,70	
16	1,00	3,00		2,30	

Kristiania, Mars 1918.

