

NO: B1 III

197

Universitetsgt. 24-26

GRUNDBORINGSSKEMA

Bilag No. 1
Kartbl. No. 197

Borhul No. 1			Borhul No. 2			Borhul No. 3			Belastning 120 kg.	Bor:
Datum jan. 1923			Datum jan. 1923.			Datum jan. 1923.				
Gate Universitetsg. No. 26			Gate Universitetsg. No. 26			Gate Universitetsg. No. 26				
Planum cote 8,4			Planum cote 18,35			Planum cote 7,90				
Dybde meter	Grund		Dybde meter	Grund		Dybde meter	Grund			
1	x	Fjelling	1	x	Fjelling	1	x	Fjelling	Borhul no. 3 fots. 23 49 24 45 25 44 26 47 27 76 [26,4-26,8 m. sand 28 54 sandbl. ler 29 43 fast græs 28,5 m. Fjeld. 30 31 32 33 34 35 36 37 38 39 40 41 42 43 44 45 46 47 48 49 50 51 52 53 54 55 56 57 58 59 60 61 62 63 64 65 66 67 68 69 70 71 72 73 74 75 76 77 78 79 80 81 82 83 84 85 86 87 88 89 90 91 92 93 94 95 96 97 98 99 100	
2	x	---	2	x	Lere	2	x	---		
3	x	---	3	7	---	3	x	---		
4	9	Lere	4	2	---	4	6	Lere		
5	5	---	5	1	---	5	5	---		
6	5	---	6	5	---	6	9	---		
7	4	---	7	8	---	7	8	---		
8	5	---	8	9	---	8	12	---		
9	7	---	9	11	---	9	17	---		
10	6	---	10	14	---	10	15	---		
11	9	---	11	16	---	11	19	---		
12	4	---	12	14	---	12	21	---		
13	14	---	13	18	---	13	21	---		
14	13	---	14	21	---	14	24	---		
15	15	---	15	22	---	15	28	---		
16	22	15,4-15,7 m. sand	16	25	---	16	32	---		
17	16	Lere	17	29	---	17	31	---		
18		9,10 m. sand paa fjeld	18	30	---	18	34	---		
19		17,2 m. Fjeld	19	33	---	19	36	---		
20			20	31	---	20	36	---		
21			21	29	---	21	35	---		
22			22	32	---	22	41	---		
			23	43	0,20 m. sand paa fjeld					
					23,7 m. Fjeld					

Boringsrør 4 x 4 cm.

GRUNDBORINGER FOR NR. 26 UNIVERSITETSGATEN.

M. 1:500.

Belegner: \oplus 15,4 Dybde fra terreng til fjeld
 \oplus 12,1 Fjeldets kotehoide

Høiderne refererer sig til byens f.m.

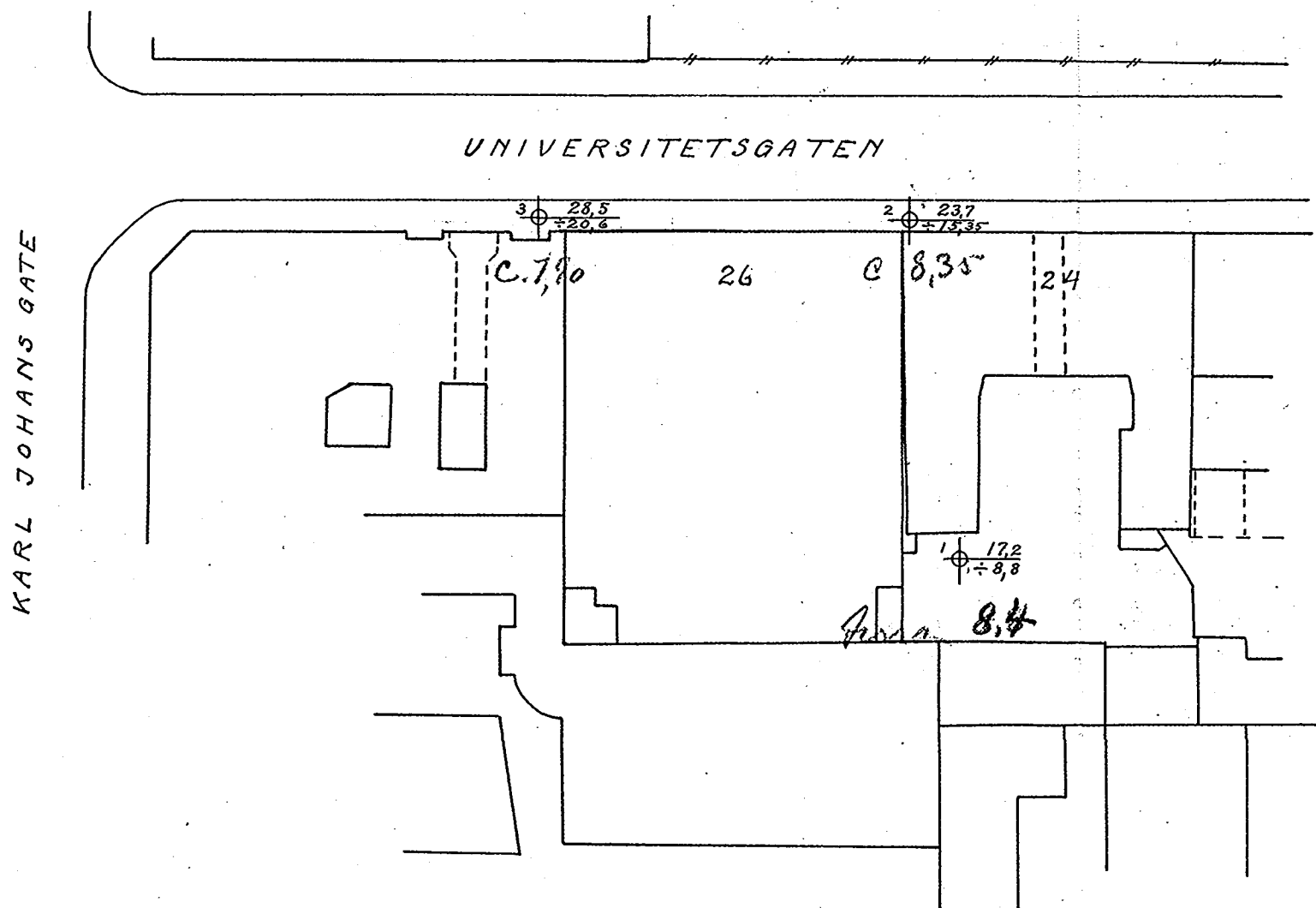

Kristiania, februar 1923.

Oscarhøye