

NV, B-8 II

*overf. Juni 92*



H A U ~~B~~ E L I D

32/71

Heyerdahls vei (3/5)

NV. B8. II

19.10.1971

Tilhører Undergrunnskartverket  
Malthe Strøm

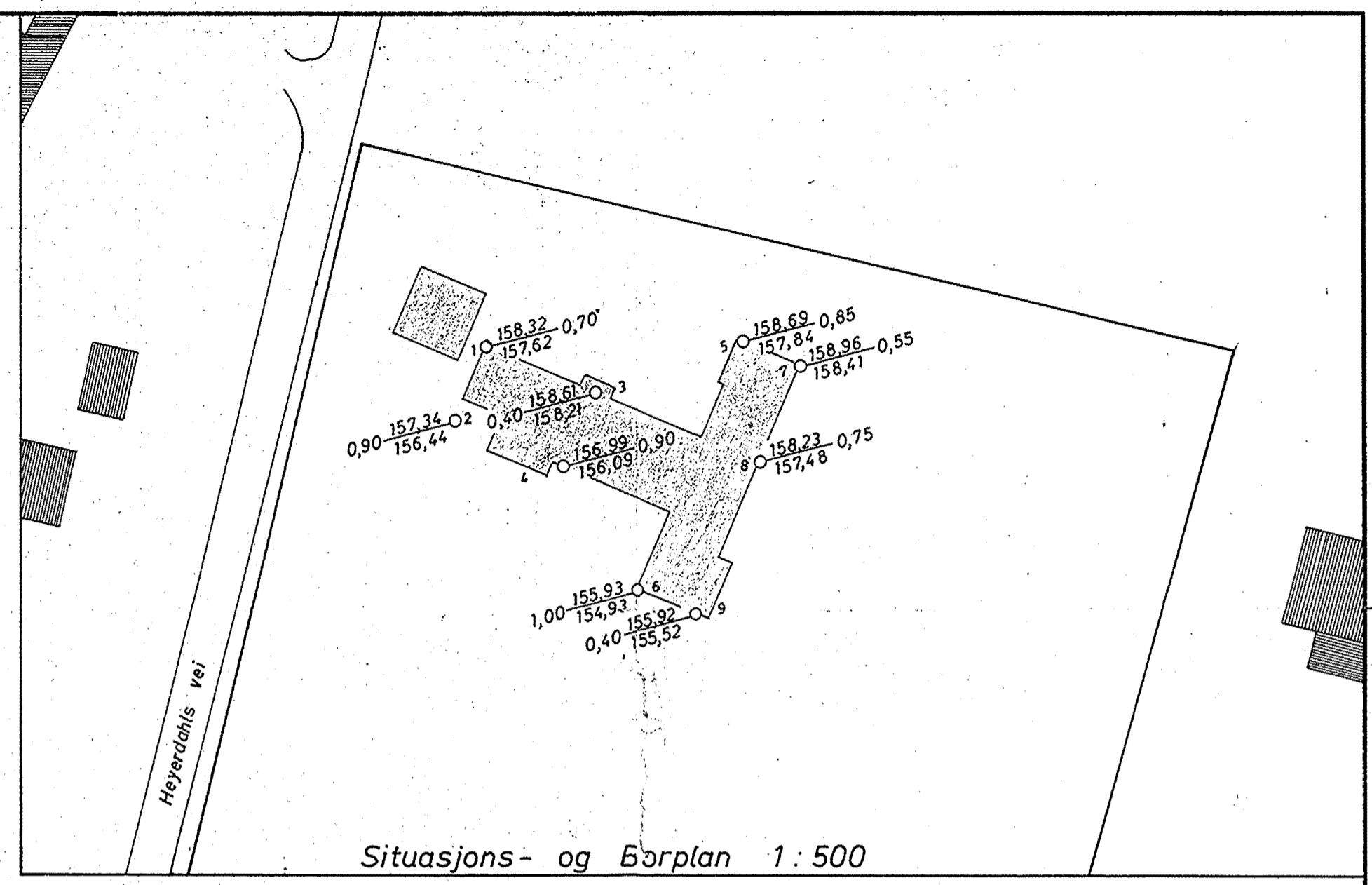
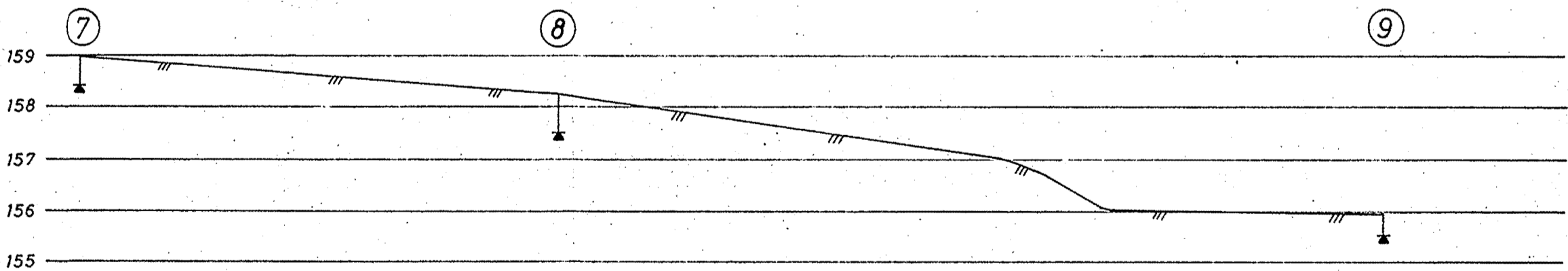
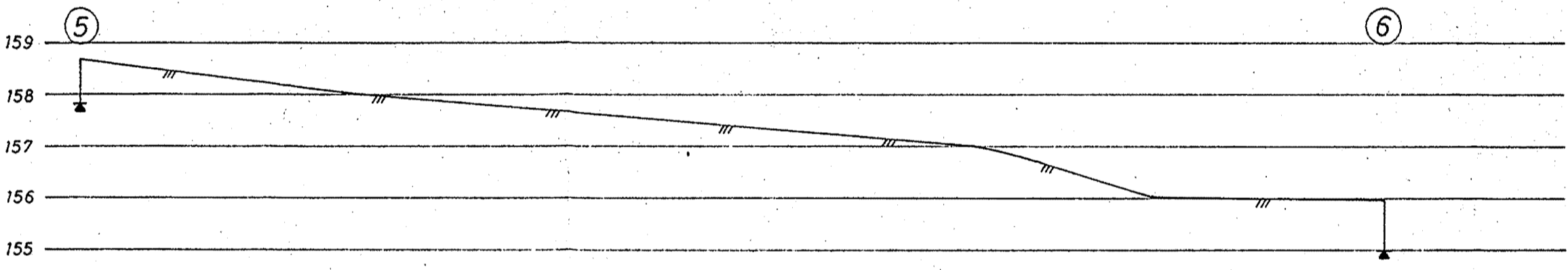
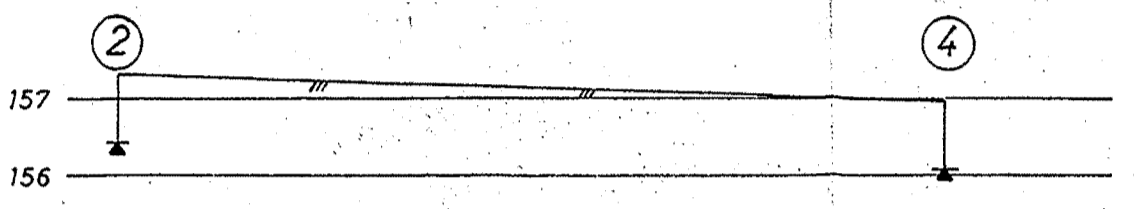
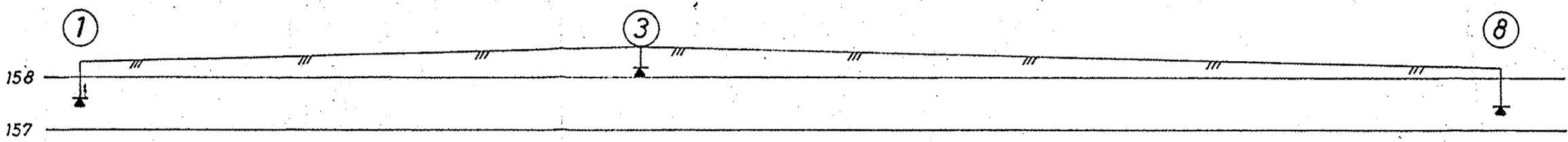

- X = Borhull.
- X = Dybde til ansett fjell.
- Y = Kote terreng eller sløbunn.
- Z = Kote ansett fjell.
- [X] = Boring tybde, ikke fjell.
- = Prøvehull, 54 m.m. diam.
- = " " 40 " " "
- = Vingeboret

REV.	INDEKS		
Heyerdahls vei (3)-5		19. 10. 71	P.F.
OPPDRAAGSGIVER: NV. 138. II		DATE	SIGN.
Borprofiler		TEGNET	GODKJENT
MÅLESTOKK		GODKJENT	
1:100		P. Sevaldson	
INGENIØRFIRMA HAUKELID AS		ERSTATNING FOR:	
GRUNNUNDERSØKELSER - OPPMÅLING		TEGN. NR.: 2993-1	
Telefon 21 30 40 - Sandakerveien 76 - Oslo 4		ARB. NR.: 32/71	