

\* SO. B1<sup>II</sup>

811

Dronningsøyt. 18

Skipperøyt 17<sup>b</sup>

# Grunnboringsskart for Dronningens gate 18 og Skippergaten 17b

M. 1:200

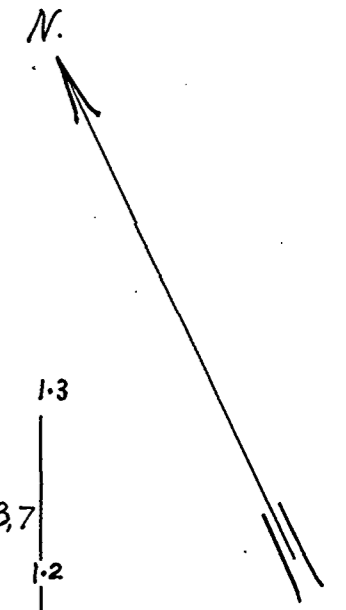
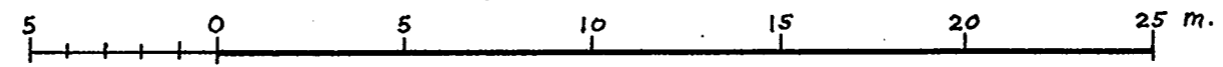

Forklaring: 0.7 (les 0.7) fjellets kotehøide. Punktet er målested  
 - - - - - approximative fjellkoter l.m. ækr.  
 T. + 4,9 terrengets kotehøide  
 Høiderne er referent til byens høidefastmrk.

D R O N N I N G E N S   G A T E

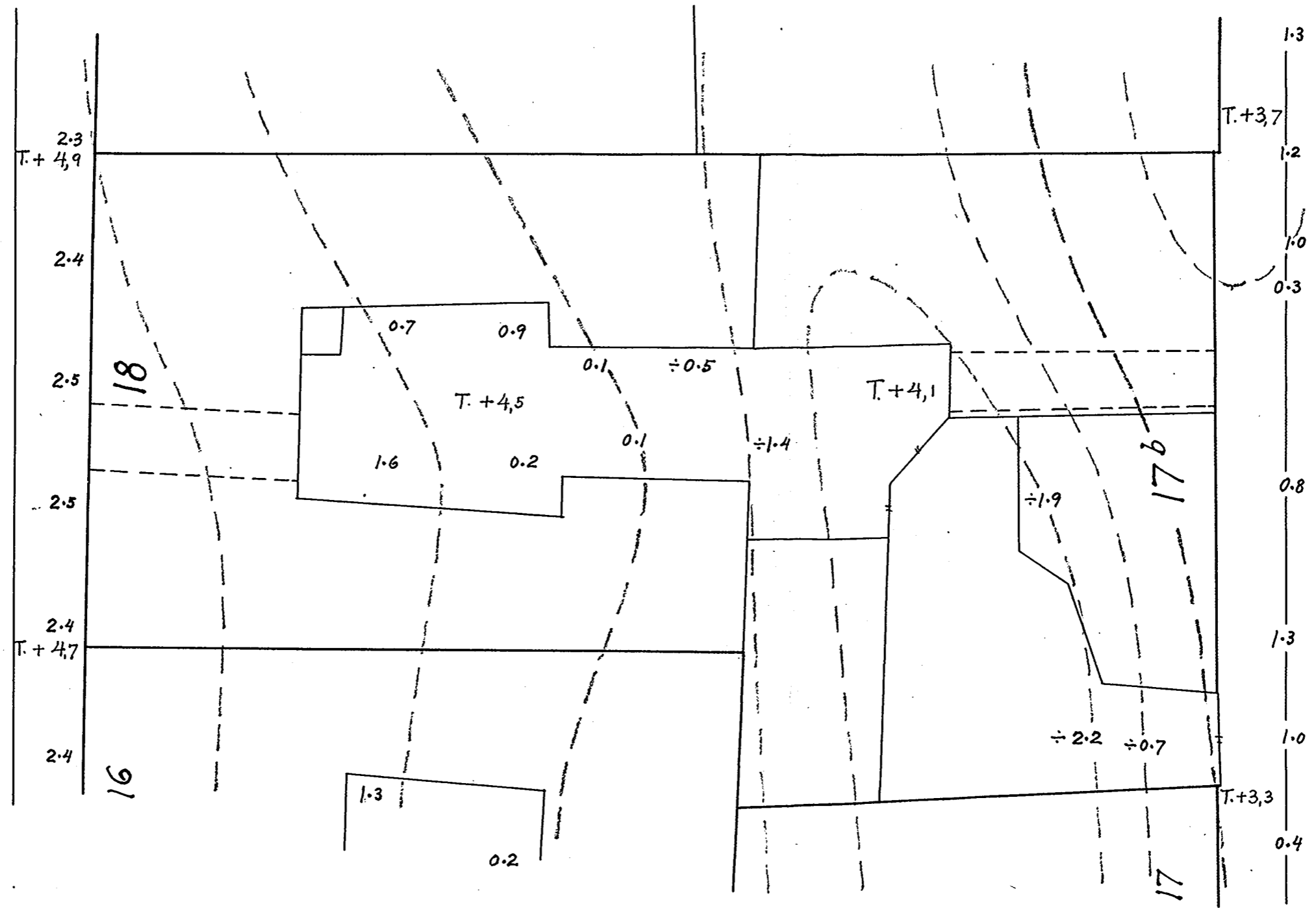

S K I P P E R G A T E N

Oslø, 19-9-1929  
 Ingeniør Oscar Large  
*[Signature]*