

\* NO: B2 IV

1217-1220

Stensberggt. 25

## STENSBERGGATEN 25

Bestemmelse av lerens vanninnhold og holdfasthet.

Serie 935.

Dybde.	4,10 <sup>m</sup>	4,40 <sup>m</sup>	4,70 <sup>m</sup>	5,20 <sup>m</sup>	5,75 <sup>m</sup>
Glass	157	180	170	130	149
Lodd nr.	2 3 3	2 3	2 3	2 3	2 3
Inntrykk	4 85 79	39 90	35 84	38 89	49 108
Holdfasthet H <sub>3</sub>	575 66 78	605 575	76 68	64 59	38 38
Lodd nr.	2	2	2	2	2
Inntrykk	45	46	40	44	47
Holdfasthet H <sub>1</sub>	46,0	44,0	57,5	48,0	42,0
Total våt	16,997	14,215	15,037	15,218	14,074
Tara	12,373	11,613	12,970	11,691	11,779
Netto våt	4,624	2,602	2,067	3,527	2,295
Total tørr	16,020	13,670	14,602	14,455	13,540
Tara	12,373	11,613	12,970	11,691	11,779
Netto tørr	3,647	2,057	1,632	2,764	1,761
Netto våt	4,624	2,602	2,067	3,527	2,295
Vann	0,977	0,545	0,435	0,763	0,534
D <sub>9</sub> =					
% av lerens	21,1%	21,0%	21,0%	21,6%	23,3%

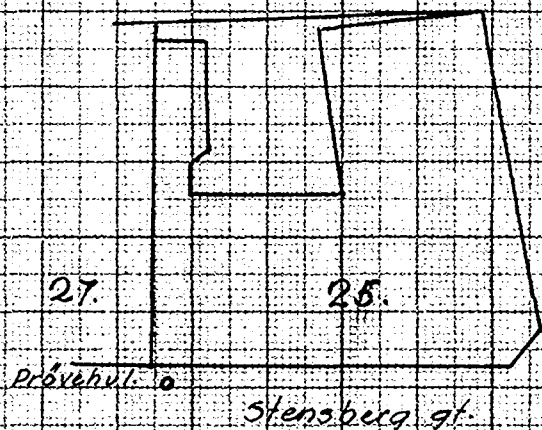
Oslo 14-11-32  
Oscar Lange B.

STEMSBERGGATEN 25.

Grafisk fremstilling av lerens vanninnhold og holdfasthet.  
(cfr. bl. 1219. - Serie 935.)

30% 20% 10% 0%

0 20 40 60<sup>25</sup>

Vekts % vann.

Holdfasthetstall  $H_1$  og  $H_3$ .

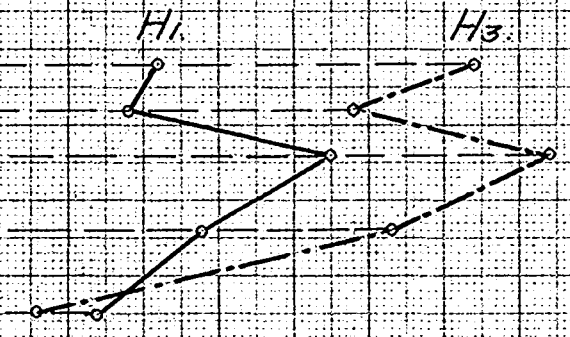
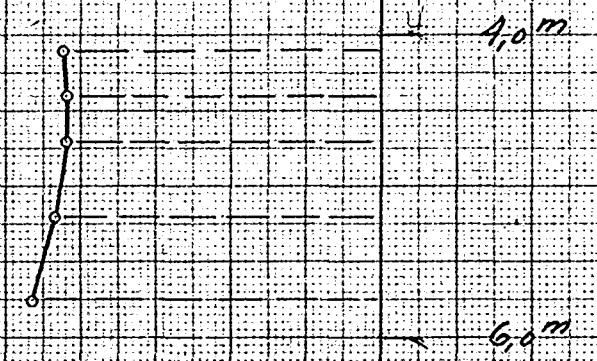

Oslo 14-11-1932.  
Oscar Kjørup  
B. I.