

Prövehull I

Jordart.	Dyp	Vannpst. av total m. subst.	törr subst.	H ₃	H ₁	F	K	O	G	pH	δ
Stolpeleire.	2	22.8	29.5	970			9.4			5.5	1.97
Leire	3	24.6	32.8	435	90	50	6.7			6.8	1.90
— " — ensartet.	4	25.9	35.0	207	36	44	4.3			7.1	1.87
— " —	5	22.5	29.1	156	40	35	3.8				1.92
— " —	6	24.7	32.8	207	45	44	4.3			7.4	1.90
— " —	7	25.0	33.5	132	19	37	3.1				1.88
— " —	8	25.1	33.6	87	11	34	2.2			7.6	1.92

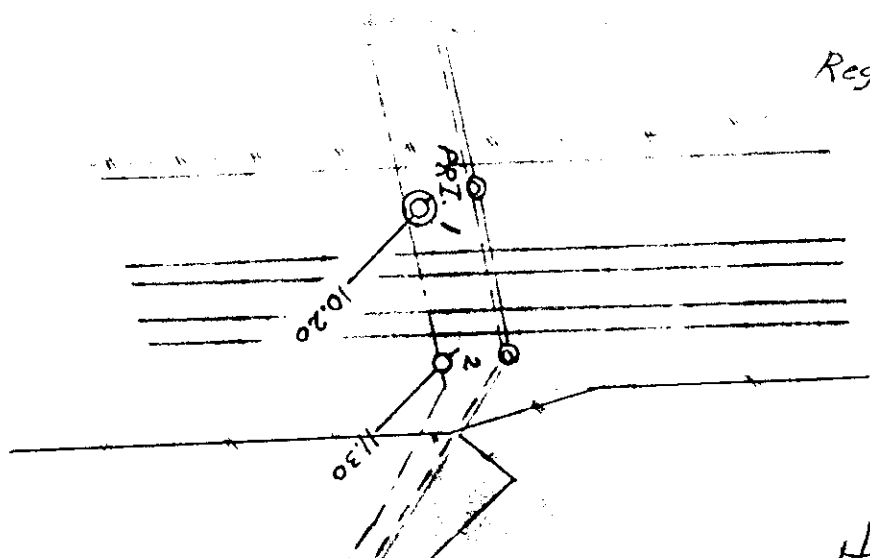

Reg. Östensjöbanen.

Hovedbanen.

(1950)

Hankelid 40/50